

Soils Map

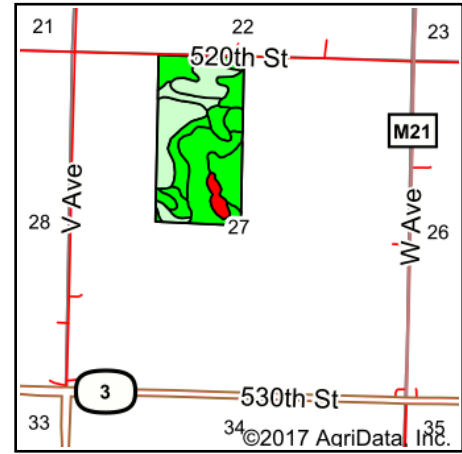
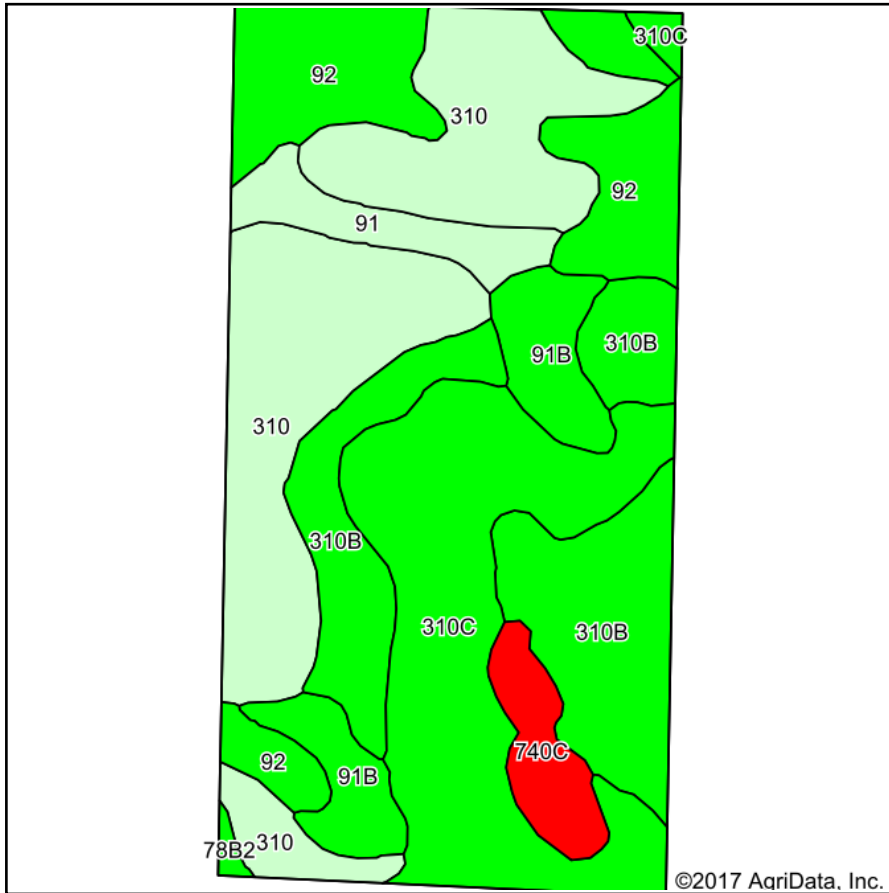

State: **Iowa**
 County: **Cherokee**
 Location: **27-92N-39W**
 Township: **Afton**
 Acres: **79.72**
 Date: **9/25/2017**

& REAL ESTATE, INC
MIDWEST LAND
 712-262-3110 MANAGEMENT

Maps Provided By:

 CUSTOMIZED ONLINE MAPPING
 © AgriData, Inc. 2017 www.AgriDataInc.com



Area Symbol: IA035, Soil Area Version: 25

Code	Soil Description	Acres	Percent of field	CSR2 Legend	Non-Irr Class *c	CSR2**	CSR
310	Galva silty clay loam, 0 to 2 percent slopes	22.66	28.4%		I	100	76
310C	Galva silty clay loam, 5 to 9 percent slopes	17.87	22.4%		IIIe	87	56
310B	Galva silty clay loam, 2 to 5 percent slopes	16.90	21.2%		Ile	95	71
92	Marcus silty clay loam, 0 to 2 percent slopes	10.51	13.2%		IIw	94	76
91B	Primghar silty clay loam, 1 to 4 percent slopes	5.56	7.0%		Ile	94	79
91	Primghar silty clay loam, 0 to 2 percent slopes	3.13	3.9%		Iw	100	81
740C	Hawick sandy loam, 2 to 9 percent slopes	2.84	3.6%		IVs	21	5
78B2	Sac silty clay loam, 2 to 5 percent slopes, eroded	0.25	0.3%		Ile	86	65
Weighted Average						92	68.3

**IA has updated the CSR values for each county to CSR2.

*c: Using Capabilities Class Dominant Condition Aggregation Method

Soils data provided by USDA and NRCS.