

Soils Map

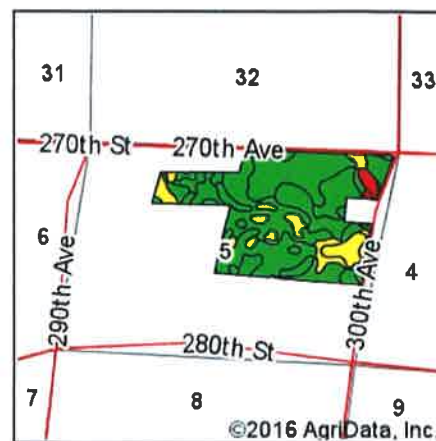
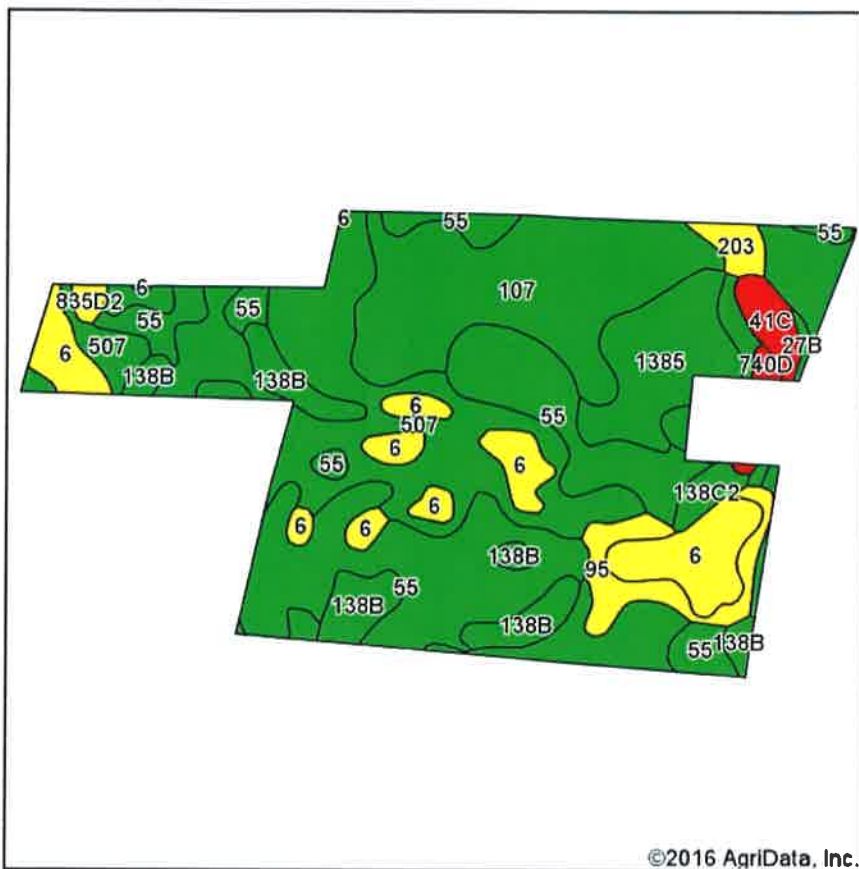

State: Iowa
 County: Clay
 Location: 5-97N-35W
 Township: Lake
 Acres: 136.91
 Date: 4/27/2016

& REAL ESTATE, INC
MIDWEST LAND
 712-292-3110 MANAGEMENT

Maps Provided By:

 CUSTOMIZED ONLINE MAPPING
 © AgriData, Inc. 2016 www.AgridataInc.com



Soils data provided by USDA and NRCS.

Area Symbol: IA041, Soil Area Version: 24

Code	Soil Description	Acres	Percent of field	CSR2 Legend	Non-Irr Class *c	CSR2**	CSR
507	Canisteo clay loam, 0 to 2 percent slopes	35.63	26.0%		IIw	84	73
55	Nicollet clay loam, 1 to 3 percent slopes	34.01	24.8%		Iw	89	82
107	Webster clay loam, 0 to 2 percent slopes	22.83	16.7%		IIw	86	77
6	Okoboji silty clay loam, 0 to 1 percent slopes	13.29	9.7%		IIIw	59	55
138B	Clarion loam, 2 to 6 percent slopes	10.32	7.5%		Ile	89	74
1385	Ocheda silty clay loam, 1 to 3 percent slopes	9.15	6.7%		IIw	76	73
95	Harps clay loam, 0 to 2 percent slopes	4.90	3.6%		IIw	72	57
41C	Sparta loamy sand, 5 to 9 percent slopes	2.27	1.7%		VI s	35	5
203	Cylinder loam, 32 to 40 inches to sand and gravel, 0 to 2 percent slopes	1.51	1.1%		II s	59	71
138C2	Clarion loam, 6 to 10 percent slopes, moderately eroded	1.45	1.1%		IIIe	83	59
835D2	Storden-Omsrud complex, 9 to 14 percent slopes, moderately eroded	0.62	0.5%		IIIe	43	46
27B	Terril loam, 2 to 6 percent slopes	0.50	0.4%		Ile	87	75
740D	Hawick gravelly loamy sand, 9 to 14 percent slopes	0.43	0.3%		IV s	6	5
Weighted Average						81	72

Area Symbol: IA041, Soil Area Version: 24

**IA has updated the CSR values for each county to CSR2.

*c: Using Capabilities Class Dominant Condition Aggregation Method

Soils data provided by USDA and NRCS.