

Soils Map

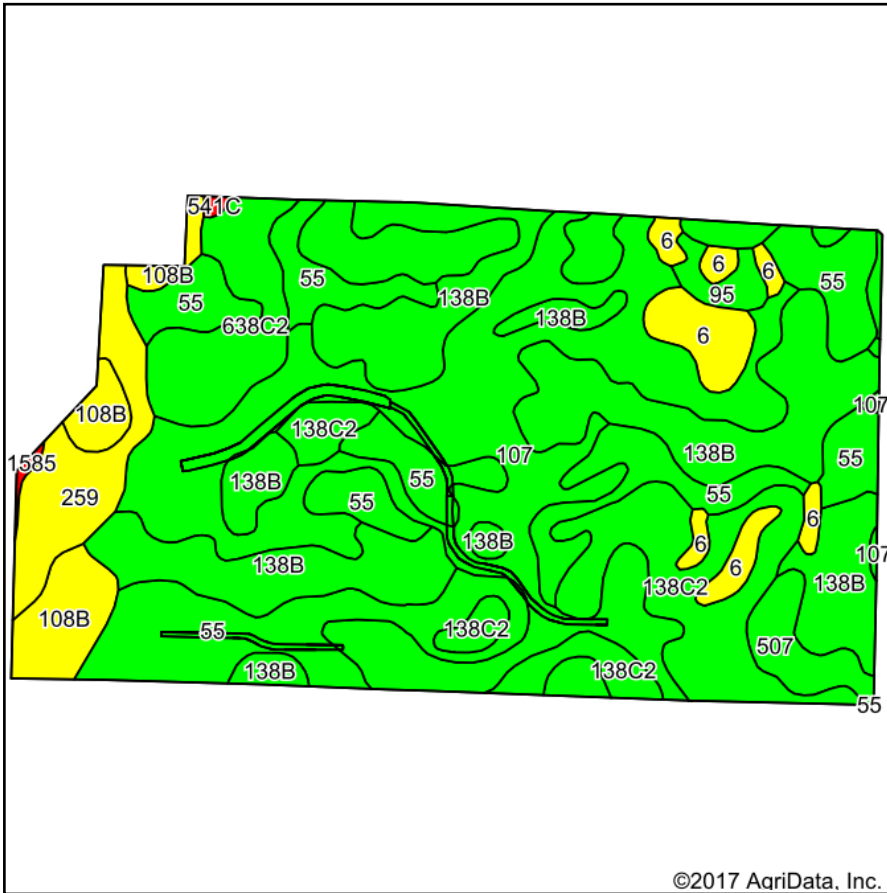

Soils data provided by USDA and NRCS.

©2017 AgriData, Inc.

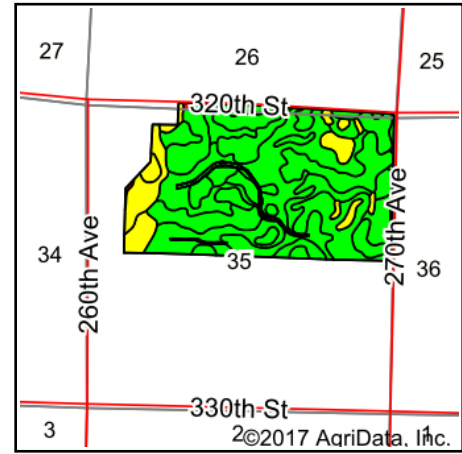

State: **Iowa**
 County: **Clay**
 Location: **35-97N-36W**
 Township: **Meadow**
 Acres: **260.14**
 Date: **10/5/2017**

REAL ESTATE, INC
MIDWEST LAND
 712-262-3110 MANAGEMENT

Maps Provided By:

 CUSTOMIZED ONLINE MAPPING
 © AgriData, Inc. 2017 www.AgriDataInc.com



Area Symbol: IA041, Soil Area Version: 26

Code	Soil Description	Acres	Percent of field	CSR2 Legend	Non-Irr Class *c	CSR2**	CSR
138B	Clarion loam, 2 to 6 percent slopes	63.07	24.2%		Ile	89	74
107	Webster clay loam, 0 to 2 percent slopes	61.78	23.7%		IIw	86	77
55	Nicollet clay loam, 1 to 3 percent slopes	50.70	19.5%		Iw	89	82
138C2	Clarion loam, 6 to 10 percent slopes, moderately eroded	25.74	9.9%		IIIe	83	59
638C2	Clarion-Storden complex, 6 to 10 percent slopes, moderately eroded	19.19	7.4%		IIIe	75	55
259	Biscay clay loam, 0 to 2 percent slopes	11.18	4.3%		IIw	52	70
108B	Wadena loam, 2 to 6 percent slopes	10.28	4.0%		Ile	52	47
6	Okoboji silty clay loam, 0 to 1 percent slopes	10.06	3.9%		IIIw	59	55
507	Canisteo clay loam, 0 to 2 percent slopes	5.00	1.9%		IIw	84	73
95	Harps clay loam, 0 to 2 percent slopes	2.50	1.0%		IIw	72	57
1585	Spillville-Coland complex, channeled, 0 to 2 percent slopes, frequently flooded	0.37	0.1%		Vw	37	25
541C	Estherville-Hawick complex, 5 to 9 percent slopes	0.27	0.1%		IIIs	24	5
Weighted Average						82	71.1

**IA has updated the CSR values for each county to CSR2.

*c: Using Capabilities Class Dominant Condition Aggregation Method

Soils data provided by USDA and NRCS.