

# Soils Map

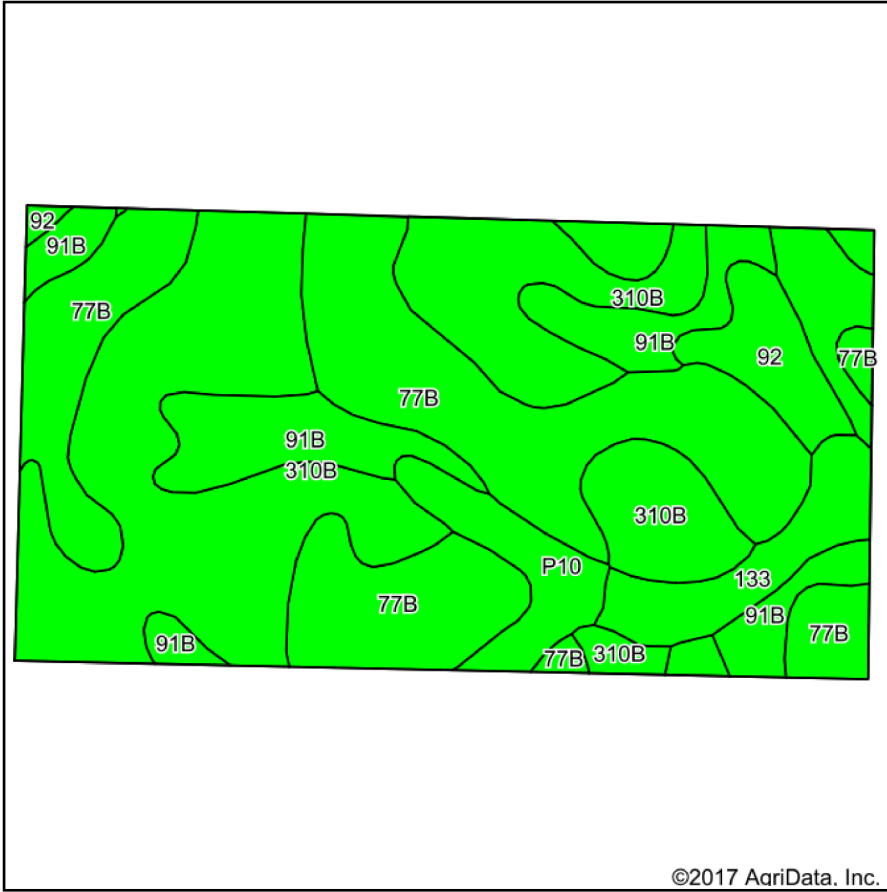

Soils data provided by USDA and NRCS.

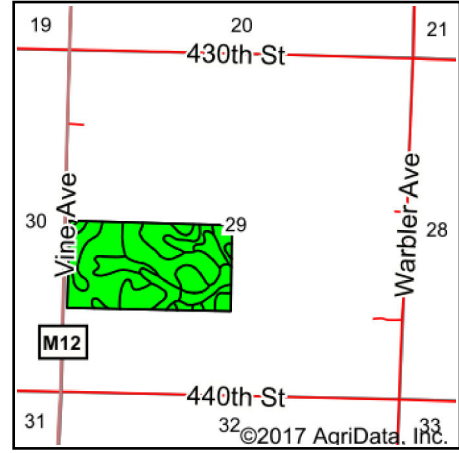

State: **Iowa**  
 County: **Obrien**  
 Location: **29-95N-39W**  
 Township: **Grant**  
 Acres: **77.78**  
 Date: **10/27/2017**

REAL ESTATE, INC  
**MIDWEST LAND**  
 712-262-3110 MANAGEMENT

Maps Provided By:  
  
 CUSTOMIZED ONLINE MAPPING  
 © AgriData, Inc. 2017 www.AgriDataInc.com



Area Symbol: IA141, Soil Area Version: 21

Code	Soil Description	Acres	Percent of field	CSR2 Legend	Non-Irr Class *c	CSR2**	CSR
310B	Galva silty clay loam, 2 to 5 percent slopes	31.11	40.0%		Ile	95	70
77B	Sac silty clay loam, loam substratum, 2 to 5 percent slopes	27.09	34.8%		Ile	95	68
91B	Primghar silty clay loam, 2 to 4 percent slopes	9.44	12.1%		Ile	94	78
133	Colo silty clay loam, deep loess, 0 to 2 percent slopes, occasionally flooded	3.78	4.9%		Ilw	78	73
P10	Afton silty clay loam, Sheldon creek formation, 0 to 2 percent slopes, occasionally flooded	3.26	4.2%		Ilw	82	
92	Marcus silty clay loam, 0 to 2 percent slopes	3.10	4.0%		Ilw	94	75
<b>Weighted Average</b>						<b>93.5</b>	<b>*-</b>

\*\*IA has updated the CSR values for each county to CSR2.

\*- CSR weighted average cannot be calculated on the current soils data, use prior data version for csr values.

\*c: Using Capabilities Class Dominant Condition Aggregation Method

Soils data provided by USDA and NRCS.