

# Soils Map

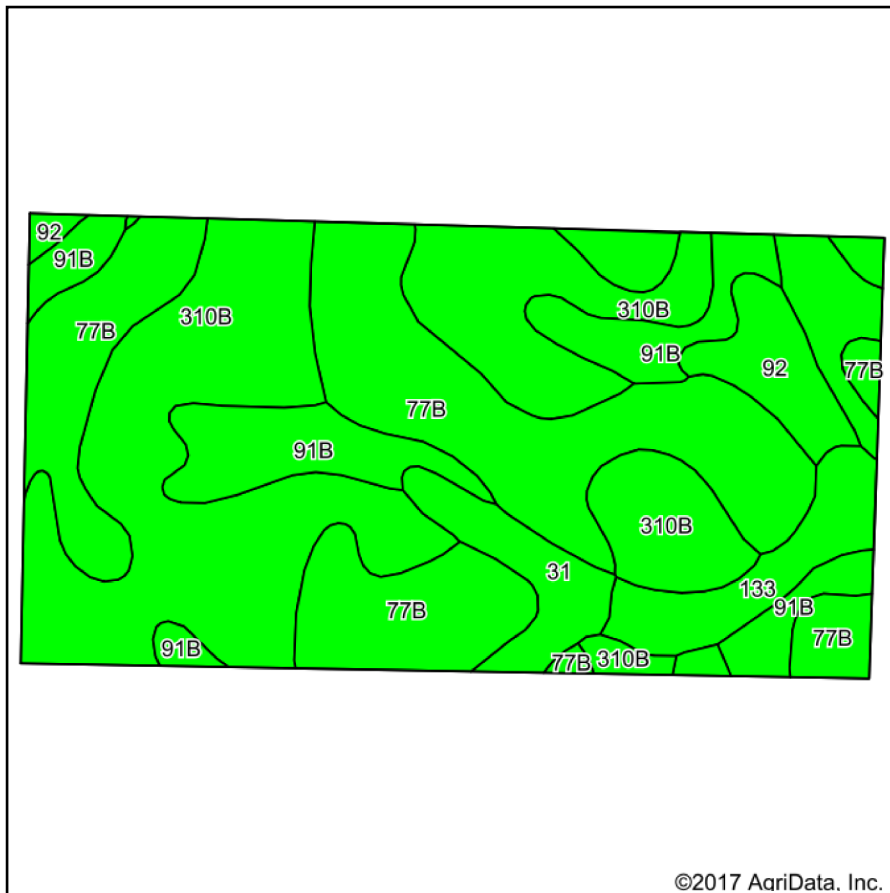

Soils data provided by USDA and NRCS.

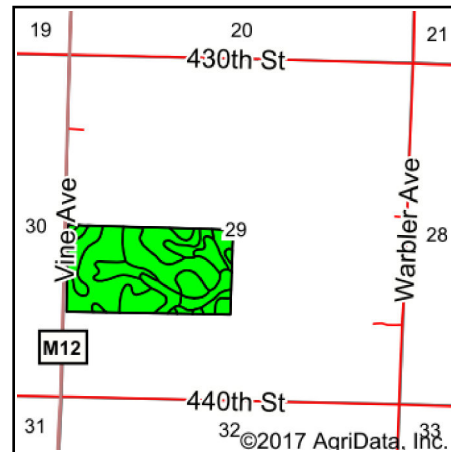

State: **Iowa**  
 County: **Obrien**  
 Location: **29-95N-39W**  
 Township: **Grant**  
 Acres: **77.78**  
 Date: **10/27/2017**

**MIDWEST LAND**  
 & REAL ESTATE, INC.  
 712-262-3110 MANAGEMENT

Maps Provided By:  
  
 CUSTOMIZED ONLINE MAPPING  
 © AgriData, Inc. 2017 www.AgriDataInc.com

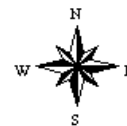

## Archived Soils Ending 1/21/2012

Code	Soil Description	Acres	Percent of field	CSR Legend	Non-Irr Class *c	CSR*
310B	Galva silty clay loam, 2 to 5 percent slopes	31.25	40.2%		Ile	70
77B	Sac silty clay loam, 2 to 5 percent slopes	27.03	34.8%		Ile	68
91B	Primghar silty clay loam, 2 to 4 percent slopes	9.38	12.1%		Ile	78
133	Colo silty clay loam, 0 to 2 percent slopes	3.78	4.9%		Ilw	73
92	Marcus silty clay loam, 0 to 2 percent slopes	3.21	4.1%		Ilw	75
31	Afton silty clay loam, 0 to 2 percent slopes	3.13	4.0%		Ilw	72
<b>Weighted Average</b>						<b>70.7</b>

\*The CSR ratings are dated 1/21/2012 and will be available to aid in the transition to CSR2.

\*c: Using Capabilities Class Dominant Condition Aggregation Method

Soils data provided by USDA and NRCS.