

# Soils Map

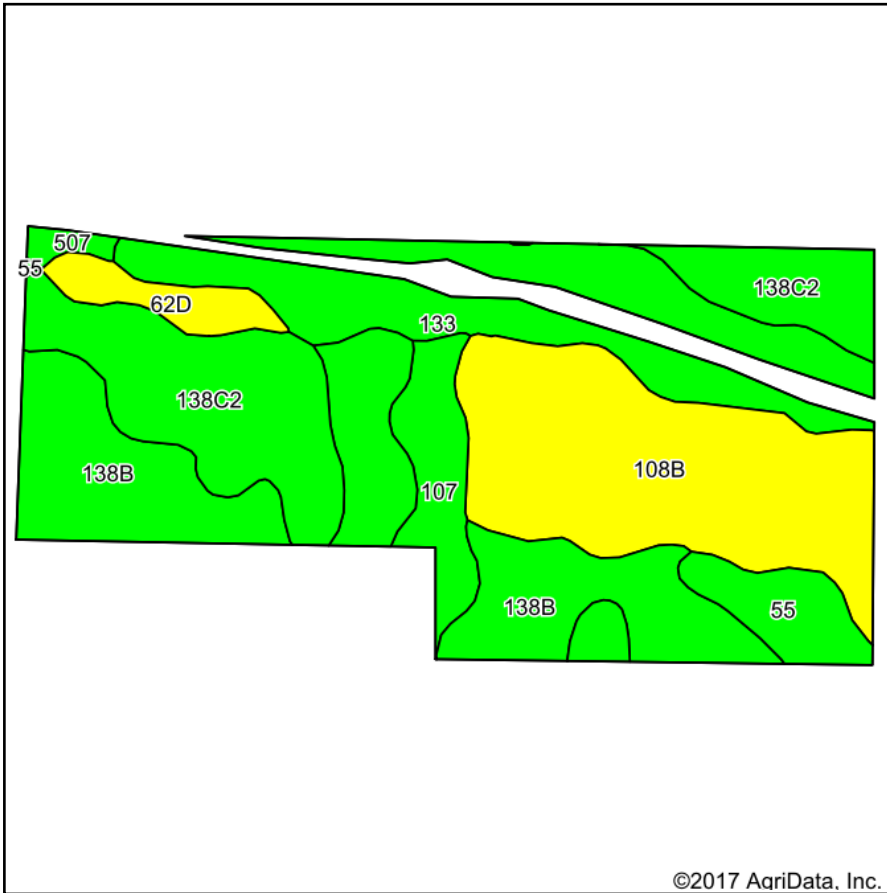

Soils data provided by USDA and NRCS.

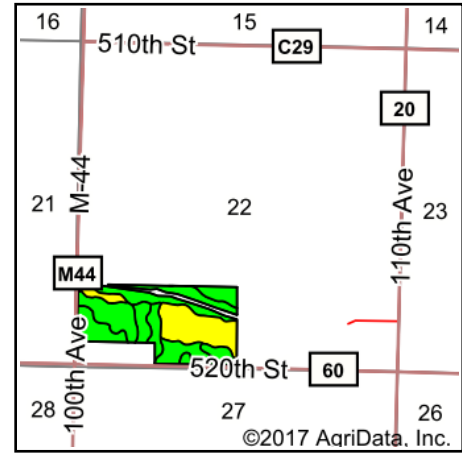









State: **Iowa**  
 County: **Buena Vista**  
 Location: **22-92N-37W**  
 Township: **Scott**  
 Acres: **63.68**  
 Date: **1/25/2018**

& REAL ESTATE, INC  
**MIDWEST LAND**  
 MANAGEMENT  
 712-262-3110  
 Maps Provided By:  
  
 CUSTOMIZED ONLINE MAPPING  
 © AgriData, Inc. 2017 www.AgriDataInc.com



## Area Symbol: IA021, Soil Area Version: 23

| Code                    | Soil Description  | Acres | Percent of field | CSR2 Legend   | Non-Irr Class *c | CSR2**      | CSR         |
|-------------------------|---|-------|------------------|---|------------------|-------------|-------------|
| 138B                    | Clarion loam, 2 to 6 percent slopes   | 15.63 | 24.5%            |  | Ile              | 89          | 76          |
| 108B                    | Wadena loam, 2 to 6 percent slopes  | 15.39 | 24.2%            |  | Ile              | 52          | 48          |
| 138C2                   | Clarion loam, 6 to 10 percent slopes, moderately eroded                       | 12.06 | 18.9%            |  | IIle             | 83          | 60          |
| 133                     | Colo silty clay loam, deep loess, 0 to 2 percent slopes, occasionally flooded | 11.50 | 18.1%            |  | IIw              | 78          | 76          |
| 107                     | Webster clay loam, 0 to 2 percent slopes                                      | 3.32  | 5.2%             |  | IIw              | 86          | 79          |
| 55                      | Nicollet clay loam, 1 to 3 percent slopes                                     | 3.30  | 5.2%             |  | Iw               | 89          | 84          |
| 62D                     | Storden loam, 10 to 16 percent slopes, moderately eroded                      | 1.96  | 3.1%             |  | IVe              | 41          | 39          |
| 507                     | Canisteo clay loam, 0 to 2 percent slopes                                     | 0.52  | 0.8%             |  | IIw              | 84          | 74          |
| <b>Weighted Average</b> |   |       |                  |   |                  | <b>75.3</b> | <b>65.6</b> |

\*\*IA has updated the CSR values for each county to CSR2.

\*c: Using Capabilities Class Dominant Condition Aggregation Method

Soils data provided by USDA and NRCS.