

# Soils Map

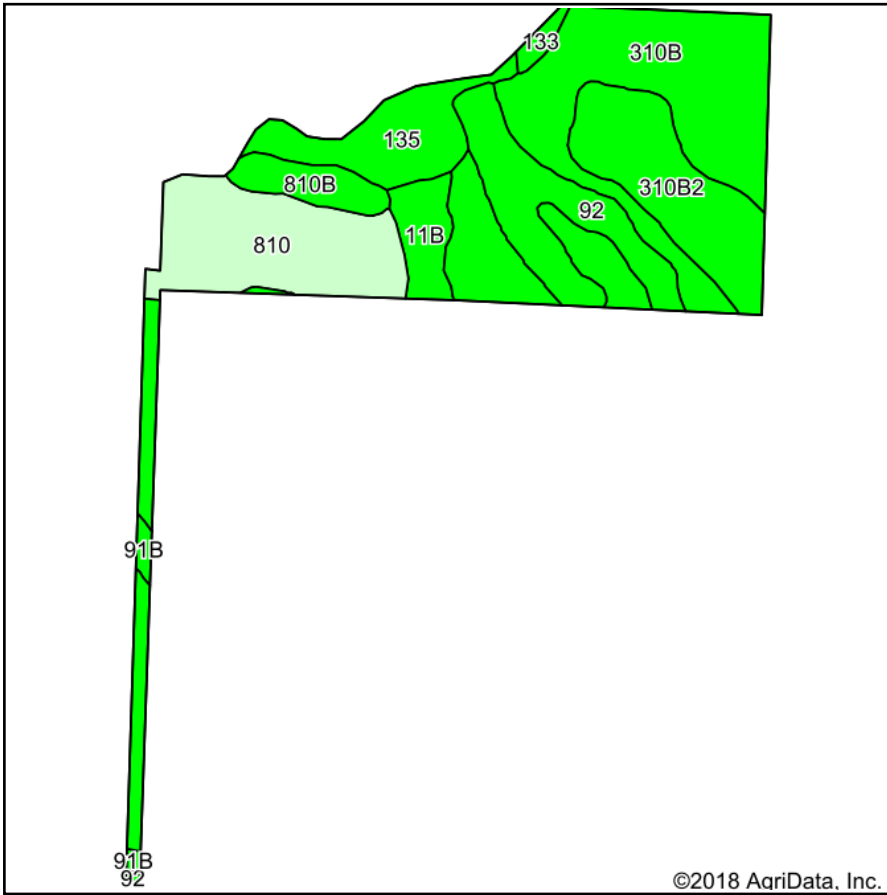

Soils data provided by USDA and NRCS.

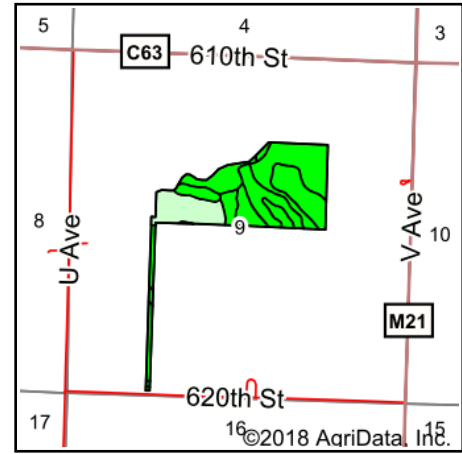

State: **Iowa**  
 County: **Cherokee**  
 Location: **9-90N-39W**  
 Township: **Diamond**  
 Acres: **64.11**  
 Date: **2/23/2018**

**MIDWEST LAND** & REAL ESTATE, INC.  
 712-262-3110 **MANAGEMENT**

Maps Provided By:

© AgriData, Inc. 2018 www.AgriDataInc.com

**Area Symbol: IA035, Soil Area Version: 27**

| Code                    | Soil Description  | Acres | Percent of field | CSR2 Legend | Non-Irr Class *c | CSR2**      | CSR       |
|-------------------------|---|-------|------------------|-------------|------------------|-------------|-----------|
| 310B                    | Galva silty clay loam, 2 to 5 percent slopes                                  | 25.04 | 39.1%            |             | Ile              | 95          | 71        |
| 810                     | Galva silty clay loam, terrace, 0 to 2 percent slopes                         | 10.65 | 16.6%            |             | I                | 100         | 76        |
| 310B2                   | Galva silty clay loam, 2 to 5 percent slopes, eroded                          | 8.86  | 13.8%            |             | Ile              | 90          | 69        |
| 92                      | Marcus silty clay loam, 0 to 2 percent slopes                                 | 7.55  | 11.8%            |             | Ilw              | 94          | 76        |
| 135                     | Coland clay loam, 0 to 2 percent slopes                                       | 5.81  | 9.1%             |             | Ilw              | 73          | 74        |
| 11B                     | Colo-Judson silty clay loams, 0 to 5 percent slopes, occasionally flooded     | 2.60  | 4.1%             |             | Ilw              | 80          | 59        |
| 810B                    | Galva silty clay loam, terrace, 2 to 5 percent slopes                         | 2.52  | 3.9%             |             | Ile              | 95          | 71        |
| 133                     | Colo silty clay loam, deep loess, 0 to 2 percent slopes, occasionally flooded | 0.59  | 0.9%             |             | Ilw              | 78          | 74        |
| 91B                     | Primghar silty clay loam, 2 to 5 percent slopes                               | 0.49  | 0.8%             |             | Ile              | 95          | 79        |
| <b>Weighted Average</b> |   |       |                  |             |                  | <b>92.3</b> | <b>72</b> |

\*\*IA has updated the CSR values for each county to CSR2.

\*c: Using Capabilities Class Dominant Condition Aggregation Method

Soils data provided by USDA and NRCS.