

Soils Map

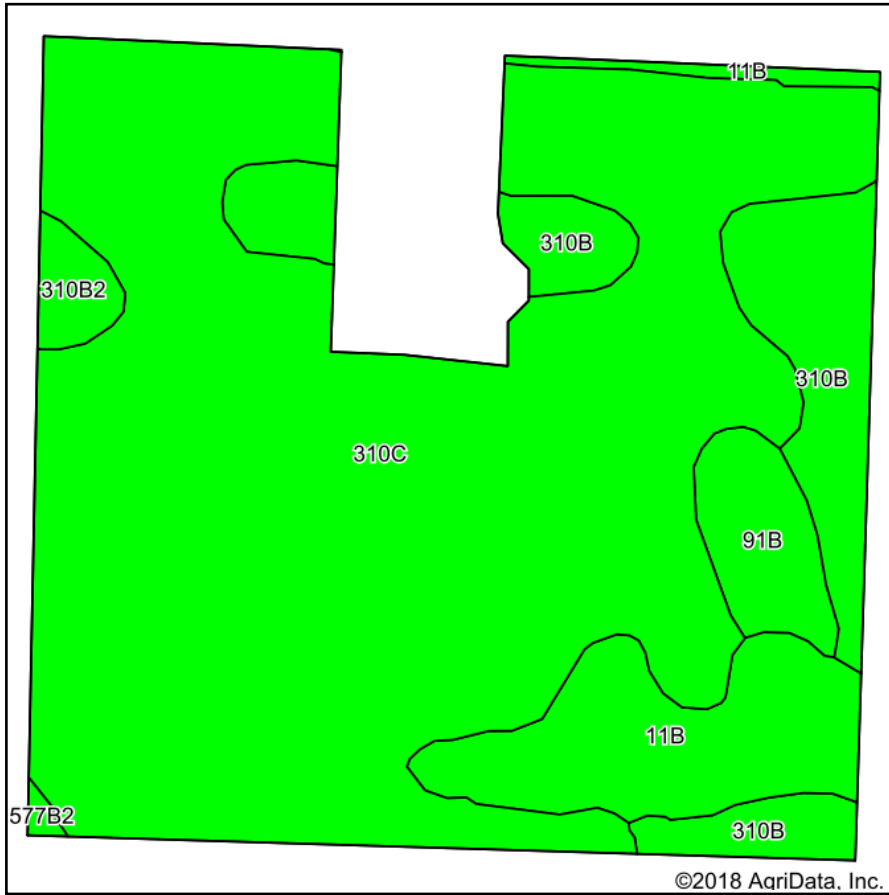

Soils data provided by USDA and NRCS.

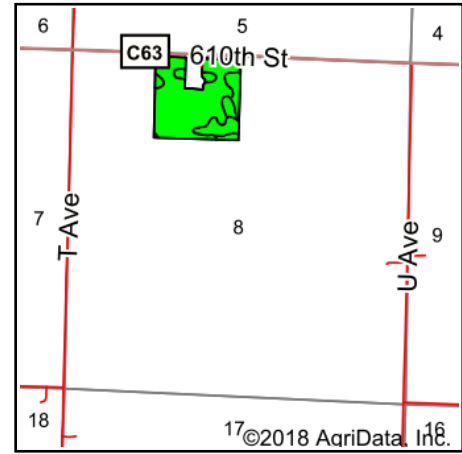

State: **Iowa**
 County: **Cherokee**
 Location: **8-90N-39W**
 Township: **Diamond**
 Acres: **35.53**
 Date: **2/23/2018**

& REAL ESTATE, INC
MIDWEST LAND
 712-262-3110 MANAGEMENT

Maps Provided By:

© AgriData, Inc. 2018 www.AgriDataInc.com

Area Symbol: IA035, Soil Area Version: 27

Code	Soil Description	Acres	Percent of field	CSR2 Legend	Non-Irr Class *c	CSR2**	CSR
310C	Galva silty clay loam, 5 to 9 percent slopes	26.16	73.6%		IIIe	87	56
310B	Galva silty clay loam, 2 to 5 percent slopes	4.12	11.6%		IIe	95	71
11B	Colo-Judson silty clay loams, 0 to 5 percent slopes, occasionally flooded	3.44	9.7%		IIw	80	59
91B	Primghar silty clay loam, 2 to 5 percent slopes	1.25	3.5%		IIe	95	79
310B2	Galva silty clay loam, 2 to 5 percent slopes, eroded	0.49	1.4%		IIe	90	69
577B2	Everly clay loam, 2 to 5 percent slopes, moderately eroded	0.07	0.2%		IIe	88	59
Weighted Average						87.6	59

**IA has updated the CSR values for each county to CSR2.

*c: Using Capabilities Class Dominant Condition Aggregation Method

Soils data provided by USDA and NRCS.