

Soils Map

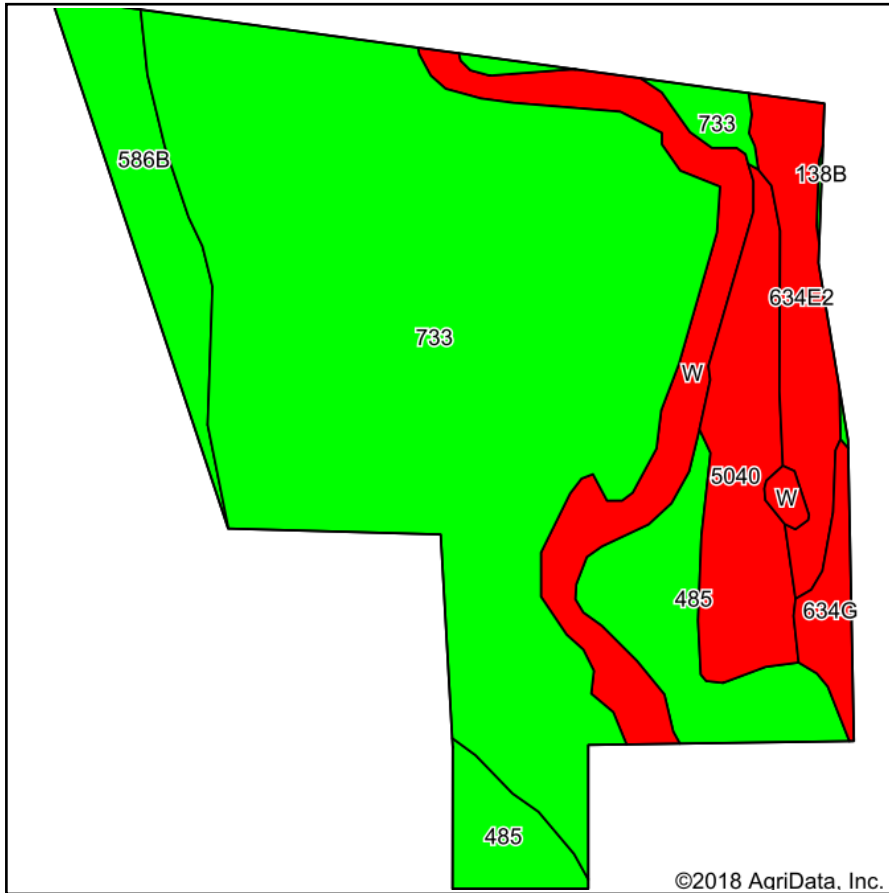

Soils data provided by USDA and NRCS.

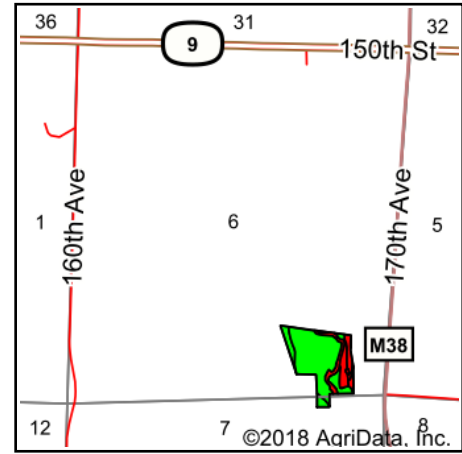

State: **Iowa**
 County: **Dickinson**
 Location: **6-99N-37W**
 Township: **Lakeville**
 Acres: **20.3**
 Date: **3/20/2018**

& REAL ESTATE, INC
MIDWEST LAND
 712-262-3110 MANAGEMENT

Maps Provided By:



Area Symbol: IA059, Soil Area Version: 27

Code	Soil Description	Acres	Percent of field	CSR2 Legend	Non-Irr Class *c	CSR2**	CSR
733	Calco silty clay loam, 0 to 2 percent slopes, occasionally flooded	12.29	60.5%		IIw	78	64
485	Spillville loam, 0 to 2 percent slopes, occasionally flooded	1.90	9.4%		IIw	88	68
W	Water	1.82	9.0%			0	0
5040	Udorthents, loamy	1.57	7.7%			5	5
586B	Coland-Spillville complex, 1 to 5 percent slopes, occasionally flooded	1.21	6.0%		IIw	74	55
634E2	Omsrud-Storden complex, 10 to 22 percent slopes, moderately eroded	1.11	5.5%		IVe	36	18
634G	Belview-Omsrud complex, 18 to 40 percent slopes	0.40	2.0%		VIe	8	6
Weighted Average						62.4	49.9

**IA has updated the CSR values for each county to CSR2.

*c: Using Capabilities Class Dominant Condition Aggregation Method

Soils data provided by USDA and NRCS.