

Soils Map

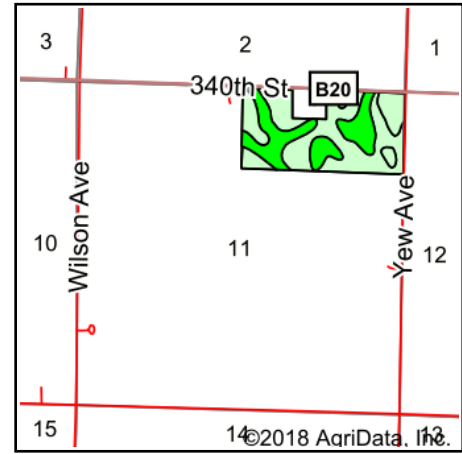

Soils data provided by USDA and NRCS.



State: **Iowa**
 County: **Obrien**
 Location: **11-96N-39W**
 Township: **Omega**
 Acres: **74**
 Date: **10/30/2018**

MIDWEST LAND & REAL ESTATE, INC
 712-262-3110 MANAGEMENT

Maps Provided By:



Area Symbol: IA141, Soil Area Version: 23

Code	Soil Description	Acres	Percent of field	CSR2 Legend	Non-Irr Class *c	CSR2**	CSR	*n NCCPI Soybeans
91	Primghar silty clay loam, 0 to 2 percent slopes	43.19	58.4%		lw	100	80	76
92	Marcus silty clay loam, 0 to 2 percent slopes	19.03	25.7%		llw	94	75	72
310	Galva silty clay loam, 0 to 2 percent slopes	7.75	10.5%		l	100	75	75
310B	Galva silty clay loam, 2 to 5 percent slopes	4.03	5.4%		lle	95	70	74
Weighted Average						98.2	77.6	*n 74.8

**IA has updated the CSR values for each county to CSR2.

*n: The aggregation method is "Weighted Average using major components"

*c: Using Capabilities Class Dominant Condition Aggregation Method

Soils data provided by USDA and NRCS.