

Soils Map

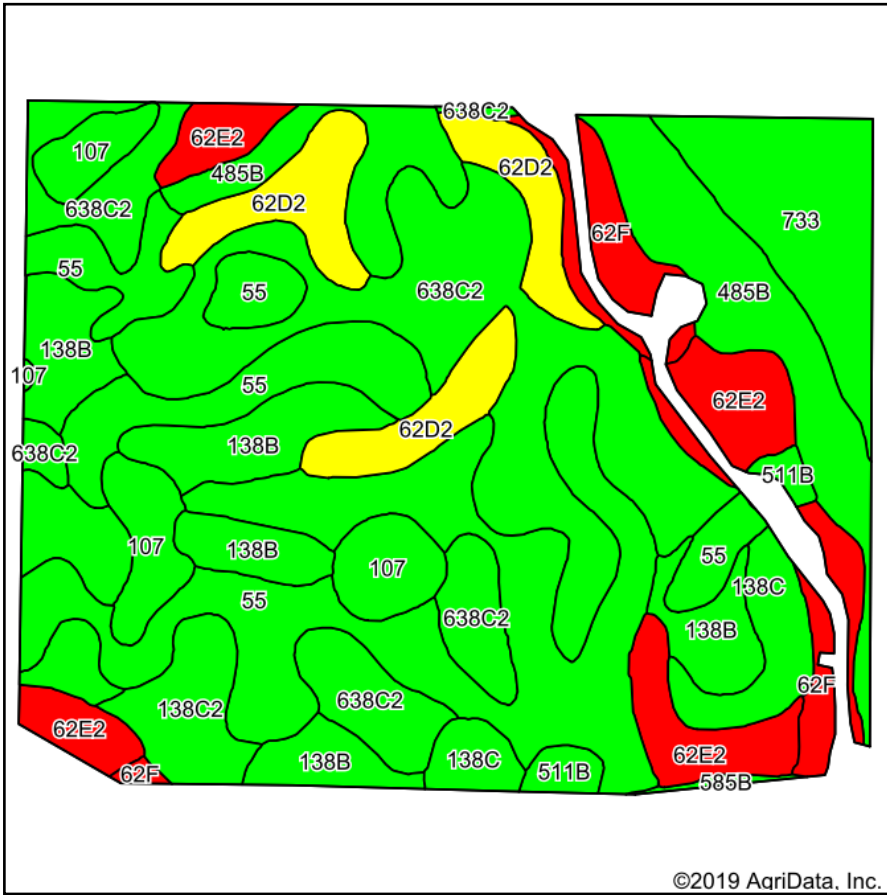

Soils data provided by USDA and NRCS.

©2019 AgriData, Inc.

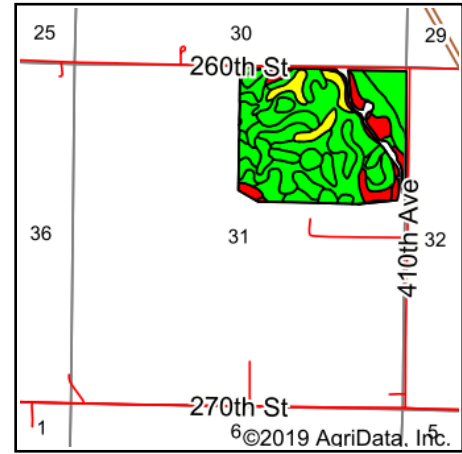

State: **Iowa**
 County: **Emmet**
 Location: **31-98N-33W**
 Township: **High Lake**
 Acres: **118.02**
 Date: **1/21/2019**

& REAL ESTATE, INC
MIDWEST LAND
 MANAGEMENT
 712-262-3110
 Maps Provided By:

 CUSTOMIZED ONLINE MAPPING
 © AgriData, Inc. 2019 www.AgriDataInc.com



Area Symbol: IA063, Soil Area Version: 28

Code	Soil Description	Acres	Percent of field	CSR2 Legend	Non-Irr Class *c	CSR2**	CSR	*n NCCPI Soybeans
55	Nicollet clay loam, 1 to 3 percent slopes	27.39	23.2%		Iw	89	82	78
638C2	Clarion-Storden complex, 6 to 10 percent slopes, moderately eroded	24.07	20.4%		IIle	75	53	65
138B	Clarion loam, 2 to 6 percent slopes	13.70	11.6%		Ile	89	74	83
485B	Spillville loam, 2 to 5 percent slopes	11.09	9.4%		Ile	88	79	82
62E2	Storden loam, 10 to 22 percent slopes, moderately eroded	8.11	6.9%		IVe	32	29	53
62D2	Storden loam, 10 to 16 percent slopes, moderately eroded	8.10	6.9%		IVe	41	38	61
733	Calco silty clay loam, 0 to 2 percent slopes, occasionally flooded	6.97	5.9%		IIw	78	68	82
107	Webster clay loam, 0 to 2 percent slopes	5.58	4.7%		IIw	86	77	80
62F	Belview loam, 16 to 30 percent slopes	4.68	4.0%		VIe	17	11	48
138C	Clarion loam, 6 to 10 percent slopes	3.87	3.3%		IIIe	84	61	80
138C2	Clarion loam, 6 to 10 percent slopes, moderately eroded	3.13	2.7%		IIIe	83	59	65
511B	Blue Earth mucky silt loam, 1 to 5 percent slopes	1.11	0.9%		IIIw	78	45	74
585B	Coland-Spillville complex, 2 to 5 percent slopes	0.22	0.2%		IIw	77	60	86
Weighted Average						74.7	62.6	*n 72.3

**IA has updated the CSR values for each county to CSR2.

*n: The aggregation method is "Weighted Average using major components"

*c: Using Capabilities Class Dominant Condition Aggregation Method

Soils data provided by USDA and NRCS.