

Soils Map

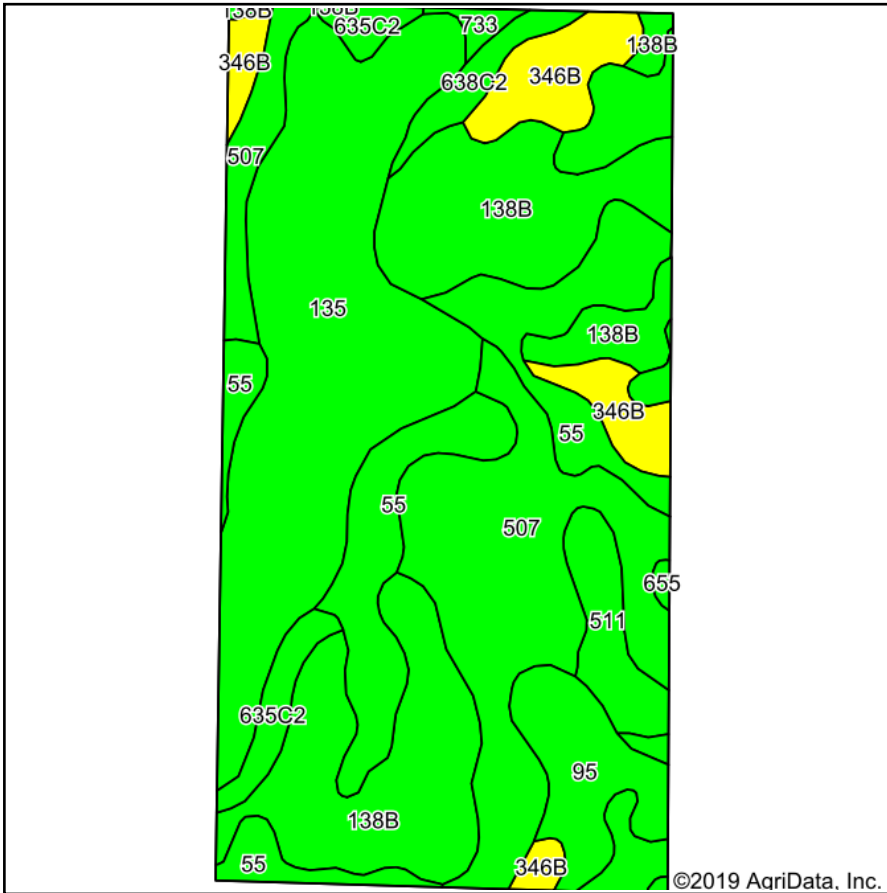

Soils data provided by USDA and NRCS.

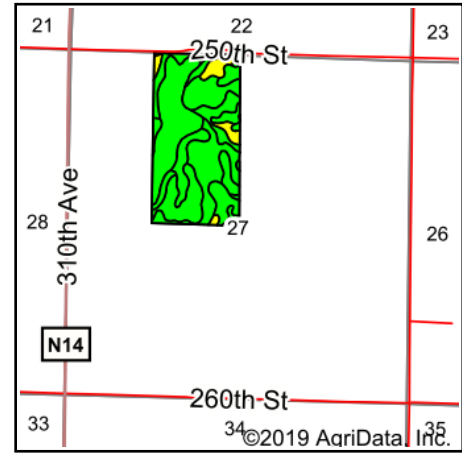

State: **Iowa**
 County: **Dickinson**
 Location: **27-98N-35W**
 Township: **Lloyd**
 Acres: **80**
 Date: **3/14/2019**

& REAL ESTATE, INC
MIDWEST LAND
 712-262-3110 MANAGEMENT

Maps Provided By:

 CUSTOMIZED ONLINE MAPPING
 © AgriData, Inc. 2019 www.AgriDataInc.com



Area Symbol: IA059, Soil Area Version: 28

| Code | Soil Description | Acres | Percent of field | CSR2 Legend | Non-Irr Class *c | CSR2** | CSR |
|-------------------------|--|-------|------------------|-------------|------------------|-------------|-------------|
| 135 | Coland clay loam, 0 to 2 percent slopes, occasionally flooded | 19.44 | 24.3% | | IIw | 76 | 58 |
| 138B | Clarion loam, 2 to 6 percent slopes | 17.56 | 21.9% | | Ile | 89 | 73 |
| 507 | Canisteo clay loam, 0 to 2 percent slopes | 15.04 | 18.8% | | IIw | 84 | 71 |
| 55 | Nicollet clay loam, 1 to 3 percent slopes | 12.79 | 16.0% | | Iw | 89 | 73 |
| 346B | Augusta Lake-Estherville complex, 2 to 5 percent slopes | 5.11 | 6.4% | | IIIe | 54 | 40 |
| 95 | Harps clay loam, 0 to 2 percent slopes | 3.82 | 4.8% | | IIw | 72 | 57 |
| 511 | Blue Earth mucky silt loam, 0 to 1 percent slopes | 2.39 | 3.0% | | IIIw | 66 | 49 |
| 635C2 | Belview-Storden complex, 5 to 9 percent slopes, moderately eroded | 1.97 | 2.5% | | IIIe | 66 | 18 |
| 638C2 | Clarion-Storden complex, 6 to 10 percent slopes, moderately eroded | 1.29 | 1.6% | | IIIe | 75 | 52 |
| 733 | Calco silty clay loam, 0 to 2 percent slopes, occasionally flooded | 0.39 | 0.5% | | IIw | 78 | 64 |
| 655 | Crippin loam, 1 to 3 percent slopes | 0.20 | 0.2% | | Ie | 91 | 71 |
| Weighted Average | | | | | | 80.3 | 63.6 |

**IA has updated the CSR values for each county to CSR2.

*c: Using Capabilities Class Dominant Condition Aggregation Method

Soils data provided by USDA and NRCS.