

Soils Map

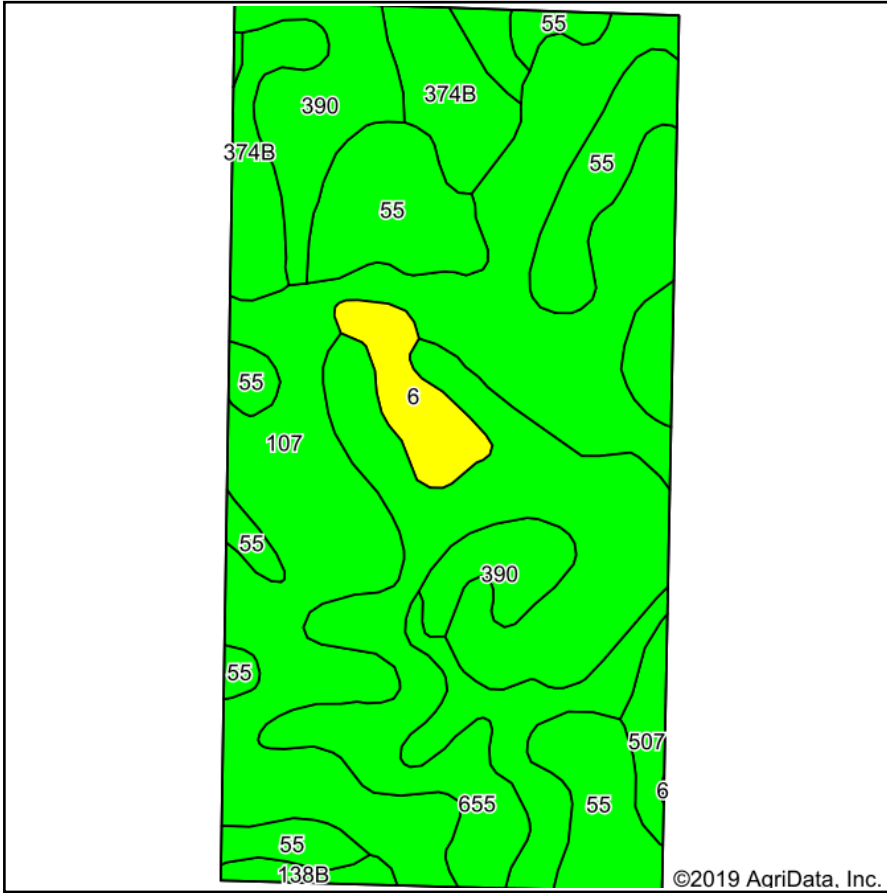

Soils data provided by USDA and NRCS.

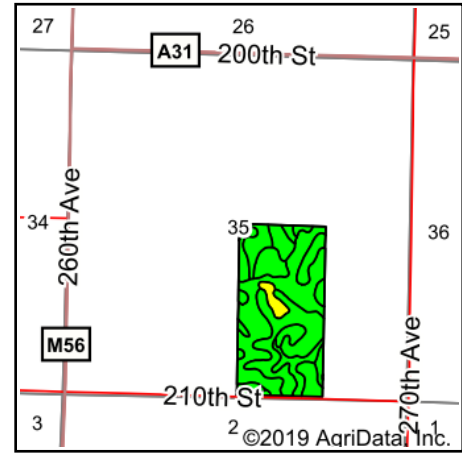

State: **Iowa**
 County: **Dickinson**
 Location: **35-99N-36W**
 Township: **Center Grove**
 Acres: **79.65**
 Date: **5/7/2019**

& REAL ESTATE, INC
MIDWEST LAND
 712-262-3110 MANAGEMENT
 Maps Provided By:

 CUSTOMIZED ONLINE MAPPING
 © AgriData, Inc. 2019 www.AgriDataInc.com



Area Symbol: IA059, Soil Area Version: 28

Code	Soil Description	Acres	Percent of field	CSR2 Legend	Non-Irr Class *c	CSR2**	CSR
107	Webster clay loam, 0 to 2 percent slopes	30.61	38.4%		IIw	86	70
655	Crippin loam, 1 to 3 percent slopes	16.87	21.2%		Ie	91	71
55	Nicollet clay loam, 1 to 3 percent slopes	14.67	18.4%		Iw	89	73
390	Waldorf silty clay loam, 0 to 2 percent slopes	7.27	9.1%		IIw	69	59
374B	Okabena silty clay loam, 1 to 5 percent slopes	5.76	7.2%		Iw	91	73
6	Okoboji silty clay loam, 0 to 1 percent slopes	2.49	3.1%		IIIw	59	43
507	Canisteo clay loam, 0 to 2 percent slopes	1.26	1.6%		IIw	84	71
138B	Clarion loam, 2 to 6 percent slopes	0.72	0.9%		Ile	89	73
Weighted Average						85.6	69.2

**IA has updated the CSR values for each county to CSR2.

*c: Using Capabilities Class Dominant Condition Aggregation Method

Soils data provided by USDA and NRCS.