

# Soils Map

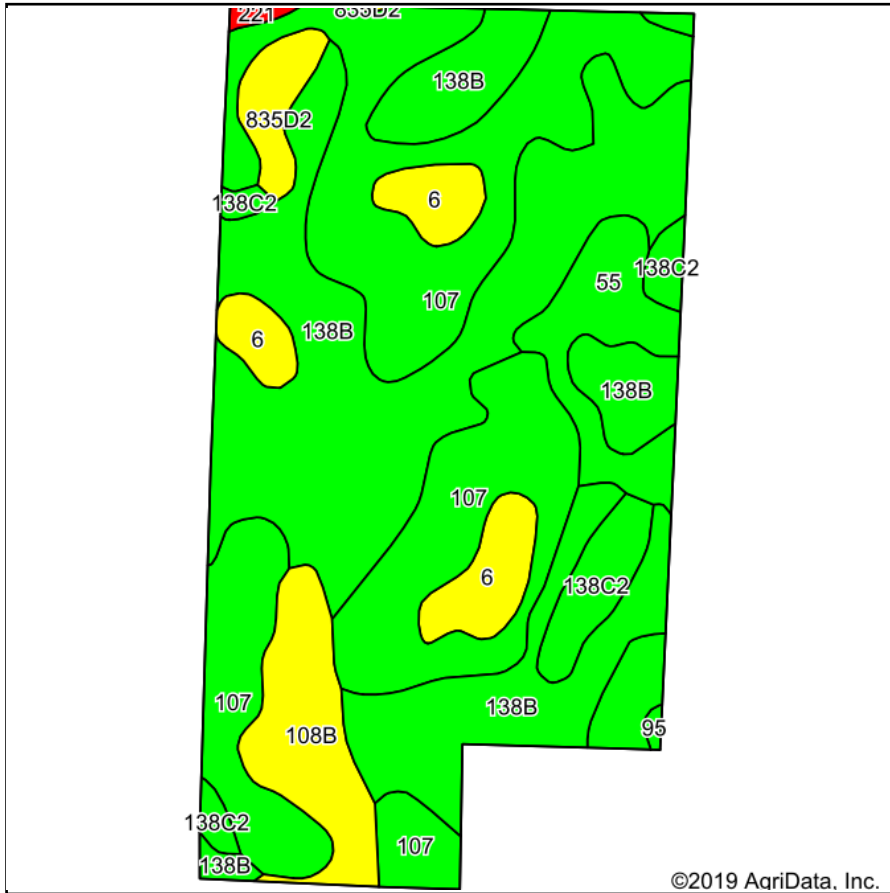

Soils data provided by USDA and NRCS.

©2019 AgriData, Inc.

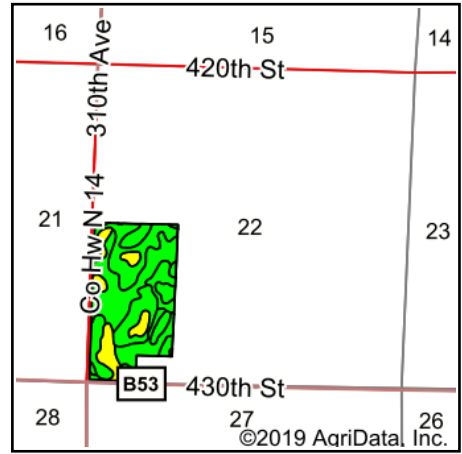

State: **Iowa**  
 County: **Clay**  
 Location: **22-95N-35W**  
 Township: **Logan**  
 Acres: **76.56**  
 Date: **5/17/2019**

**MIDWEST LAND** & REAL ESTATE, INC  
 MANAGEMENT  
 712-262-3110

Maps Provided By:  
  
 CUSTOMIZED ONLINE MAPPING  
 © AgriData, Inc. 2019 www.AgriDataInc.com



Area Symbol: IA041, Soil Area Version: 28

Code	Soil Description	Acres	Percent of field	CSR2 Legend	Non-Irr Class *c	CSR2**	CSR
138B	Clarion loam, 2 to 6 percent slopes	30.42	39.7%		Ile	89	74
107	Webster clay loam, 0 to 2 percent slopes	27.92	36.5%		IIw	86	77
108B	Wadena loam, 2 to 6 percent slopes	4.70	6.1%		Ile	52	47
6	Okoboji silty clay loam, 0 to 1 percent slopes	4.34	5.7%		IIIw	59	55
55	Nicollet clay loam, 1 to 3 percent slopes	4.05	5.3%		Iw	89	82
138C2	Clarion loam, 6 to 10 percent slopes, moderately eroded	3.09	4.0%		IIIe	83	59
835D2	Omsrud-Storden complex, 10 to 16 percent slopes, moderately eroded	1.67	2.2%		IVe	53	46
221	Klossner muck, 0 to 1 percent slopes	0.25	0.3%		IIIw	32	48
95	Harps clay loam, 0 to 2 percent slopes	0.12	0.2%		IIw	72	57
<b>Weighted Average</b>						<b>82.7</b>	<b>71.5</b>

\*\*IA has updated the CSR values for each county to CSR2.

\*c: Using Capabilities Class Dominant Condition Aggregation Method

Soils data provided by USDA and NRCS.