

# Soils Map

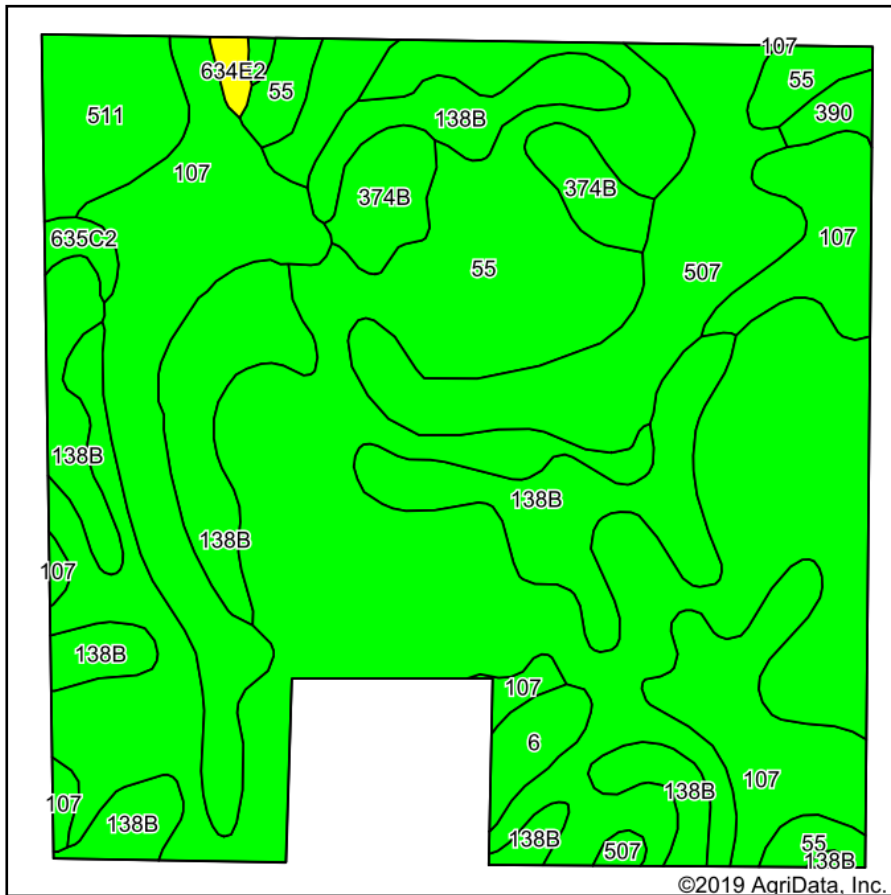

Soils data provided by USDA and NRCS.

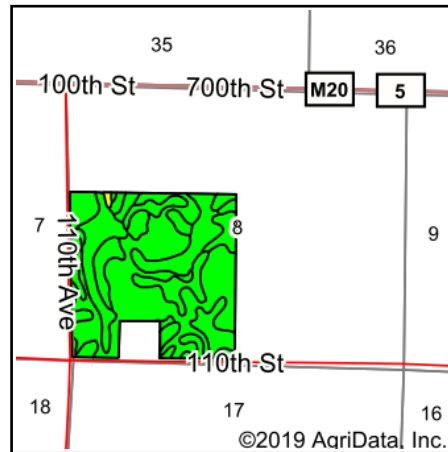

State: **Iowa**  
 County: **Dickinson**  
 Location: **8-100N-38W**  
 Township: **Silver Lake**  
 Acres: **143.61**  
 Date: **1/17/2020**

712-262-3110 MANAGEMENT  
 Maps Provided By: CUSTOMIZED ONLINE MAPPING  
 © AgriData, Inc. 2019 www.AgriDataInc.com

Area Symbol: IA059. Soil Area Version: 29		Acres	Percent of field	CSR2 Legend	Non-Irr Class *c	CSR2**	CSR
55	Nicollet clay loam, 1 to 3 percent slopes	66.49	46.3%		Iw	89	73
107	Webster clay loam, 0 to 2 percent slopes	25.33	17.6%		IIw	86	70
138B	Clarion loam, 2 to 6 percent slopes	24.48	17.0%		IIe	89	73
507	Canisteo clay loam, 0 to 2 percent slopes	14.22	9.9%		IIw	84	71
511	Blue Earth mucky silt loam, 0 to 1 percent slopes	4.78	3.3%		IIIw	66	49
374B	Okabena silty clay loam, 1 to 5 percent slopes	4.41	3.1%		Iw	91	73
6	Okoboji silty clay loam, 0 to 1 percent slopes	1.68	1.2%		IIIw	59	43
390	Waldorf silty clay loam, 0 to 2 percent slopes	0.95	0.7%		IIw	69	59
635C2	Belview-Storden complex, 5 to 9 percent slopes, moderately eroded	0.76	0.5%		IIIe	66	18
634E2	Omsrud-Storden complex, 10 to 22 percent slopes, moderately eroded	0.51	0.4%		IVe	36	18
<b>Weighted Average</b>						<b>86.5</b>	<b>70.5</b>

\*\*IA has updated the CSR values for each county to CSR2.

\*c: Using Capabilities Class Dominant Condition Aggregation Method

Soils data provided by USDA and NRCS.