

Soils Map-CSR2

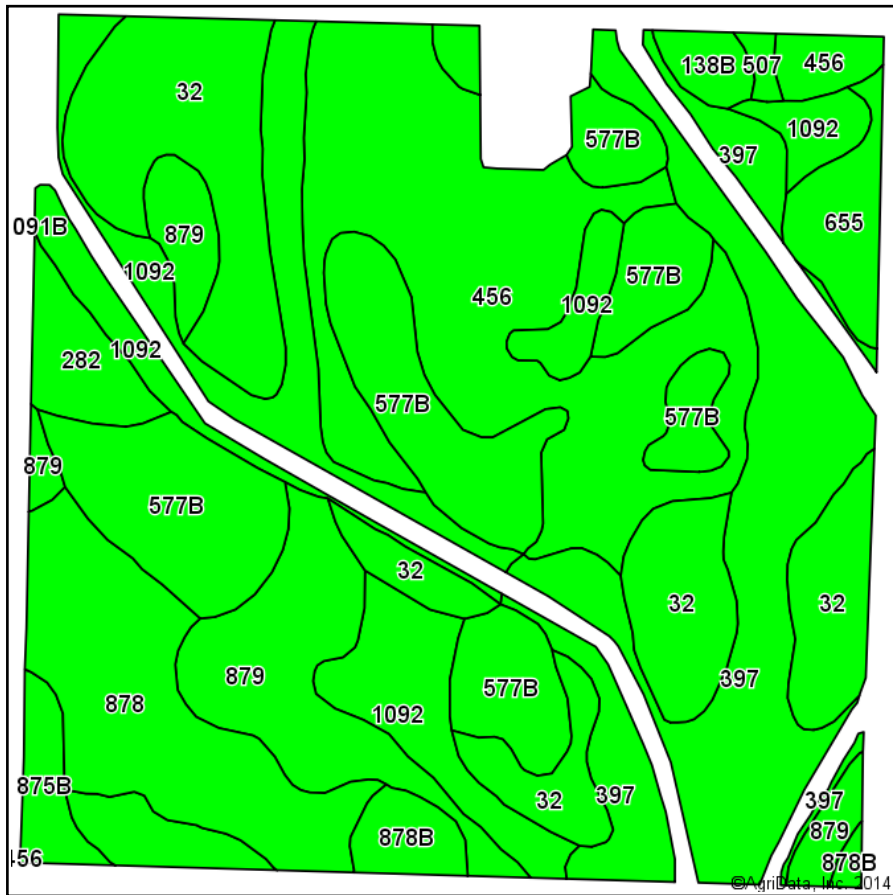

Soils data provided by USDA and NRCS.

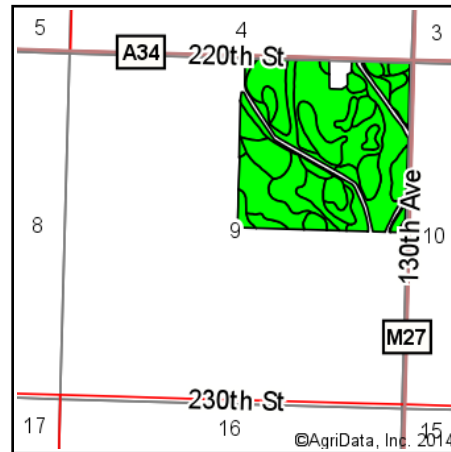

State: **Iowa**
 County: **Dickinson**
 Location: **9-98N-38W**
 Township: **Westport**
 Acres: **143.47**
 Date: **10/7/2014**

MIDWEST LAND
 & REAL ESTATE, INC.
 712-262-3110 MANAGEMENT

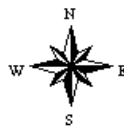

Maps Provided By:

 CUSTOMIZED ONLINE MAPPING
 © AgriData, Inc. 2014 www.AgriDataInc.com

Area Symbol: IA059, Soil Area Version: 22

Code	Soil Description	Acres	Percent of field	**CSR2 Legend	Non-Irr Class	CSR2**	CSR	Corn	Soybeans
456	Wilmington silty clay loam, 1 to 3 percent slopes	25.74	17.9%		I	91	73		
577B	Everly clay loam, 2 to 5 percent slopes	22.01	15.3%		IIe	91	73		
32	Spicer silty clay loam, MLRA 107, 0 to 2 percent slopes	21.53	15.0%		IIw	94	77		
397	Letri silty clay loam, 0 to 1 percent slopes	20.47	14.3%		IIw	90	72		
1092	Gillett Grove silty clay loam, 0 to 2 percent slopes	17.23	12.0%		IIw	94	79		
879	Fostoria loam, 1 to 3 percent slopes	13.52	9.4%		I	91	73		
878	Ocheyedan loam, 0 to 2 percent slopes	11.62	8.1%		I	96	78		
655	Crippin loam, 1 to 3 percent slopes	3.10	2.2%		I	89	71		
282	Ransom silty clay loam, 1 to 3 percent slopes	2.77	1.9%		I	95	78	135	41
878B	Ocheyedan loam, 2 to 5 percent slopes	2.01	1.4%		IIe	92	74		
875B	Roine fine sandy loam, 2 to 5 percent slopes	1.85	1.3%		IIIe	81	63		
138B	Clarion loam, 2 to 6 percent slopes	1.21	0.8%		IIe	90	73		
507	Canisteo silty clay loam, 0 to 2 percent slopes	0.41	0.3%		IIw	82	71		
Weighted Average						92	74.5	2.6	0.8

Area Symbol: IA059, Soil Area Version: 22

**IA has updated the CSR values for each county to CSR2.

Field borders provided by Farm Service Agency as of 5/21/2008. Aerial photography provided by Aerial Photography Field Office.