

Soils Map

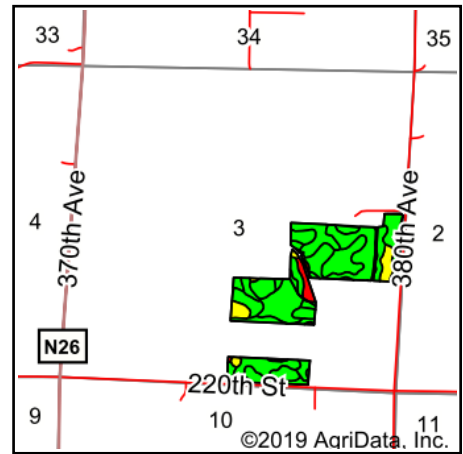
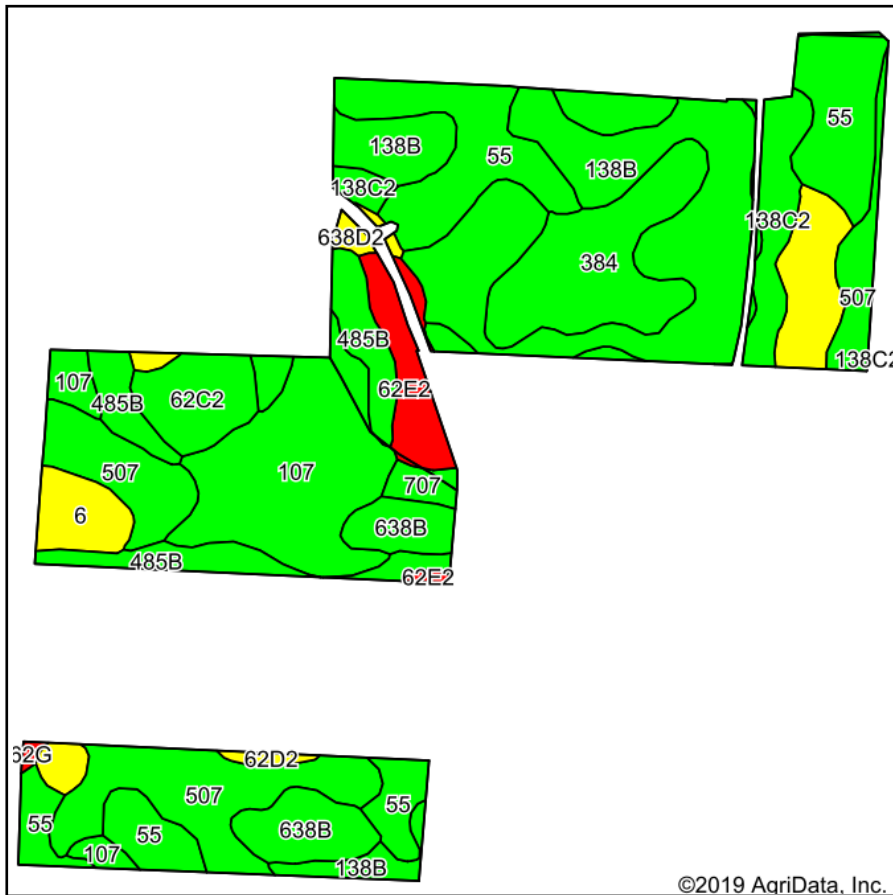

State: **Iowa**
 County: **Emmet**
 Location: **3-98N-34W**
 Township: **Twelve Mile Lake**
 Acres: **67.13**
 Date: **5/20/2020**

MIDWEST LAND & REAL ESTATE, INC
 712-262-3110 MANAGEMENT
 Maps Provided By: **surety**
 CUSTOMIZED ONLINE MAPPING
 © AgriData, Inc. 2019 www.AgriDataInc.com

Soils data provided by USDA and NRCS.

Area Symbol: IA063. Soil Area Version: 29		Acres	Percent of field	CSR2 Legend	Non-Irr Class *c	CSR2**	CSR
138B	Clarion loam, 2 to 6 percent slopes	13.04	19.4%		Ile	89	74
55	Nicollet clay loam, 1 to 3 percent slopes	11.29	16.8%		Iw	89	82
507	Canisteo clay loam, 0 to 2 percent slopes	8.61	12.8%		IIw	84	73
107	Webster clay loam, 0 to 2 percent slopes	8.25	12.3%		IIw	86	77
384	Collinwood silty clay loam, 1 to 3 percent slopes	5.33	7.9%		IIw	82	69
485B	Spillville loam, 2 to 5 percent slopes	4.50	6.7%		Ile	88	79
638B	Clarion-Swanlake complex, 2 to 6 percent slopes	3.10	4.6%		Ile	85	68
138C2	Clarion loam, 6 to 10 percent slopes, moderately eroded	3.03	4.5%		IIIe	83	59
638D2	Omsrud-Storden complex, 10 to 16 percent slopes, moderately eroded	2.76	4.1%		IVe	53	44
62C2	Storden loam, 6 to 10 percent slopes, moderately eroded	2.22	3.3%		IIIe	64	47
62E2	Storden loam, 10 to 22 percent slopes, moderately eroded	2.08	3.1%		IVe	32	29
6	Okoboji silty clay loam, 0 to 1 percent slopes	1.52	2.3%		IIIw	59	53
707	Delft clay loam, 0 to 2 percent slopes	0.58	0.9%		IIw	79	73
828B	Zenor sandy loam, 2 to 5 percent slopes	0.49	0.7%		IIIe	54	45
62D2	Storden loam, 10 to 16 percent slopes, moderately eroded	0.22	0.3%		IVe	41	
62G	Belview loam, 22 to 40 percent slopes	0.11	0.2%		VIIe	10	5
Weighted Average						81.5	*-

**IA has updated the CSR values for each county to CSR2.

*- CSR weighted average cannot be calculated on the current soils data, use prior data version for csr values.

*c: Using Capabilities Class Dominant Condition Aggregation Method

Soils data provided by USDA and NRCS.