

# Soils Map

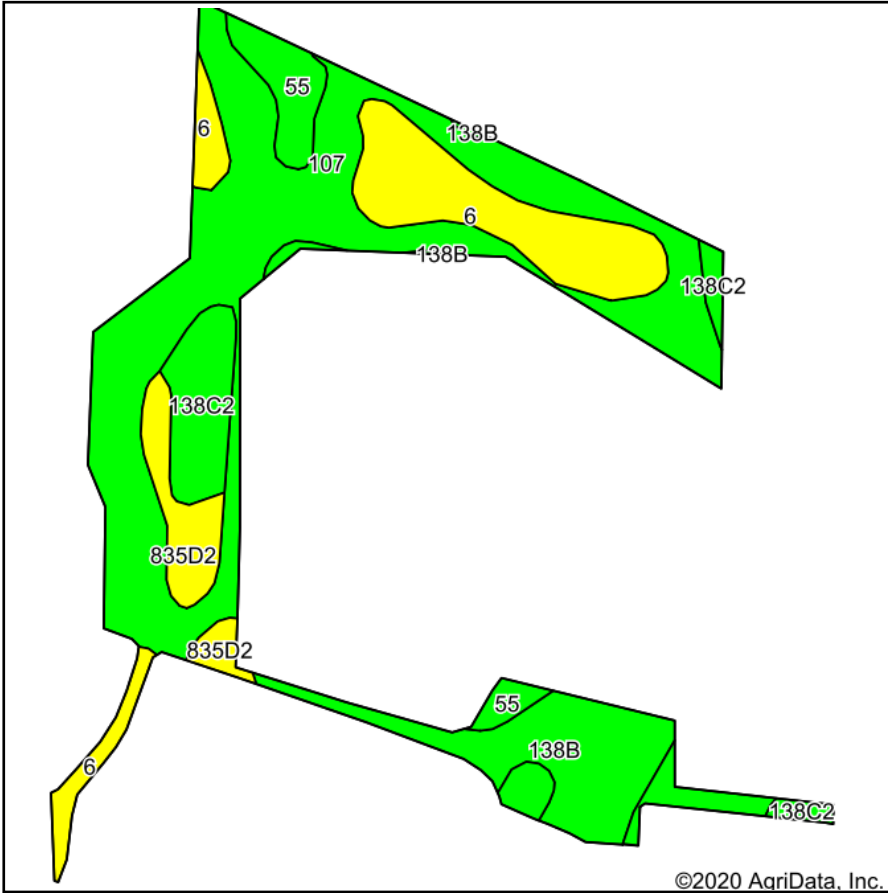

Soils data provided by USDA and NRCS.

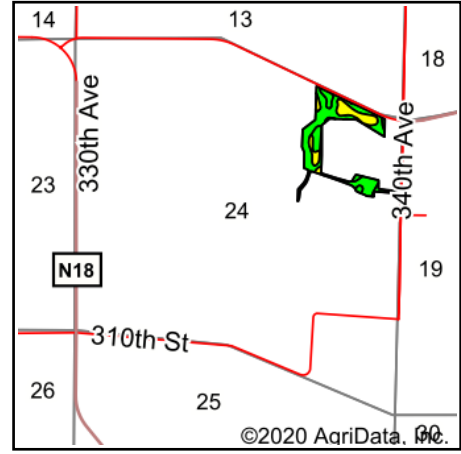

State: **Iowa**  
 County: **Clay**  
 Location: **24-97N-35W**  
 Township: **Lake**  
 Acres: **22.29**  
 Date: **9/22/2020**

712-262-3110  
**MIDWEST LAND** & REAL ESTATE, INC  
 MANAGEMENT  
 Maps Provided By:  
  
 CUSTOMIZED ONLINE MAPPING  
 © AgriData, Inc. 2020 www.AgriDataInc.com



Area Symbol: IA041. Soil Area Version: 30		Acres	Percent of field	CSR2 Legend	Non-Irr Class *c	CSR2**	CSR
107	Webster clay loam, 0 to 2 percent slopes	11.19	50.2%		IIw	86	77
6	Okoboji silty clay loam, 0 to 1 percent slopes	3.89	17.5%		IIIw	59	55
138B	Clarion loam, 2 to 6 percent slopes	2.92	13.1%		IIe	89	74
138C2	Clarion loam, 6 to 10 percent slopes, moderately eroded	1.78	8.0%		IIIe	83	59
835D2	Omsrud-Storden complex, 10 to 16 percent slopes, moderately eroded	1.33	6.0%		IVe	53	46
55	Nicollet clay loam, 1 to 3 percent slopes	1.18	5.3%		Iw	89	82
<b>Weighted Average</b>						<b>79.6</b>	<b>69.7</b>

\*\*IA has updated the CSR values for each county to CSR2.  
 \*c: Using Capabilities Class Dominant Condition Aggregation Method  
 Soils data provided by USDA and NRCS.