

Soils Map

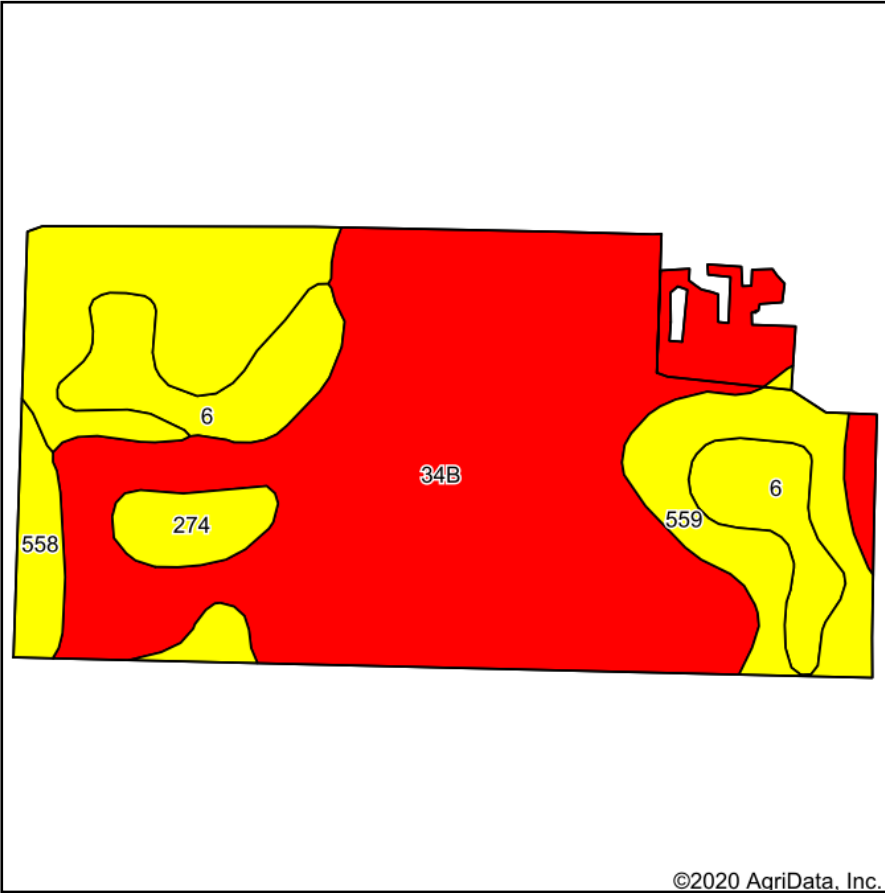

Soils data provided by USDA and NRCS.

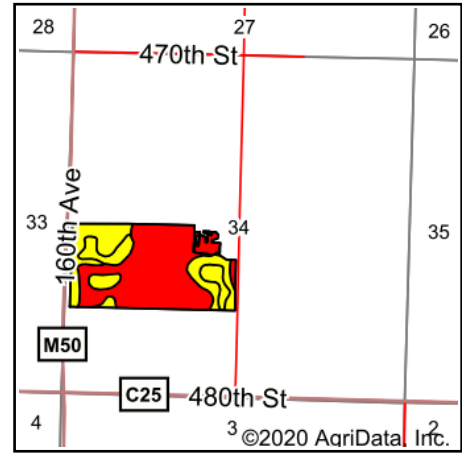

State: **Iowa**
 County: **Buena Vista**
 Location: **34-93N-36W**
 Township: **Lee**
 Acres: **72.1**
 Date: **11/18/2020**

MIDWEST LAND & REAL ESTATE, INC
 MANAGEMENT
 712-262-3110

Maps Provided By:

 CUSTOMIZED ONLINE MAPPING
 © AgriData, Inc. 2020 www.AgriDataInc.com



| Area Symbol: IA021. Soil Area Version: 26 | | | | | | | | |
|---|--|-------|------------------|-------------|------------------|-------------|-------------|--|
| Code | Soil Description | Acres | Percent of field | CSR2 Legend | Non-Irr Class *c | CSR2** | CSR | |
| 34B | Estherville sandy loam, 2 to 6 percent slopes | 44.21 | 61.3% | | IIIs | 27 | 14 | |
| 559 | Talcot clay loam, deep, 0 to 2 percent slopes | 15.88 | 22.0% | | IIw | 54 | 67 | |
| 6 | Okoboji silty clay loam, 0 to 1 percent slopes | 7.79 | 10.8% | | IIIw | 59 | 54 | |
| 274 | Rolfe silt loam, 0 to 1 percent slopes | 2.16 | 3.0% | | IIIw | 57 | 49 | |
| 558 | Talcot clay loam, moderately deep, 0 to 2 percent slopes | 2.06 | 2.9% | | IIw | 54 | 60 | |
| Weighted Average | | | | | | 38.1 | 32.4 | |

**IA has updated the CSR values for each county to CSR2.
 *c: Using Capabilities Class Dominant Condition Aggregation Method
 Soils data provided by USDA and NRCS.