

### Soils Map-CSR2

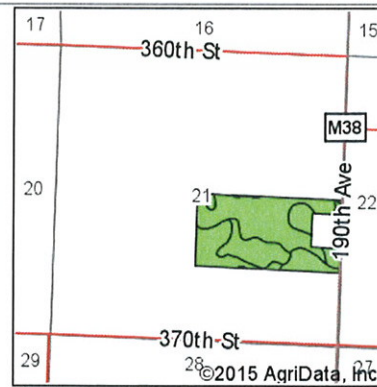
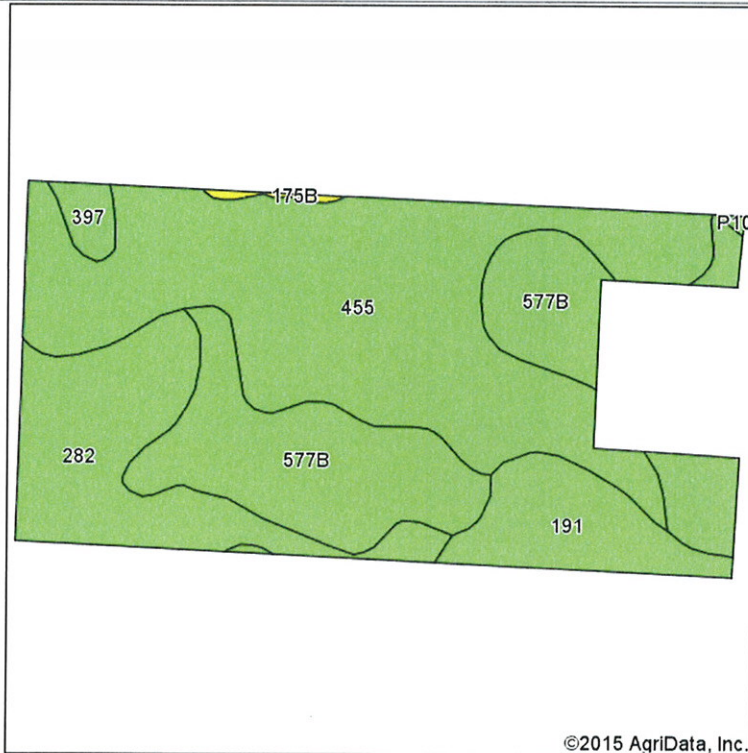

State: **Iowa**  
 County: **Clay**  
 Location: **21-96N-37W**  
 Township: **Riverton**  
 Acres: **73.21**  
 Date: **7/29/2015**

**MIDWEST LAND** & REAL ESTATE, INC.  
 712-262-3110 MANAGEMENT

Maps Provided By:



Soils data provided by USDA and NRCS.

©2015 AgriData, Inc.

Area Symbol: IA041, Soil Area Version: 22							
Code	Soil Description	Acres	Percent of field	CSR2 Legend	Non-Irr Class *c	CSR2**	CSR
455	Wilmington clay loam, 1 to 3 percent slopes	33.43	45.7%		le	91	74
577B	Everly clay loam, 2 to 5 percent slopes	19.38	26.5%		lle	88	68
282	Ransom silty clay loam, 1 to 3 percent slopes	12.57	17.2%		lw	95	81
191	Rushmore silty clay loam, 0 to 2 percent slopes	6.34	8.7%		llw	95	76
397	Letri clay loam, 0 to 2 percent slopes	1.15	1.6%		llw	90	72
175B	Dickinson fine sandy loam, 2 to 5 percent slopes	0.25	0.3%		llle	47	36
P10	Afton silty clay loam, Sheldon creek formation, 0 to 2 percent slopes, occasionally flooded	0.09	0.1%		llw	82	
<b>Weighted Average</b>						<b>91.1</b>	<b>*-</b>

\*\*IA has updated the CSR values for each county to CSR2.

\*- CSR weighted average cannot be calculated on the current soils data, use prior data version for csr values.

\*c: Using Capabilities Class Dominant Condition Aggregation Method  
 Soils data provided by USDA and NRCS.