

# Soils Map

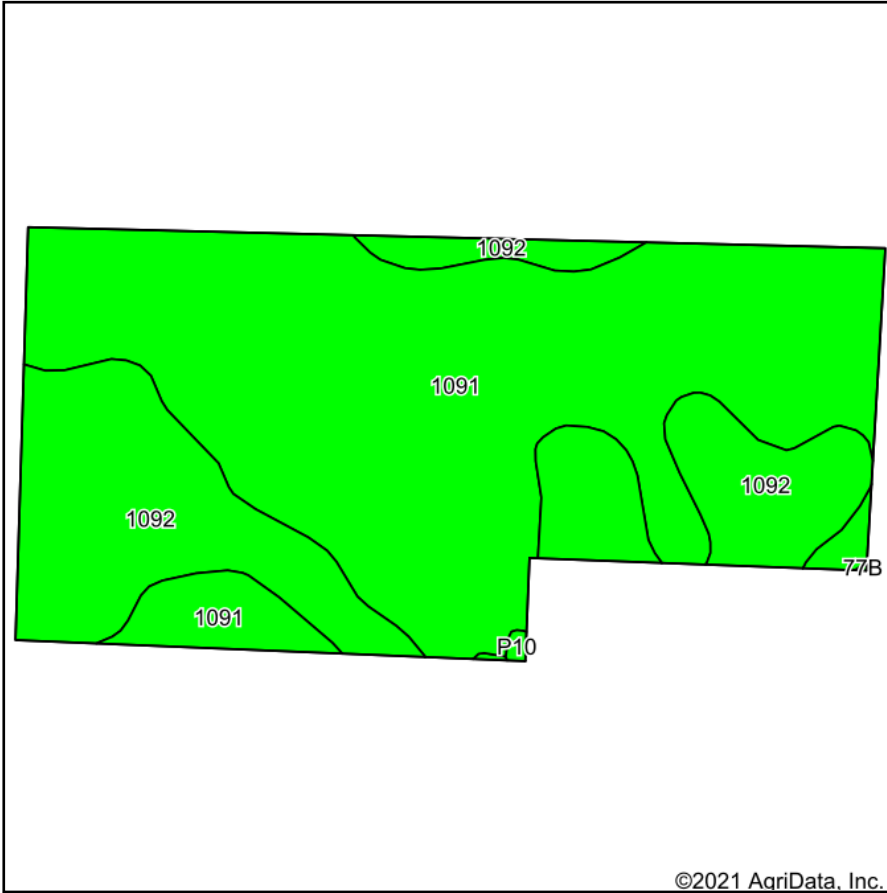

Soils data provided by USDA and NRCS.

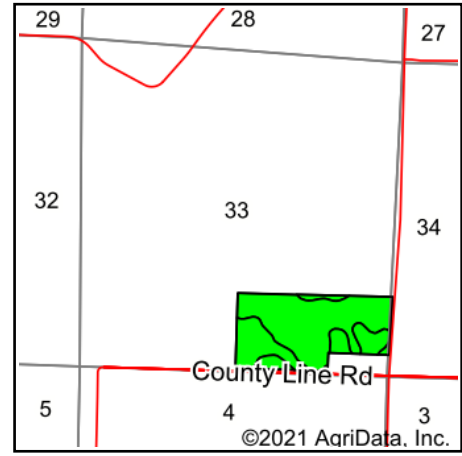

State: **Iowa**  
 County: **Clay**  
 Location: **33-94N-36W**  
 Township: **Herdland**  
 Acres: **71.6**  
 Date: **1/18/2021**

& REAL ESTATE, INC  
**MIDWEST LAND**  
 712-262-3110 MANAGEMENT  
 Maps Provided By:  
  
 CUSTOMIZED ONLINE MAPPING  
 © AgriData, Inc. 2021 www.AgriDataInc.com



Code	Soil Description	Acres	Percent of field	CSR2 Legend	Non-Irr Class *c	CSR2**	CSR
1091	McCreath silty clay loam, 0 to 2 percent slopes	48.95	68.4%		Iw	98	83
1092	Gillett Grove silty clay loam, 0 to 2 percent slopes	22.53	31.5%		Ilw	94	78
P10	Afton silty clay loam, Sheldon creek formation, 0 to 2 percent slopes, occasionally flooded	0.12	0.2%		Ilw	82	
<b>Weighted Average</b>						<b>96.7</b>	<b>*-</b>

\*\*IA has updated the CSR values for each county to CSR2.

\*- CSR weighted average cannot be calculated on the current soils data, use prior data version for csr values.

\*c: Using Capabilities Class Dominant Condition Aggregation Method

Soils data provided by USDA and NRCS.