

# Soils Map

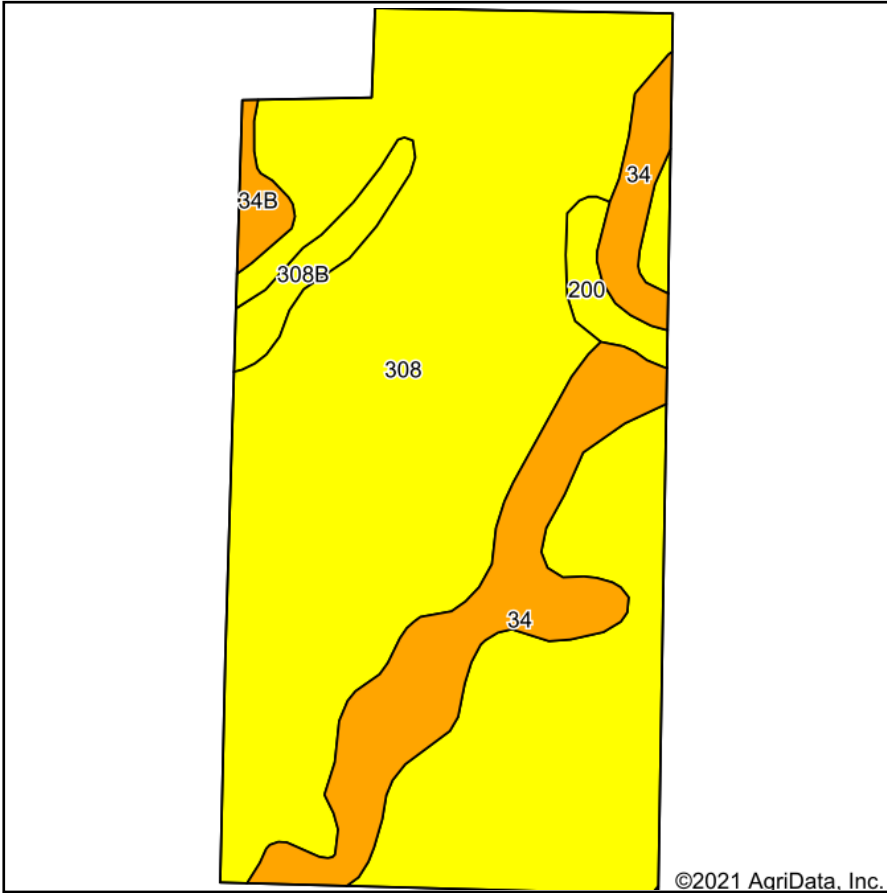

©2021 AgriData, Inc.

Soils data provided by USDA and NRCS.

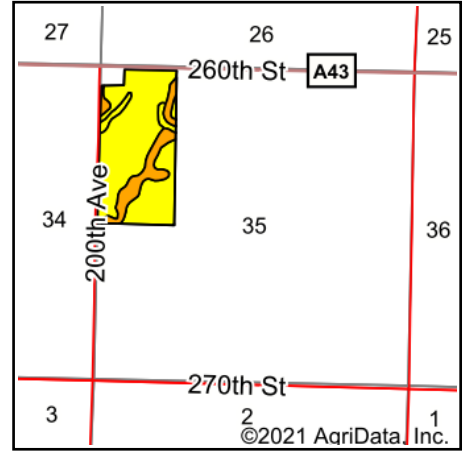

State: **Iowa**  
 County: **Dickinson**  
 Location: **35-98N-37W**  
 Township: **Okoboji**  
 Acres: **72.91**  
 Date: **4/29/2021**

& REAL ESTATE, INC  
**MIDWEST LAND**  
 712-262-3110 MANAGEMENT

Maps Provided By:



© AgriData, Inc. 2021

www.AgriDataInc.com



Area Symbol: IA059, Soil Area Version: 30

Code	Soil Description	Acres	Percent of field	CSR2 Legend	Non-Irr Class *c	CSR2**	CSR
308	Wadena loam, 0 to 2 percent slopes	57.50	78.9%		IIs	56	43
34	Estherville sandy loam, 0 to 2 percent slopes	11.19	15.3%		IIIs	29	15
308B	Wadena loam, 2 to 6 percent slopes	1.86	2.6%		Ile	52	36
200	Cylinder complex, 0 to 2 percent slopes	1.39	1.9%		IIs	59	45
34B	Estherville sandy loam, 2 to 6 percent slopes	0.97	1.3%		IIIs	27	15
<b>Weighted Average</b>						<b>51.4</b>	<b>38.2</b>

\*\*IA has updated the CSR values for each county to CSR2.

\*c: Using Capabilities Class Dominant Condition Aggregation Method

Soils data provided by USDA and NRCS.