

Soils Map

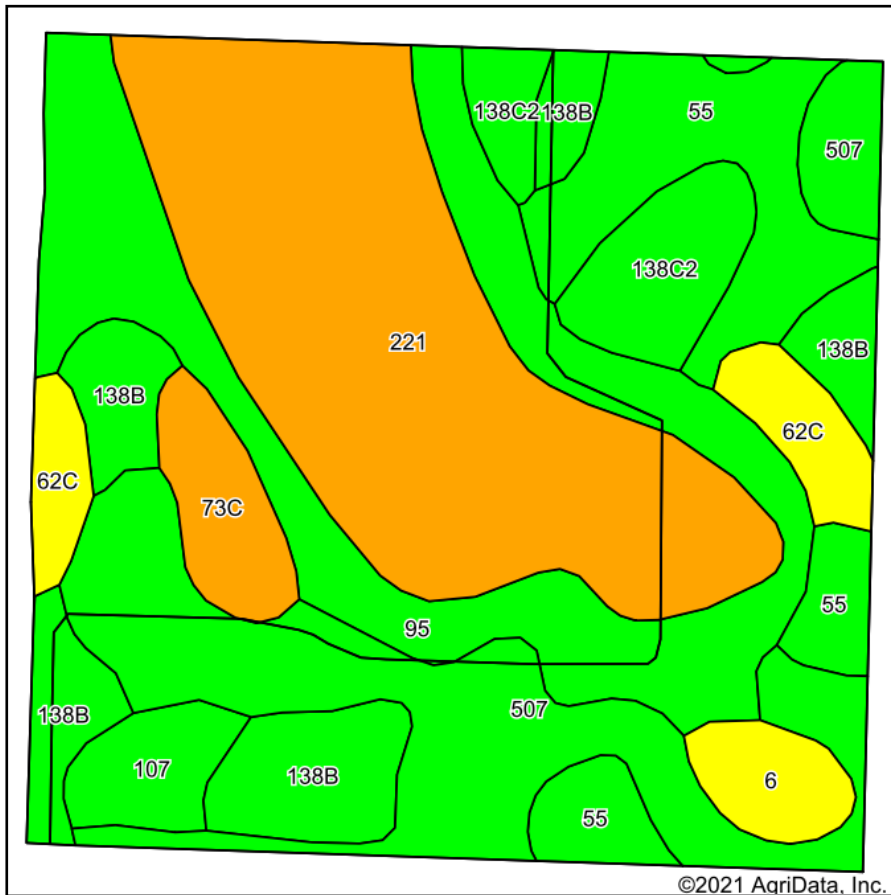

Soils data provided by USDA and NRCS.

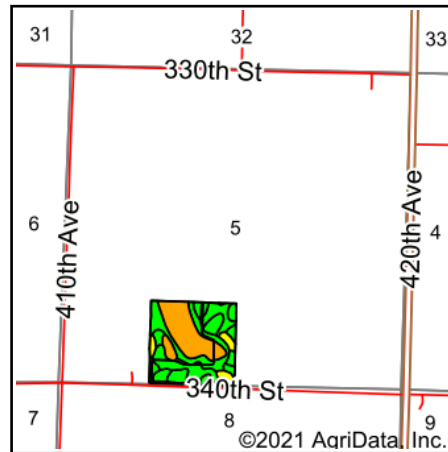

State: **Iowa**
 County: **Palo Alto**
 Location: **5-96N-33W**
 Township: **Emmetsburg**
 Acres: **38.58**
 Date: **5/4/2021**

& REAL ESTATE, INC
MIDWEST LAND
 MANAGEMENT
 712-262-3110
 Maps Provided By:

 CUSTOMIZED ONLINE MAPPING
 © AgriData, Inc. 2021 www.AgriDataInc.com



Area Symbol: IA147, Soil Area Version: 27

Code	Soil Description	Acres	Percent of field	CSR2 Legend	Non-Irr Class *c	CSR2**	CSR
221	Klossner muck, 0 to 1 percent slopes	10.45	27.1%		Illw	32	47
95	Harps clay loam, 0 to 2 percent slopes	7.07	18.3%		Ilw	72	59
507	Canisteo clay loam, 0 to 2 percent slopes	6.66	17.3%		Ilw	84	74
55	Nicollet clay loam, 1 to 3 percent slopes	4.14	10.7%		Iw	89	84
138B	Clarion loam, 2 to 6 percent slopes	3.87	10.0%		Ile	89	76
138C2	Clarion loam, 6 to 10 percent slopes, moderately eroded	1.95	5.1%		IIIe	83	58
62C	Storden loam, 6 to 10 percent slopes, moderately eroded	1.43	3.7%		IIIe	64	48
73C	Hawick gravelly sandy loam, 6 to 12 percent slopes	1.19	3.1%		IVs	31	5
107	Webster clay loam, 0 to 2 percent slopes	0.96	2.5%		Ilw	86	79
6	Okoboji silty clay loam, 0 to 1 percent slopes	0.86	2.2%		IIIw	59	54
Weighted Average						65.8	61

**IA has updated the CSR values for each county to CSR2.

*c: Using Capabilities Class Dominant Condition Aggregation Method
 Soils data provided by USDA and NRCS.