

# Soils Map

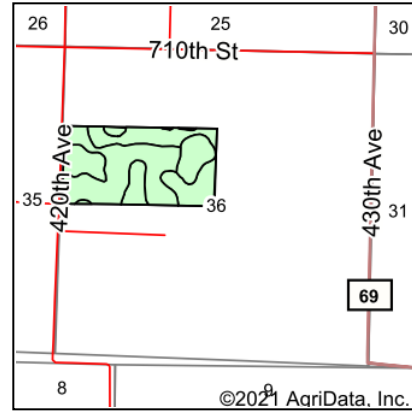
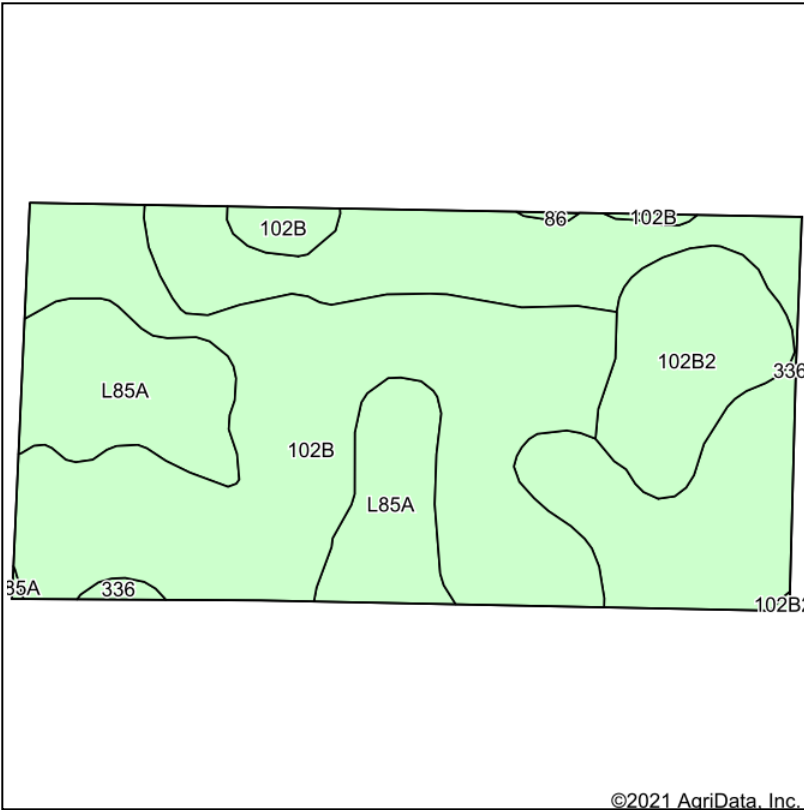

State: **Minnesota**  
 County: **Jackson**  
 Location: **36-101N-37W**  
 Township: **Sioux Valley**  
 Acres: **76.59**  
 Date: **6/17/2021**

& REAL ESTATE, INC  
**MIDWEST LAND**  
 712-262-3110 MANAGEMENT  
 Maps Provided By:  
  
 CUSTOMIZED ONLINE MAPPING  
 © AgriData, Inc. 2021 www.AgriDataInc.com

Soils data provided by USDA and NRCS.

Area Symbol: MN063, Soil Area Version: 17					
Code	Soil Description	Acres	Percent of field	Non-Irr Class *c	Productivity Index
102B	Clarion loam, 2 to 6 percent slopes	33.74	44.1%	IIe	95
336	Delft clay loam, 0 to 2 percent slopes	22.13	28.9%	IIw	94
L85A	Nicollet clay loam, 1 to 3 percent slopes	12.61	16.5%	Iw	99
102B2	Clarion loam, 2 to 6 percent slopes, moderately eroded	8.02	10.5%	IIe	95
86	Canisteo clay loam, 0 to 2 percent slopes	0.09	0.1%	IIw	93
<b>Weighted Average</b>					<b>95.4</b>

\*c: Using Capabilities Class Dominant Condition Aggregation Method

Soils data provided by USDA and NRCS.