

# Soils Map

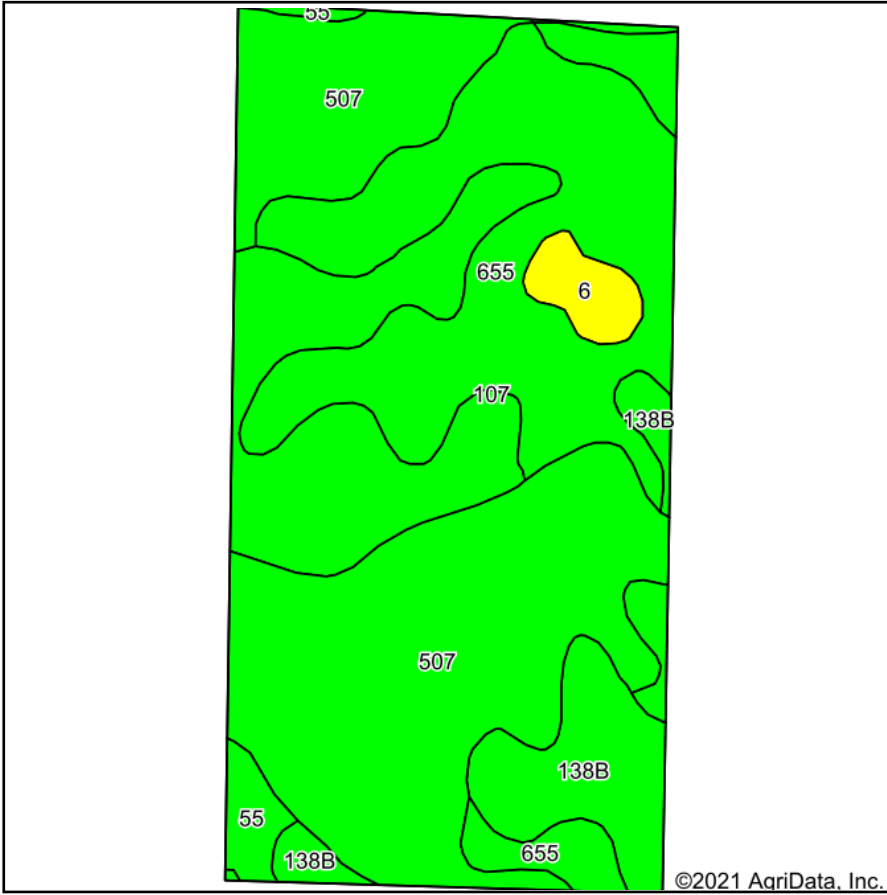

Soils data provided by USDA and NRCS.

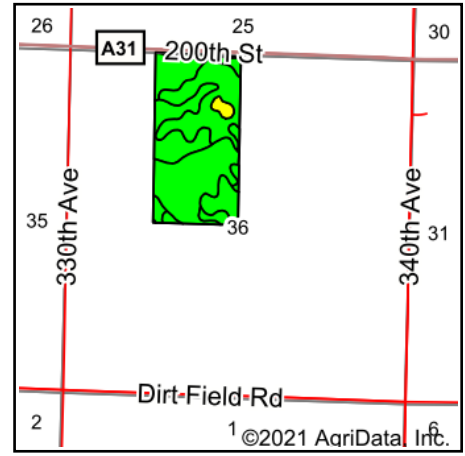







State: **Iowa**  
 County: **Dickinson**  
 Location: **36-99N-35W**  
 Township: **Richland**  
 Acres: **78.78**  
 Date: **6/22/2021**

& REAL ESTATE, INC  
**MIDWEST LAND**  
 712-262-3110 MANAGEMENT  
 Maps Provided By:  
  
 CUSTOMIZED ONLINE MAPPING  
 © AgriData, Inc. 2021 www.AgriDataInc.com



Area Symbol: IA059, Soil Area Version: 30

Code	Soil Description	Acres	Percent of field	CSR2 Legend	Non-Irr Class *c	CSR2**	CSR
507	Canisteo clay loam, 0 to 2 percent slopes	33.18	42.1%		llw	84	71
655	Crippin loam, 1 to 3 percent slopes	22.86	29.0%		le	91	71
107	Webster clay loam, 0 to 2 percent slopes	12.30	15.6%		llw	86	70
138B	Clarion loam, 2 to 6 percent slopes	7.06	9.0%		lle	89	73
55	Nicollet clay loam, 1 to 3 percent slopes	1.70	2.2%		lw	89	73
6	Okoboji silty clay loam, 0 to 1 percent slopes	1.68	2.1%		lllw	59	43
<b>Weighted Average</b>						<b>86.4</b>	<b>70.5</b>

\*\*IA has updated the CSR values for each county to CSR2.

\*c: Using Capabilities Class Dominant Condition Aggregation Method  
 Soils data provided by USDA and NRCS.