

# Soils Map

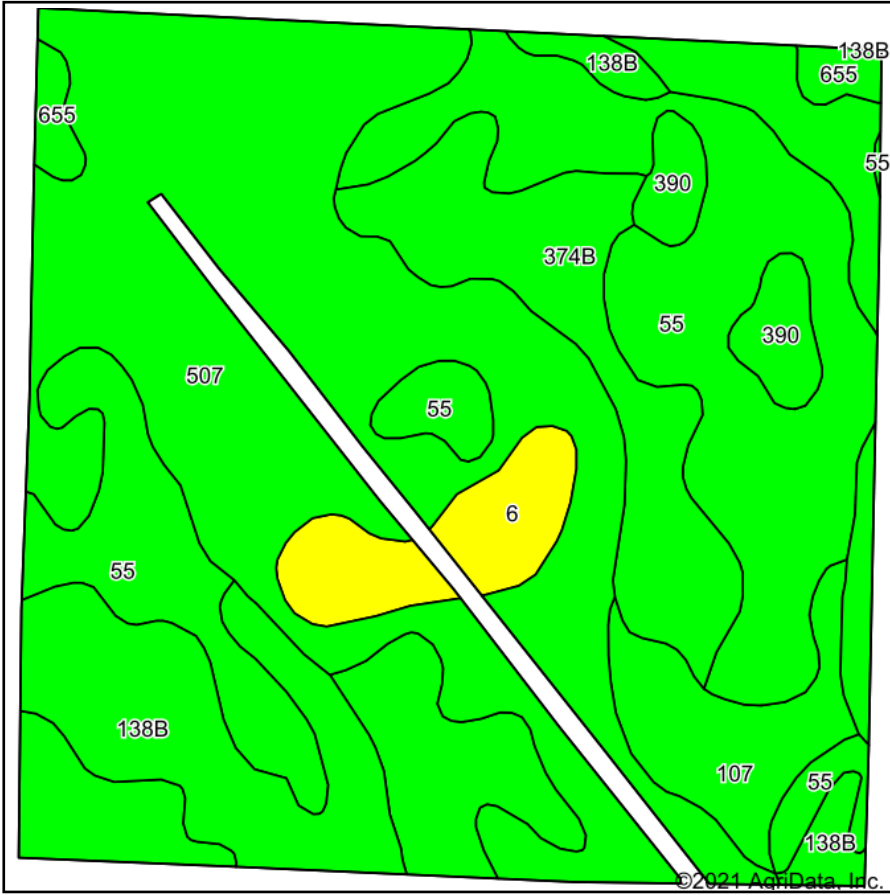

Soils data provided by USDA and NRCS.

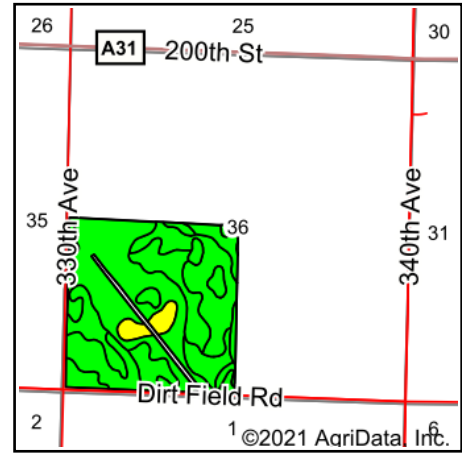

State: **Iowa**  
 County: **Dickinson**  
 Location: **36-99N-35W**  
 Township: **Richland**  
 Acres: **152.26**  
 Date: **6/22/2021**

& REAL ESTATE, INC  
**MIDWEST LAND**  
 MANAGEMENT  
 712-262-3110  
 Maps Provided By:  
  
 CUSTOMIZED ONLINE MAPPING  
 © AgriData, Inc. 2021 [www.AgriDataInc.com](http://www.AgriDataInc.com)



Area Symbol: IA059, Soil Area Version: 30

Code	Soil Description	Acres	Percent of field	CSR2 Legend	Non-Irr Class *c	CSR2**	CSR
507	Canisteo clay loam, 0 to 2 percent slopes	59.20	38.9%		IIw	84	71
55	Nicollet clay loam, 1 to 3 percent slopes	46.54	30.6%		Iw	89	73
138B	Clarion loam, 2 to 6 percent slopes	14.93	9.8%		Ile	89	73
374B	Okabena silty clay loam, 1 to 5 percent slopes	13.22	8.7%		Iw	91	73
107	Webster clay loam, 0 to 2 percent slopes	6.81	4.5%		IIw	86	70
6	Okoboji silty clay loam, 0 to 1 percent slopes	6.09	4.0%		IIIw	59	43
390	Waldorf silty clay loam, 0 to 2 percent slopes	3.50	2.3%		IIw	69	59
655	Crippin loam, 1 to 3 percent slopes	1.97	1.3%		Ile	91	71
<b>Weighted Average</b>						<b>85.5</b>	<b>70.5</b>

\*\*IA has updated the CSR values for each county to CSR2.

\*c: Using Capabilities Class Dominant Condition Aggregation Method  
 Soils data provided by USDA and NRCS.