

# Soils Map

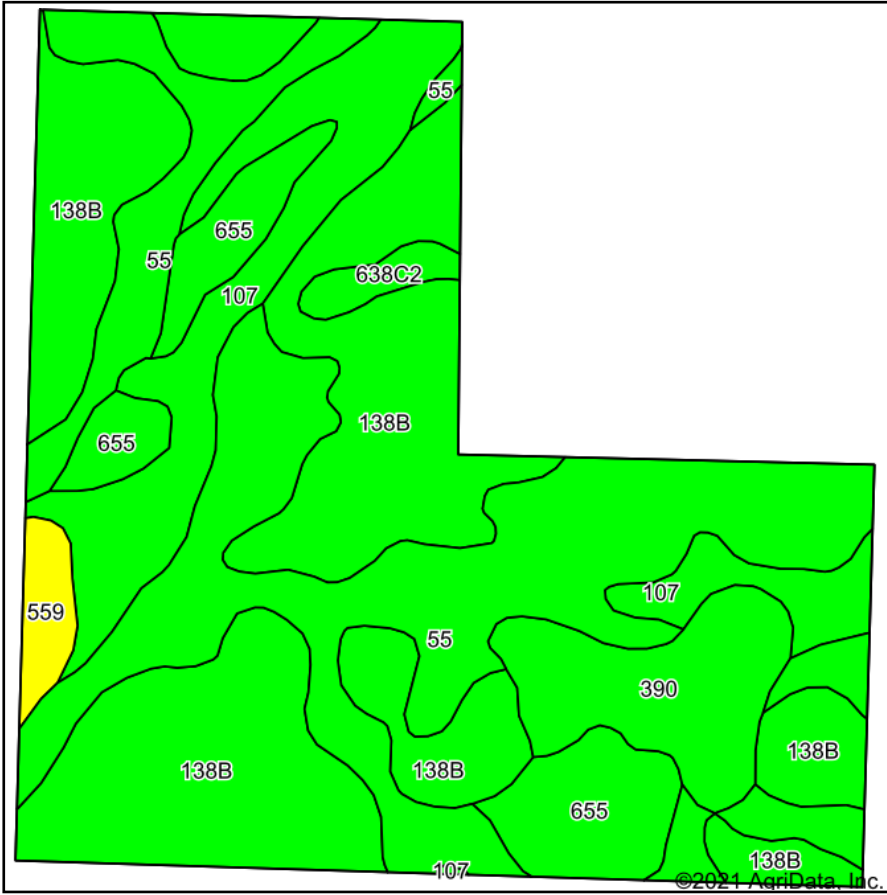

Soils data provided by USDA and NRCS.

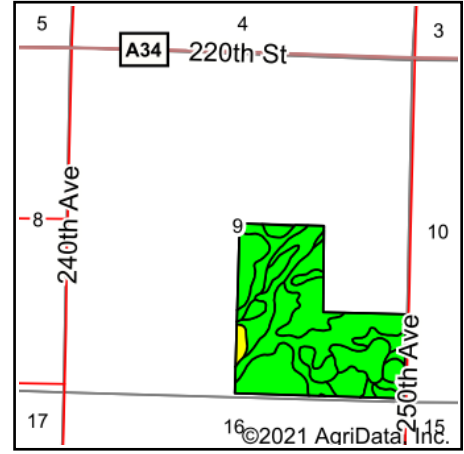

State: **Iowa**  
 County: **Dickinson**  
 Location: **9-98N-36W**  
 Township: **Milford**  
 Acres: **118**  
 Date: **8/23/2021**

& REAL ESTATE, INC  
**MIDWEST LAND**  
 712-262-3110 MANAGEMENT  
 Maps Provided By:  
  
 CUSTOMIZED ONLINE MAPPING  
 © AgriData, Inc. 2021 www.AgriDataInc.com



Area Symbol: IA059, Soil Area Version: 30

Code	Soil Description	Acres	Percent of field	CSR2 Legend	Non-Irr Class *c	CSR2**	CSR
138B	Clarion loam, 2 to 6 percent slopes	44.99	38.1%		Ile	89	73
55	Nicollet clay loam, 1 to 3 percent slopes	37.40	31.7%		Iw	89	73
107	Webster clay loam, 0 to 2 percent slopes	14.97	12.7%		Ilw	86	70
655	Crippin loam, 1 to 3 percent slopes	9.21	7.8%		Ie	91	71
390	Waldorf silty clay loam, 0 to 2 percent slopes	8.19	6.9%		Ilw	69	59
559	Talcot silty clay loam, 0 to 2 percent slopes	1.88	1.6%		Ilw	54	40
638C2	Clarion-Storden complex, 6 to 10 percent slopes, moderately eroded	1.36	1.2%		IIIe	75	52
<b>Weighted Average</b>						<b>86.7</b>	<b>70.7</b>

\*\*IA has updated the CSR values for each county to CSR2.

\*c: Using Capabilities Class Dominant Condition Aggregation Method  
 Soils data provided by USDA and NRCS.