

Soils Map

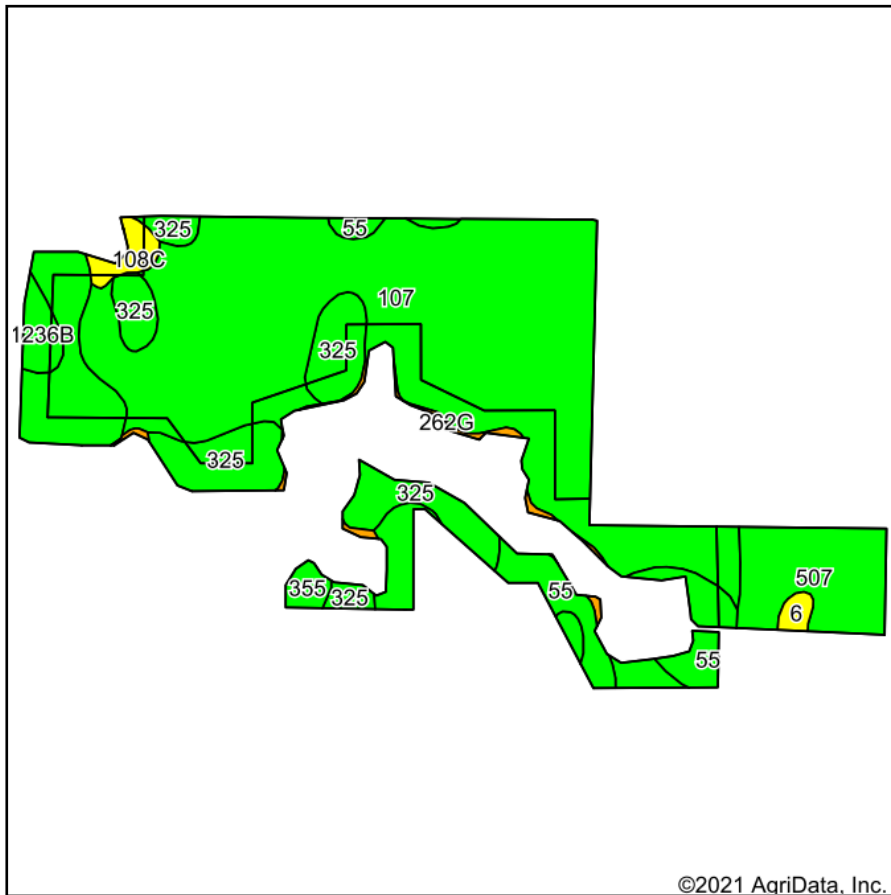

Soils data provided by USDA and NRCS.

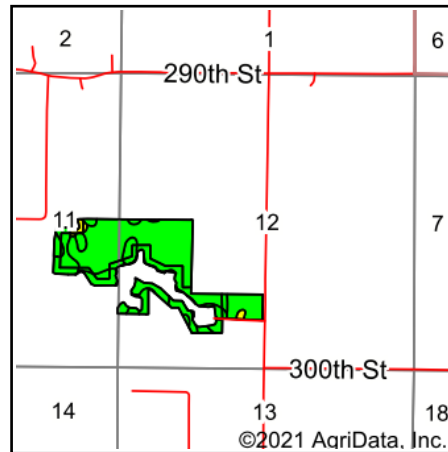

State: **Iowa**
 County: **Webster**
 Location: **12-87N-27W**
 Township: **Webster**
 Acres: **75.36**
 Date: **9/20/2021**

MIDWEST LAND & REAL ESTATE, INC
 712-262-3110 MANAGEMENT

Maps Provided By:

 CUSTOMIZED ONLINE MAPPING
 © AgriData, Inc. 2021 www.AgriDataInc.com



Area Symbol: IA187, Soil Area Version: 37

Code	Soil Description	Acres	Percent of field	CSR2 Legend	Non-Irr Class *c	CSR2**	CSR
107	Webster clay loam, 0 to 2 percent slopes	45.51	60.4%		IIw	86	82
325	Le Sueur loam, 1 to 3 percent slopes	14.93	19.8%		Iw	77	85
507	Canisteo clay loam, 0 to 2 percent slopes	6.14	8.1%		IIw	84	77
55	Nicollet clay loam, 1 to 3 percent slopes	4.69	6.2%		Iw	89	90
1236B	Angus loam, 2 to 6 percent slopes	1.20	1.6%		Ile	85	77
108C	Wadena loam, 6 to 12 percent slopes	1.00	1.3%		IIIe	47	27
262G	Lester-Belview complex, 22 to 40 percent slopes	0.73	1.0%		VIIe	9	11
355	Luther loam, 1 to 3 percent slopes	0.70	0.9%		Ie	80	73
6	Okoboji silty clay loam, 0 to 1 percent slopes	0.46	0.6%		IIIw	59	62
Weighted Average						82.7	81

**IA has updated the CSR values for each county to CSR2.
 *c: Using Capabilities Class Dominant Condition Aggregation Method
 Soils data provided by USDA and NRCS.