

Soils Map

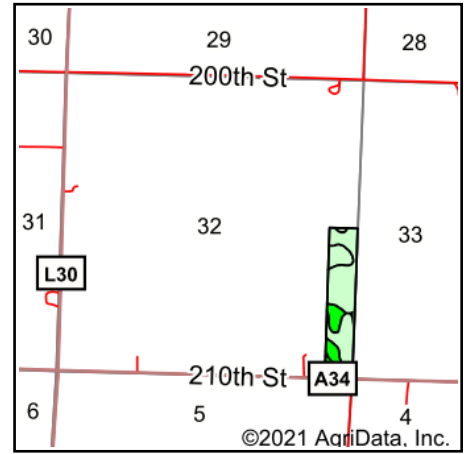

©2021 AgriData, Inc.

Soils data provided by USDA and NRCS.



©2021 AgriData, Inc.

State: **Iowa**
 County: **Osceola**
 Location: **32-99N-42W**
 Township: **Holman**
 Acres: **30.46**
 Date: **9/20/2021**

MIDWEST LAND & REAL ESTATE, INC
 712-262-3110 MANAGEMENT

Maps Provided By:



© AgriData, Inc. 2021

www.AgriDataInc.com



Area Symbol: IA143, Soil Area Version: 31

Code	Soil Description	Acres	Percent of field	CSR2 Legend	Non-Irr Class *c	CSR2**	CSR
77	Sac silty clay loam, loam substratum, 0 to 2 percent slopes	12.97	42.6%		I	100	82
91	Primghar silty clay loam, 0 to 2 percent slopes	10.17	33.4%		Iw	100	86
32	Spicer silty clay loam, 0 to 2 percent slopes	3.32	10.9%		IIw	94	76
310B	Galva silty clay loam, 2 to 5 percent slopes	2.55	8.4%		IIe	95	81
77B	Sac silty clay loam, loam substratum, 2 to 5 percent slopes	1.45	4.8%		IIe	95	77
Weighted Average						98.7	82.4

**IA has updated the CSR values for each county to CSR2.

*c: Using Capabilities Class Dominant Condition Aggregation Method

Soils data provided by USDA and NRCS.