

# Soils Map

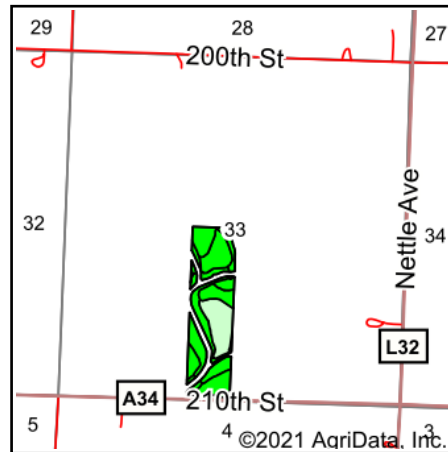

Soils data provided by USDA and NRCS.



State: **Iowa**  
 County: **Osceola**  
 Location: **33-99N-42W**  
 Township: **Holman**  
 Acres: **34.93**  
 Date: **9/20/2021**

MIDWEST LAND & REAL ESTATE, INC  
 712-262-3110 MANAGEMENT

Maps Provided By:  
  
 CUSTOMIZED ONLINE MAPPING  
 © AgriData, Inc. 2021 www.AgriDataInc.com



Area Symbol: IA143, Soil Area Version: 31

Code	Soil Description	Acres	Percent of field	CSR2 Legend	Non-Irr Class *c	CSR2**	CSR
P10	Afton silty clay loam, Sheldon creek formation, 0 to 2 percent slopes, occasionally flooded	9.15	26.2%		IIw	82	
91	Primghar silty clay loam, 0 to 2 percent slopes	6.93	19.8%		Iw	100	86
577B	Everly clay loam, 2 to 5 percent slopes	4.45	12.7%		IIe	90	72
77B	Sac silty clay loam, loam substratum, 2 to 5 percent slopes	4.12	11.8%		IIe	95	77
311B	Galva silty clay loam, stratified substratum, 2 to 5 percent slopes	3.39	9.7%		IIe	91	81
310B	Galva silty clay loam, 2 to 5 percent slopes	2.89	8.3%		IIe	95	81
92	Marcus silty clay loam, 0 to 2 percent slopes	2.38	6.8%		IIw	94	80
577C	Everly clay loam, 5 to 9 percent slopes	0.99	2.8%		IIIe	84	65
735	Havelock loam, 0 to 2 percent slopes, occasionally flooded	0.63	1.8%		IIw	74	57
<b>Weighted Average</b>						<b>90.8</b>	<b>*-</b>

\*\*IA has updated the CSR values for each county to CSR2.

\*- CSR weighted average cannot be calculated on the current soils data, use prior data version for csr values.

\*c: Using Capabilities Class Dominant Condition Aggregation Method

Soils data provided by USDA and NRCS.