

# Soils Map

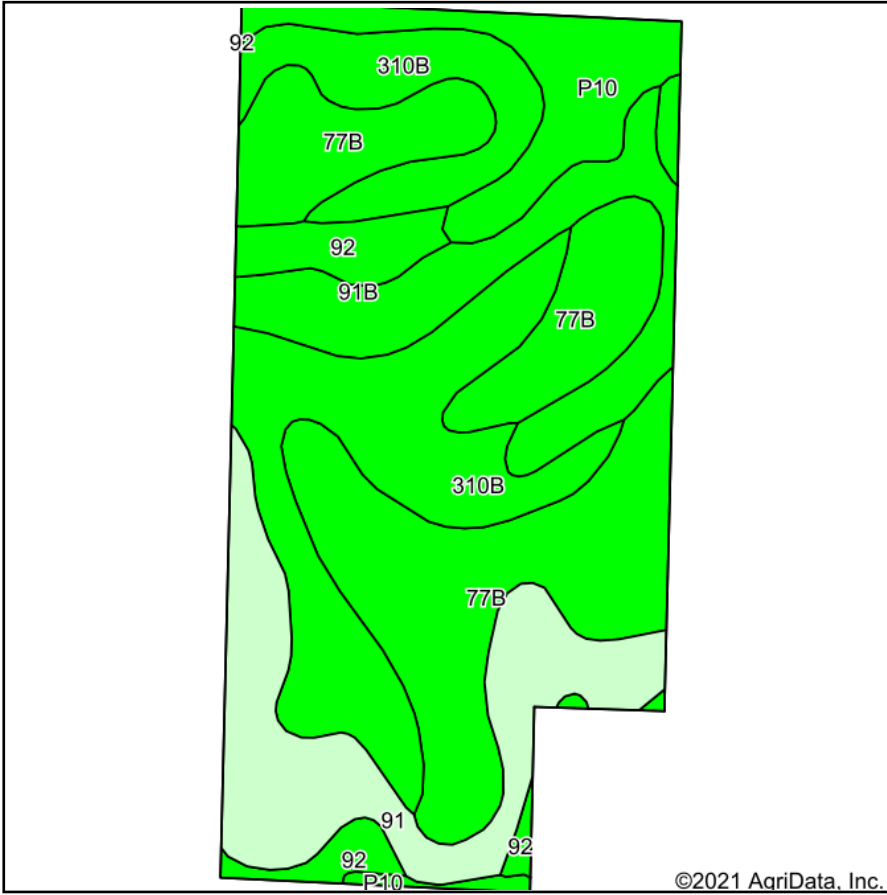

Soils data provided by USDA and NRCS.

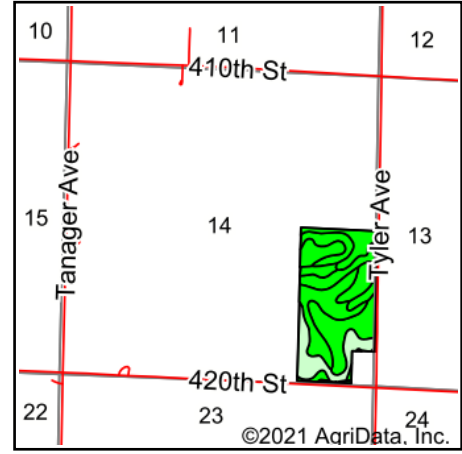

State: **Iowa**  
 County: **Obrien**  
 Location: **14-95N-40W**  
 Township: **Highland**  
 Acres: **73.24**  
 Date: **9/7/2021**

& REAL ESTATE, INC  
**MIDWEST LAND**  
 712-262-3110 MANAGEMENT  
 Maps Provided By:  
  
 CUSTOMIZED ONLINE MAPPING  
 © AgriData, Inc. 2021 www.AgriDataInc.com



Area Symbol: IA141, Soil Area Version: 25

| Code                    | Soil Description  | Acres | Percent of field | CSR2 Legend | Non-Irr Class *c | CSR2**      | CSR       |
|-------------------------|---|-------|------------------|-------------|------------------|-------------|-----------|
| 77B                     | Sac silty clay loam, loam substratum, 2 to 5 percent slopes                                 | 23.90 | 32.6%            |             | Ile              | 95          | 68        |
| 310B                    | Galva silty clay loam, 2 to 5 percent slopes  | 19.57 | 26.7%            |             | Ile              | 95          | 70        |
| 91                      | Primghar silty clay loam, 0 to 2 percent slopes   | 11.59 | 15.8%            |             | Iw               | 100         | 80        |
| 91B                     | Primghar silty clay loam, 2 to 5 percent slopes   | 8.10  | 11.1%            |             | Ile              | 95          | 78        |
| P10                     | Afton silty clay loam, Sheldon creek formation, 0 to 2 percent slopes, occasionally flooded | 6.40  | 8.7%             |             | Ilw              | 82          |           |
| 92                      | Marcus silty clay loam, 0 to 2 percent slopes   | 3.68  | 5.0%             |             | Ilw              | 94          | 75        |
| <b>Weighted Average</b> |   |       |                  |             |                  | <b>94.6</b> | <b>*-</b> |

\*\*IA has updated the CSR values for each county to CSR2.

\*- CSR weighted average cannot be calculated on the current soils data, use prior data version for csr values.

\*c: Using Capabilities Class Dominant Condition Aggregation Method

Soils data provided by USDA and NRCS.