

# Soils Map

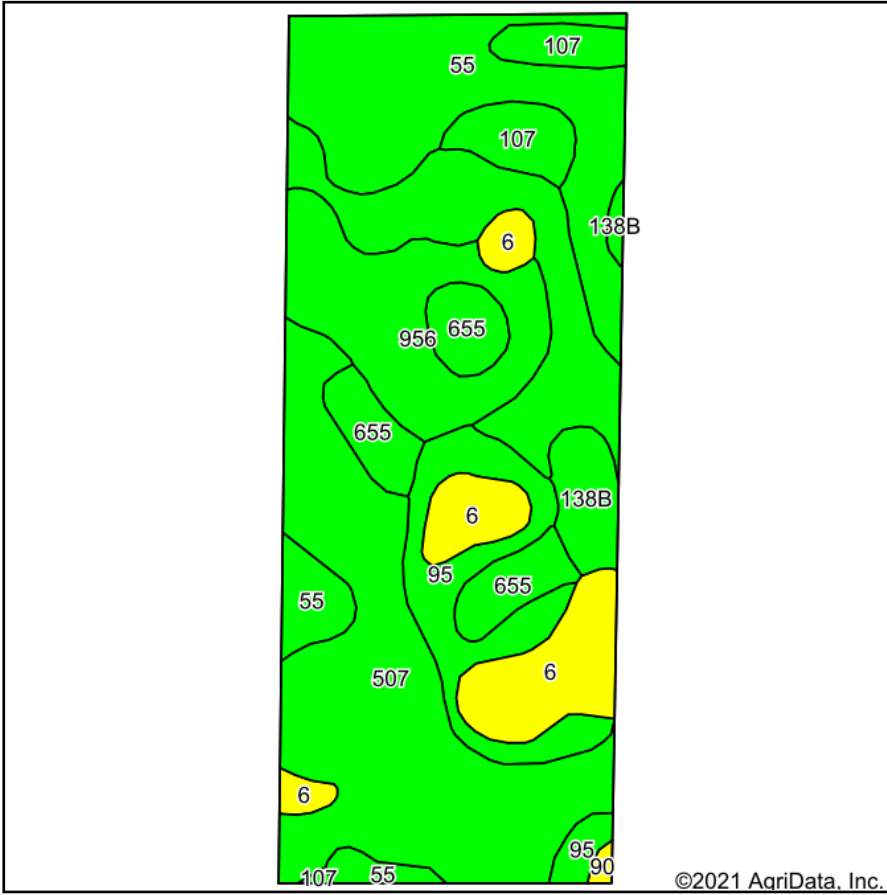

Soils data provided by USDA and NRCS.

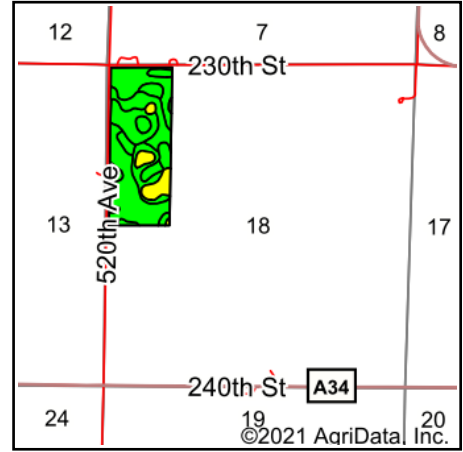

State: **Iowa**  
 County: **Emmet**  
 Location: **18-98N-31W**  
 Township: **Denmark**  
 Acres: **59.03**  
 Date: **9/21/2021**

& REAL ESTATE, INC  
**MIDWEST LAND**  
 712-262-3110 MANAGEMENT  
 Maps Provided By:  
  
 CUSTOMIZED ONLINE MAPPING  
 © AgriData, Inc. 2021 www.AgriDataInc.com



Area Symbol: IA063, Soil Area Version: 30

Code	Soil Description	Acres	Percent of field	CSR2 Legend	Non-Irr Class *c	CSR2**	CSR
507	Canisteo clay loam, 0 to 2 percent slopes	21.86	37.0%		IIw	84	73
55	Nicollet clay loam, 1 to 3 percent slopes	11.07	18.8%		Iw	89	82
956	Harps-Okobojo complex, 0 to 2 percent slopes	6.73	11.4%		IIw	69	54
6	Okobojo silty clay loam, 0 to 1 percent slopes	5.51	9.3%		IIIw	59	53
95	Harps clay loam, 0 to 2 percent slopes	5.27	8.9%		IIw	72	57
655	Crippin loam, 1 to 3 percent slopes	3.95	6.7%		Ie	91	77
107	Webster clay loam, 0 to 2 percent slopes	2.63	4.5%		IIw	86	77
138B	Clarion loam, 2 to 6 percent slopes	1.86	3.2%		Ile	89	74
90	Okobojo mucky silt loam, 0 to 1 percent slopes	0.15	0.3%		IIIw	55	54
<b>Weighted Average</b>						<b>80.5</b>	<b>69.7</b>

\*\*IA has updated the CSR values for each county to CSR2.

\*c: Using Capabilities Class Dominant Condition Aggregation Method

Soils data provided by USDA and NRCS.