

# Soils Map

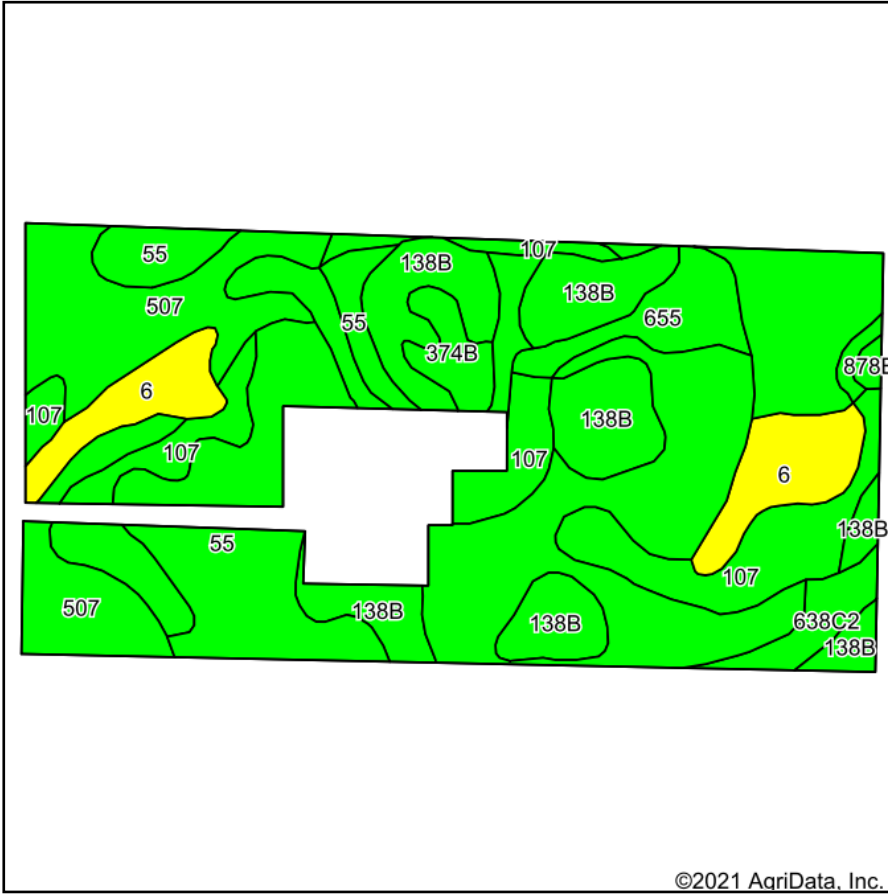

©2021 AgriData, Inc.

Soils data provided by USDA and NRCS.

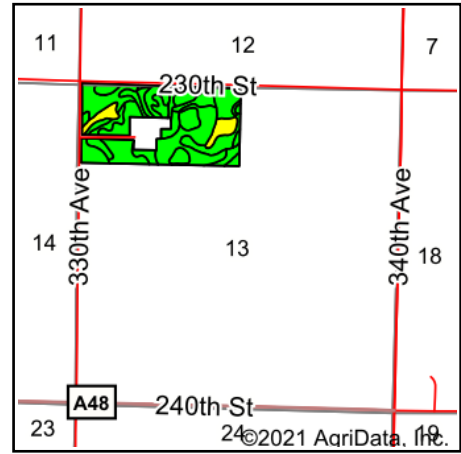

State: **Iowa**  
 County: **Dickinson**  
 Location: **13-98N-35W**  
 Township: **Lloyd**  
 Acres: **69.43**  
 Date: **9/28/2021**

**MIDWEST LAND** & REAL ESTATE, INC  
 712-262-3110 MANAGEMENT

Maps Provided By:



© AgriData, Inc. 2021

www.AgriDataInc.com



Area Symbol: IA059, Soil Area Version: 30

Code	Soil Description	Acres	Percent of field	CSR2 Legend	Non-Irr Class *c	CSR2**	CSR
55	Nicollet clay loam, 1 to 3 percent slopes	22.69	32.7%		Iw	89	73
507	Canisteo clay loam, 0 to 2 percent slopes	13.84	19.9%		Ilw	84	71
107	Webster clay loam, 0 to 2 percent slopes	11.22	16.2%		Ilw	86	70
138B	Clarion loam, 2 to 6 percent slopes	11.15	16.1%		Ile	89	73
6	Okoboji silty clay loam, 0 to 1 percent slopes	5.08	7.3%		Illw	59	43
655	Crippin loam, 1 to 3 percent slopes	2.43	3.5%		Ie	91	71
638C2	Clarion-Storden complex, 6 to 10 percent slopes, moderately eroded	1.43	2.1%		Illle	75	52
374B	Okabena silty clay loam, 1 to 5 percent slopes	1.36	2.0%		Iw	91	73
878B	Ocheyedan loam, 2 to 5 percent slopes	0.23	0.3%		Ile	92	74
<b>Weighted Average</b>						<b>85.2</b>	<b>69.4</b>

\*\*IA has updated the CSR values for each county to CSR2.

\*c: Using Capabilities Class Dominant Condition Aggregation Method

Soils data provided by USDA and NRCS.