

Soils Map

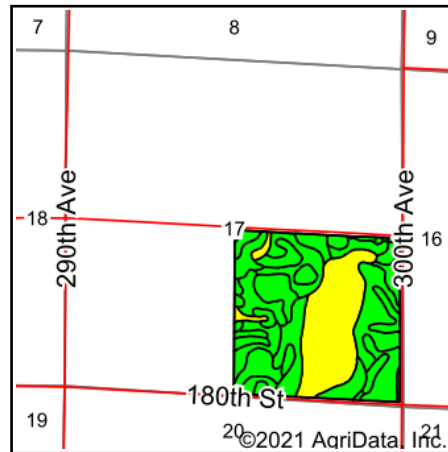
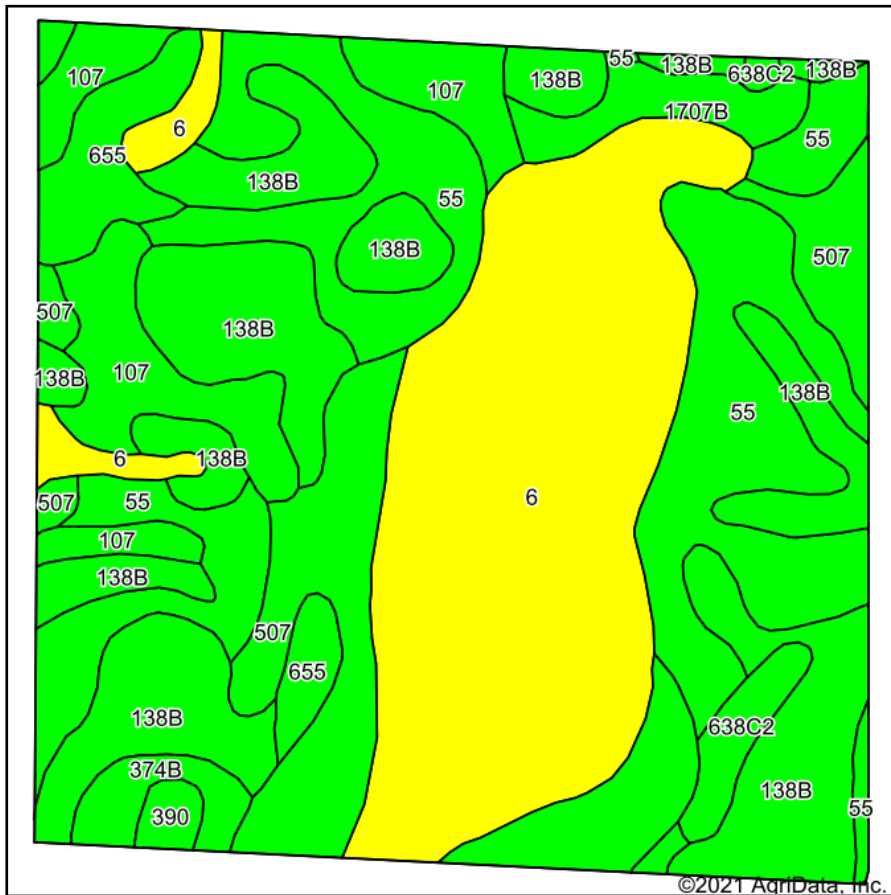

State: **Iowa**
 County: **Dickinson**
 Location: **17-99N-35W**
 Township: **Richland**
 Acres: **152.93**
 Date: **10/12/2021**

& REAL ESTATE, INC
MIDWEST LAND
 712-262-3110 MANAGEMENT
 Maps Provided By:

 CUSTOMIZED ONLINE MAPPING
 © AgriData, Inc. 2021 www.AgriDataInc.com



Soils data provided by USDA and NRCS.

Area Symbol: IA059, Soil Area Version: 30

Code	Soil Description	Acres	Percent of field	CSR2 Legend	Non-Irr Class *c	CSR2**	CSR	
6	Okoboji silty clay loam, 0 to 1 percent slopes	42.27	27.6%		IIIw	59	43	
138B	Clarion loam, 2 to 6 percent slopes	33.80	22.1%		Ile	89	73	
55	Nicollet clay loam, 1 to 3 percent slopes	32.65	21.3%		Iw	89	73	
507	Canisteo clay loam, 0 to 2 percent slopes	18.08	11.8%		IIw	84	71	
107	Webster clay loam, 0 to 2 percent slopes	11.87	7.8%		IIw	86	70	
655	Crippin loam, 1 to 3 percent slopes	5.48	3.6%		Ie	91	71	
1707B	Delft-Terril complex, 1 to 5 percent slopes	3.30	2.2%		IIw	78	59	
638C2	Clarion-Storden complex, 6 to 10 percent slopes, moderately eroded	2.35	1.5%		IIIe	75	52	
374B	Okabena silty clay loam, 1 to 5 percent slopes	2.25	1.5%		Iw	91	73	
390	Waldorf silty clay loam, 0 to 2 percent slopes	0.88	0.6%		IIw	69	59	
Weighted Average						2.03	79.4	63.5

**IA has updated the CSR values for each county to CSR2.

*c: Using Capabilities Class Dominant Condition Aggregation Method
 Soils data provided by USDA and NRCS.