

Soils Map

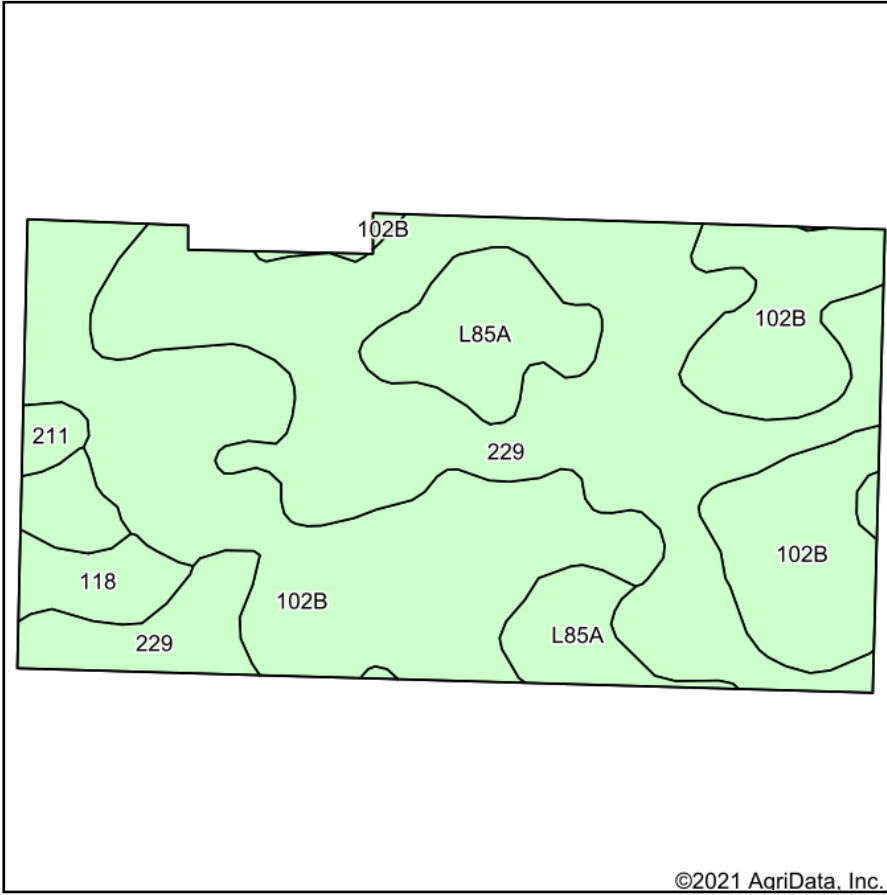

Soils data provided by USDA and NRCS.

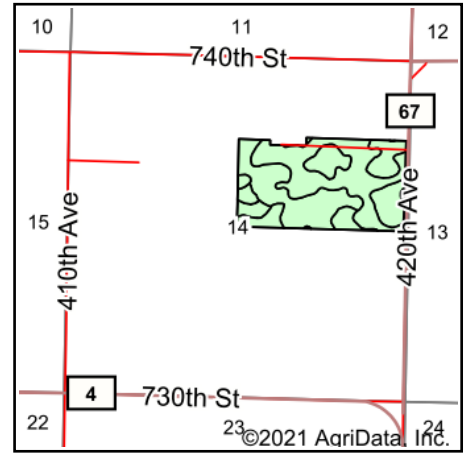

State: **Minnesota**
 County: **Jackson**
 Location: **14-101N-37W**
 Township: **Sioux Valley**
 Acres: **81.56**
 Date: **10/22/2021**

MIDWEST LAND & REAL ESTATE, INC
 712-262-3110 MANAGEMENT

Maps Provided By:

 CUSTOMIZED ONLINE MAPPING
 © AgriData, Inc. 2021 www.AgriDataInc.com



Area Symbol: MN063, Soil Area Version: 17

Code	Soil Description	Acres	Percent of field	Non-Irr Class *c	Productivity Index
229	Waldorf silty clay loam, 0 to 2 percent slopes	35.51	43.5%	IIw	85
102B	Clarion loam, 2 to 6 percent slopes	34.96	42.9%	Ile	95
L85A	Nicollet clay loam, 1 to 3 percent slopes	7.93	9.7%	Iw	99
118	Crippin loam, 1 to 3 percent slopes	2.38	2.9%	Ie	100
211	Lura silty clay, 0 to 1 percent slopes	0.78	1.0%	IIIw	81
Weighted Average				1.88	91

*c: Using Capabilities Class Dominant Condition Aggregation Method
 Soils data provided by USDA and NRCS.