

# Soils Map

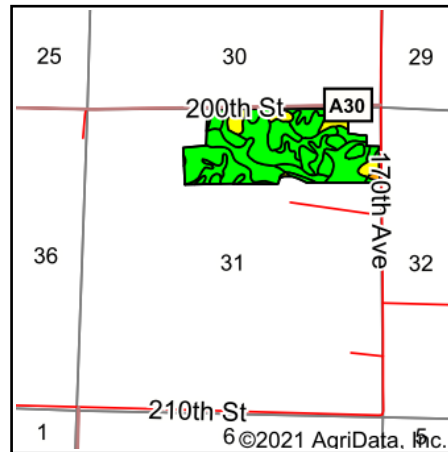
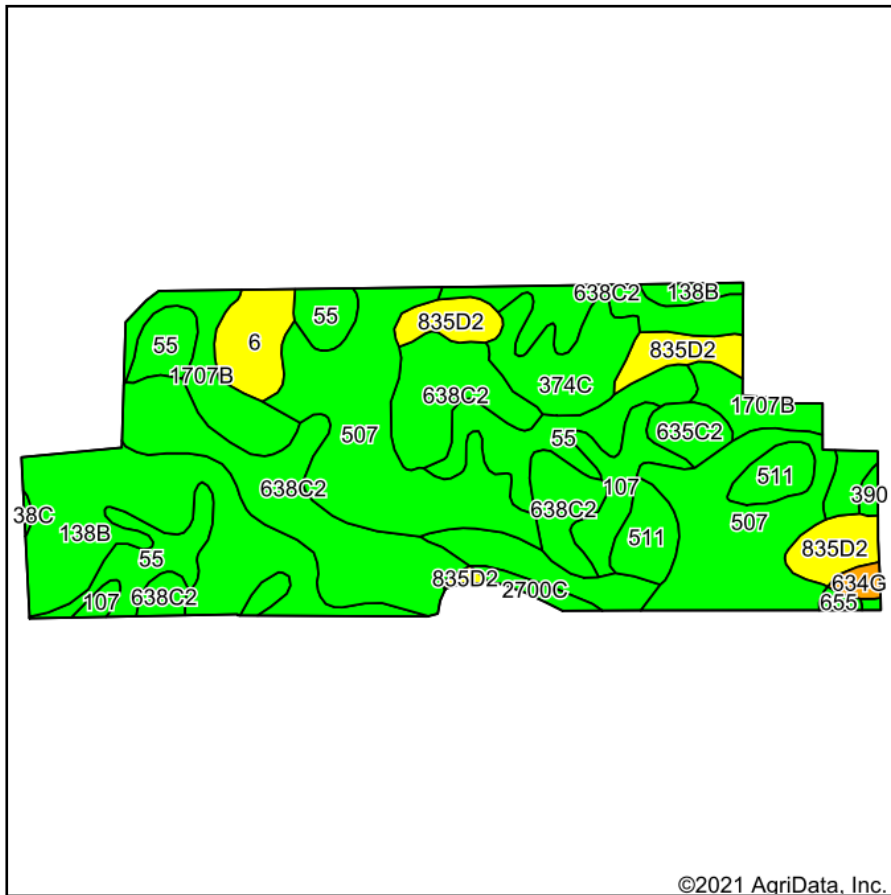

State: **Iowa**  
 County: **Dickinson**  
 Location: **31-99N-37W**  
 Township: **Lakeville**  
 Acres: **90.99**  
 Date: **11/8/2021**

**MIDWEST LAND** & REAL ESTATE, INC  
 712-262-3110 MANAGEMENT

Maps Provided By:  
  
 CUSTOMIZED ONLINE MAPPING  
 © AgriData, Inc. 2021 www.AgriDataInc.com



Soils data provided by USDA and NRCS.

©2021 AgriData, Inc.

Area Symbol: IA059, Soil Area Version: 31

Code	Soil Description	Acres	Percent of field	CSR2 Legend	Non-Irr Class *c	CSR2**	CSR	
638C2	Clarion-Storden complex, 6 to 10 percent slopes, moderately eroded	20.46	22.5%		IIIe	75	52	
507	Canisteo clay loam, 0 to 2 percent slopes	19.09	21.0%		IIw	84	71	
138B	Clarion loam, 2 to 6 percent slopes	12.39	13.6%		Ile	89	73	
55	Nicollet clay loam, 1 to 3 percent slopes	10.18	11.2%		Iw	89	73	
1707B	Delft-Terril complex, 1 to 5 percent slopes	7.90	8.7%		IIw	78	59	
835D2	Omsrud-Storden complex, 10 to 16 percent slopes, moderately eroded	5.02	5.5%		IVe	53	35	
374C	Okabena silty clay loam, 5 to 9 percent slopes	4.00	4.4%		IIIe	86	69	
511	Blue Earth mucky silt loam, 0 to 1 percent slopes	3.24	3.6%		IIlw	66	49	
107	Webster clay loam, 0 to 2 percent slopes	2.89	3.2%		IIw	86	70	
6	Okoboji silty clay loam, 0 to 1 percent slopes	2.58	2.8%		IIIw	59	43	
635C2	Belview-Storden complex, 5 to 9 percent slopes, moderately eroded	1.42	1.6%		IIIe	66	18	
2700C	Ridgeton loam, 5 to 9 percent slopes	0.66	0.7%		IVe	84	66	
634G	Belview-Omsrud complex, 18 to 40 percent slopes	0.51	0.6%		VIe	8	6	
390	Waldorf silty clay loam, 0 to 2 percent slopes	0.30	0.3%		IIw	69	59	
655	Crippin loam, 1 to 3 percent slopes	0.26	0.3%		Ie	91	71	
138C	Clarion loam, 6 to 10 percent slopes	0.09	0.1%		IIIe	84	67	
<b>Weighted Average</b>						<b>2.38</b>	<b>79.1</b>	<b>61.2</b>

\*\*IA has updated the CSR values for each county to CSR2.  
 \*c: Using Capabilities Class Dominant Condition Aggregation Method  
 Soils data provided by USDA and NRCS.