

Soils Map

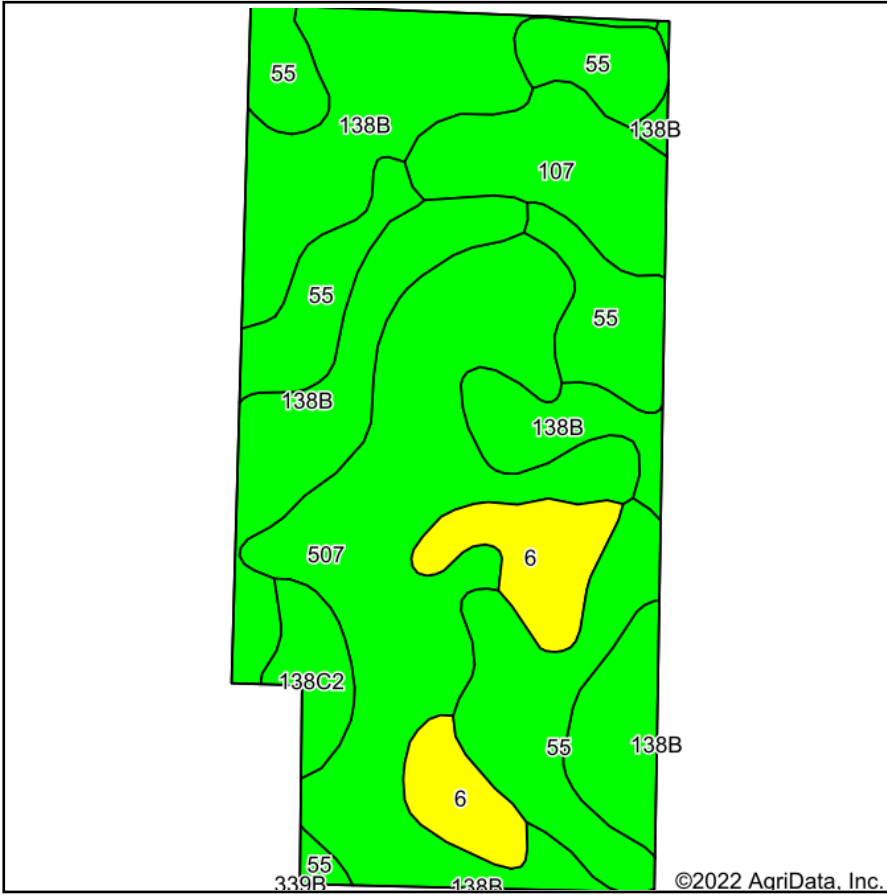

Soils data provided by USDA and NRCS.

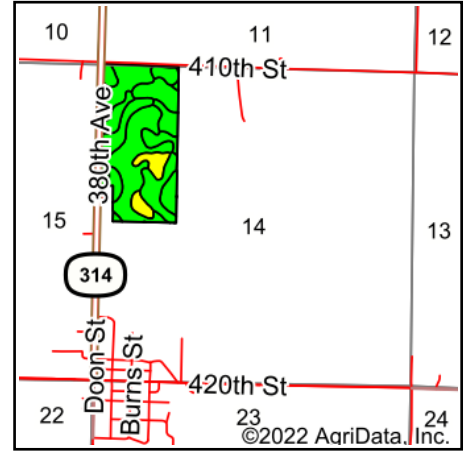

State: **Iowa**
 County: **Palo Alto**
 Location: **14-95N-34W**
 Township: **Silver Lake**
 Acres: **73.6**
 Date: **5/20/2022**

712-262-3110
MIDWEST LAND & REAL ESTATE, INC.
 MANAGEMENT
 Maps Provided By:

 CUSTOMIZED ONLINE MAPPING
 © AgriData, Inc. 2021 www.AgriDataInc.com



Area Symbol: IA147, Soil Area Version: 28

Code	Soil Description	Acres	Percent of field	CSR2 Legend	CSR2**	CSR
507	Canisteo clay loam, 0 to 2 percent slopes	23.67	32.2%		84	74
138B	Clarion loam, 2 to 6 percent slopes	18.66	25.4%		89	76
55	Nicollet clay loam, 1 to 3 percent slopes	17.53	23.8%		89	84
107	Webster clay loam, 0 to 2 percent slopes	5.91	8.0%		86	79
6	Okoboji silty clay loam, 0 to 1 percent slopes	5.70	7.7%		59	54
138C2	Clarion loam, 6 to 10 percent slopes, moderately eroded	2.13	2.9%		83	58
Weighted Average					84.7	75.3

**IA has updated the CSR values for each county to CSR2.
 Soils data provided by USDA and NRCS.