

Soils Map

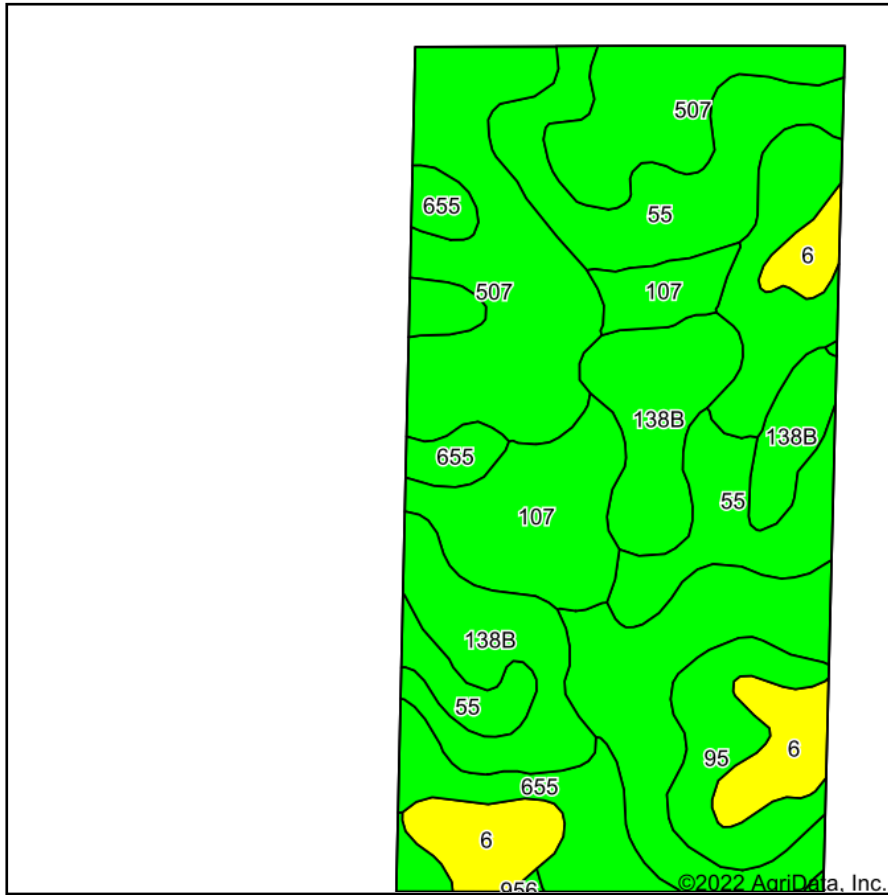

Soils data provided by USDA and NRCS.

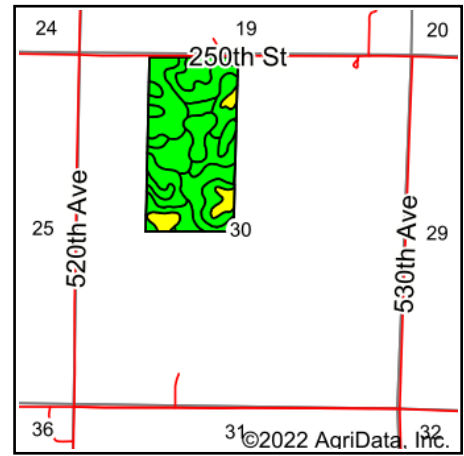

State: **Iowa**
 County: **Emmet**
 Location: **30-98N-31W**
 Township: **Denmark**
 Acres: **78.91**
 Date: **8/11/2022**

& REAL ESTATE, INC
MIDWEST LAND
 712-262-3110 MANAGEMENT
 Maps Provided By:

 CUSTOMIZED ONLINE MAPPING
 © AgriData, Inc. 2021 www.AgriDataInc.com



Area Symbol: IA063, Soil Area Version: 31

Code	Soil Description	Acres	Percent of field	CSR2 Legend	CSR2**	CSR
507	Canisteo clay loam, 0 to 2 percent slopes	29.19	37.0%		84	73
55	Nicollet clay loam, 1 to 3 percent slopes	13.17	16.7%		89	82
138B	Clarion loam, 2 to 6 percent slopes	12.15	15.4%		89	74
107	Webster clay loam, 0 to 2 percent slopes	7.68	9.7%		86	77
655	Crippin loam, 1 to 3 percent slopes	6.56	8.3%		91	77
6	Okoboji silty clay loam, 0 to 1 percent slopes	5.87	7.4%		59	53
95	Harps clay loam, 0 to 2 percent slopes	4.29	5.4%		72	57
Weighted Average					83.9	73

**IA has updated the CSR values for each county to CSR2.
 Soils data provided by USDA and NRCS.