

Soils Map

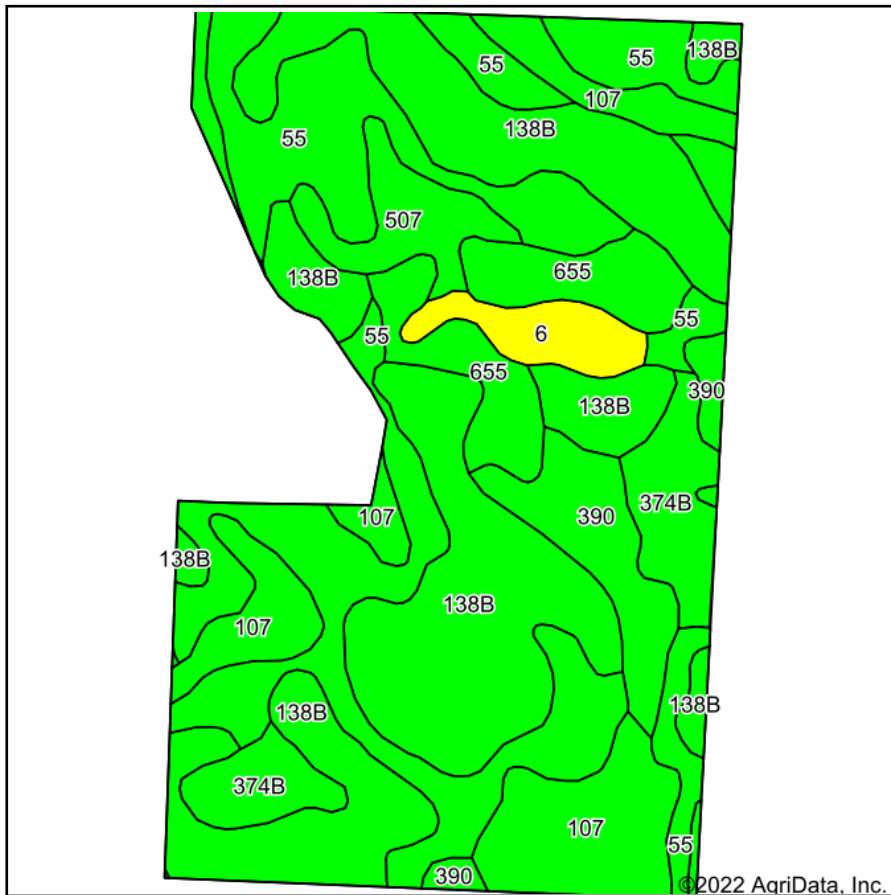

Soils data provided by USDA and NRCS.

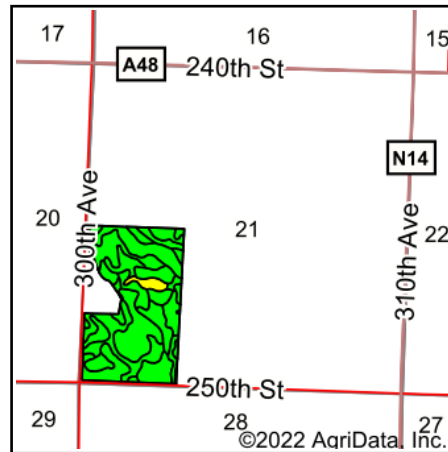

State: **Iowa**
 County: **Dickinson**
 Location: **21-98N-35W**
 Township: **Lloyd**
 Acres: **83.21**
 Date: **11/15/2022**

MIDWEST LAND & REAL ESTATE, INC
 712-262-3110 MANAGEMENT

Maps Provided By:

 CUSTOMIZED ONLINE MAPPING
 © AgriData, Inc. 2021 www.AgriDataInc.com



Area Symbol: IA059, Soil Area Version: 32

Code	Soil Description	Acres	Percent of field	CSR2 Legend	CSR2**	CSR
138B	Clarion loam, 2 to 6 percent slopes	28.89	34.7%		89	73
55	Nicollet clay loam, 1 to 3 percent slopes	23.39	28.1%		89	73
107	Webster clay loam, 0 to 2 percent slopes	10.19	12.2%		86	70
655	Crippin loam, 1 to 3 percent slopes	5.72	6.9%		91	71
374B	Okabena silty clay loam, 1 to 5 percent slopes	4.94	5.9%		91	73
390	Waldorf silty clay loam, 0 to 2 percent slopes	4.88	5.9%		69	59
507	Canisteo clay loam, 0 to 2 percent slopes	2.93	3.5%		84	71
6	Okoboji silty clay loam, 0 to 1 percent slopes	2.27	2.7%		59	43
Weighted Average					86.7	70.8

**IA has updated the CSR values for each county to CSR2.
 Soils data provided by USDA and NRCS.