

# Soils Map

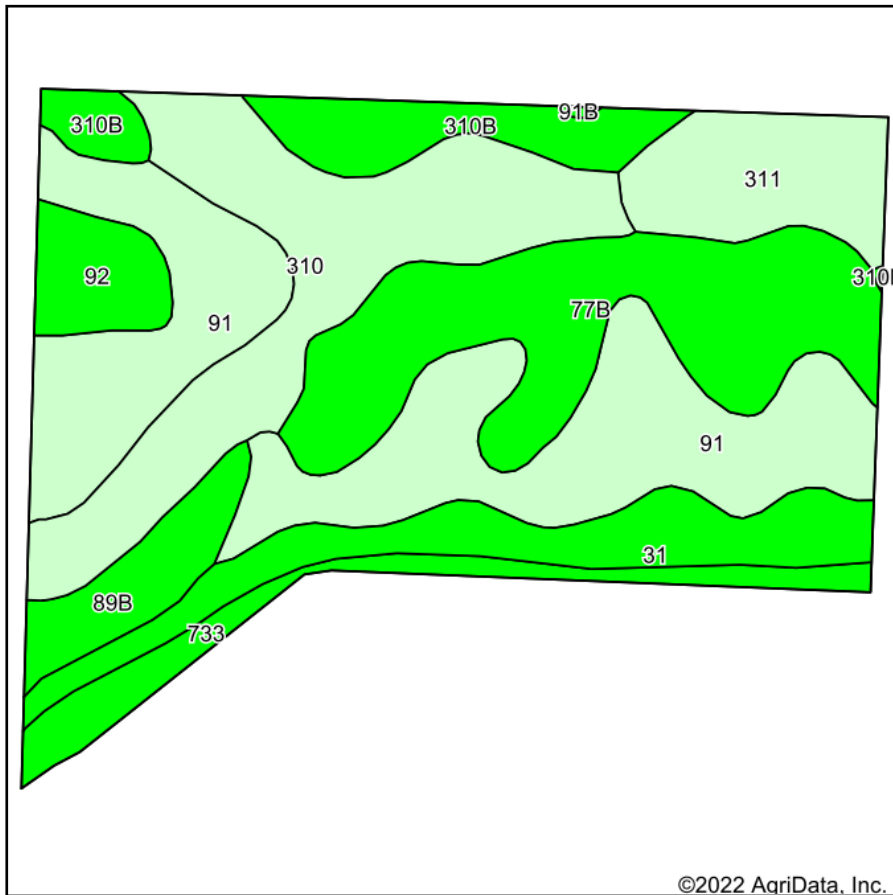

Soils data provided by USDA and NRCS.

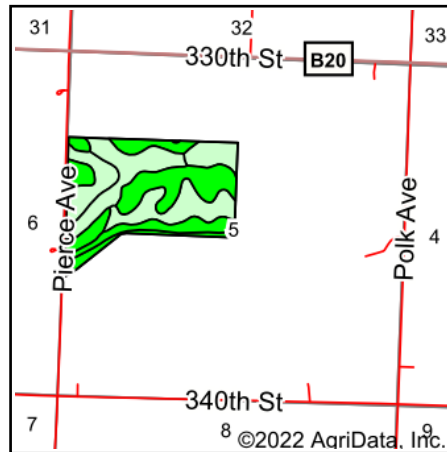

State: **Iowa**  
 County: **O'Brien**  
 Location: **5-96N-41W**  
 Township: **Summit**  
 Acres: **95.38**  
 Date: **12/8/2022**

**MIDWEST LAND** & REAL ESTATE, INC  
 712-262-3110 **MANAGEMENT**

Maps Provided By:  
  
 CUSTOMIZED ONLINE MAPPING  
 © AgriData, Inc. 2021 www.AgriDataInc.com



Archived Soils Ending 11/06/2022 Area Symbol: IA141, Soil Area Version: 26

Code	Soil Description	Acres	Percent of field	CSR2 Legend	CSR2**	CSR
91	Primghar silty clay loam, 0 to 2 percent slopes	26.37	27.6%		100	80
77B	Sac silty clay loam, loam substratum, 2 to 5 percent slopes	17.40	18.2%		95	68
310	Galva silty clay loam, 0 to 2 percent slopes	17.33	18.2%		100	75
31	Afton silty clay loam, 0 to 2 percent slopes, occasionally flooded	8.90	9.3%		80	72
311	Galva silty clay loam, stratified substratum, 0 to 2 percent slopes	6.81	7.1%		100	74
310B	Galva silty clay loam, 2 to 5 percent slopes	6.25	6.6%		95	70
733	Calco silty clay loam, 0 to 2 percent slopes, occasionally flooded	4.92	5.2%		78	68
89B	Sac variant silty clay loam, 2 to 5 percent slopes	4.05	4.2%		95	68
92	Marcus silty clay loam, 0 to 2 percent slopes	3.28	3.4%		94	75
91B	Primghar silty clay loam, 2 to 5 percent slopes	0.07	0.1%		95	78
<b>Weighted Average</b>					<b>95.3</b>	<b>73.8</b>

\*\*IA has updated the CSR values for each county to CSR2.  
 Soils data provided by USDA and NRCS.