

# Soils Map

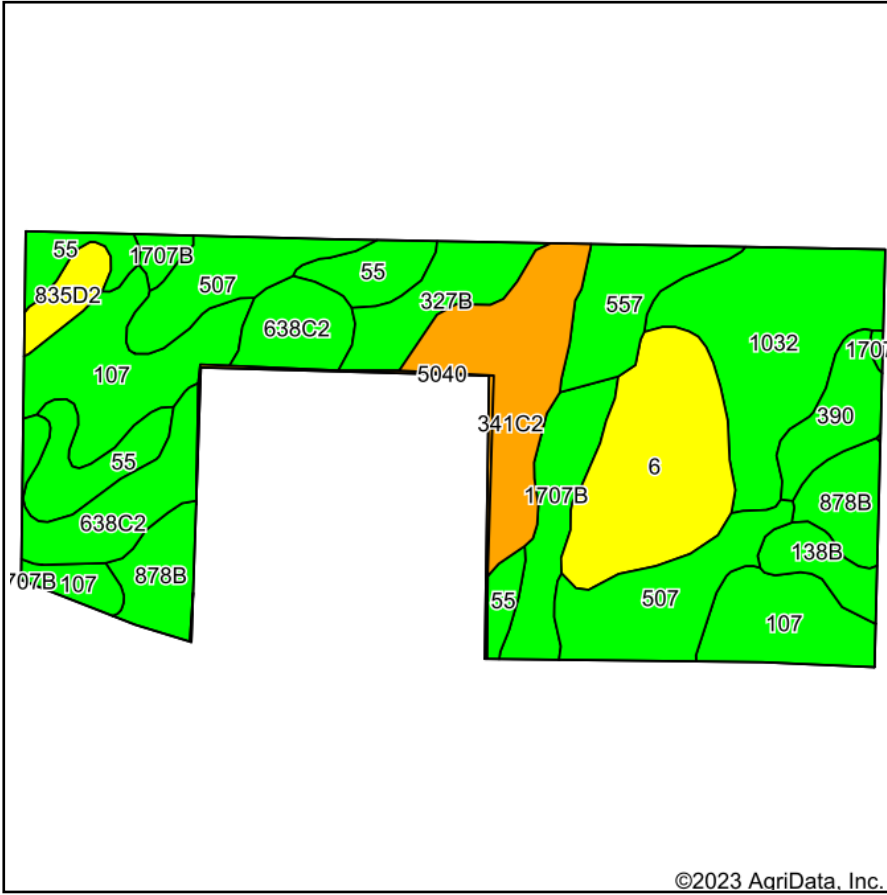

©2023 AgriData, Inc.

Soils data provided by USDA and NRCS.

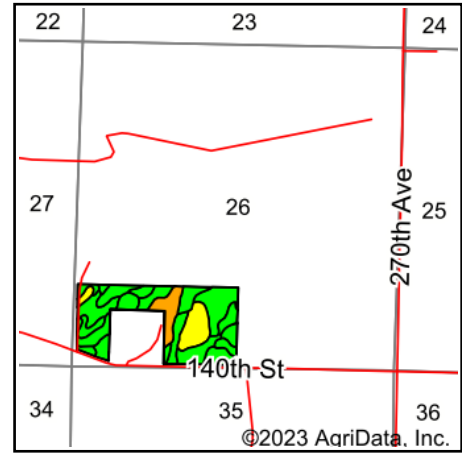

©2023 AgriData, Inc.

State: **Iowa**  
 County: **Dickinson**  
 Location: **26-100N-36W**  
 Township: **Spirit Lake**  
 Acres: **57.77**  
 Date: **8/4/2023**

**MIDWEST LAND** & REAL ESTATE, INC  
 712-262-3110 MANAGEMENT

Maps Provided By:



© AgriData, Inc. 2023

www.AgriDataInc.com



Area Symbol: IA059, Soil Area Version: 32

Code	Soil Description	Acres	Percent of field	CSR2 Legend	CSR2**	CSR
107	Webster clay loam, 0 to 2 percent slopes	7.96	13.8%		86	70
1032	Spicer silty clay loam, 0 to 2 percent slopes	6.85	11.9%		91	74
6	Okoboji silty clay loam, 0 to 1 percent slopes	6.42	11.1%		59	43
507	Canisteo clay loam, 0 to 2 percent slopes	6.19	10.7%		84	71
341C2	Estherville-Pilot Grove complex, 5 to 9 percent slopes, moderately eroded	5.00	8.7%		34	19
638C2	Clarion-Storden complex, 6 to 10 percent slopes, moderately eroded	4.75	8.2%		75	52
55	Nicollet clay loam, 1 to 3 percent slopes	4.61	8.0%		89	73
1707B	Delft-Terril complex, 1 to 5 percent slopes	3.32	5.7%		78	59
878B	Ocheyedan loam, 2 to 5 percent slopes	3.30	5.7%		92	74
557	Talcot-Biscay complex, 0 to 2 percent slopes	2.60	4.5%		65	50
327B	Wadena-Augusta Lake-Clarion complex, 2 to 5 percent slopes	2.37	4.1%		70	55
390	Waldorf silty clay loam, 0 to 2 percent slopes	1.84	3.2%		69	59
138B	Clarion loam, 2 to 6 percent slopes	1.24	2.1%		89	73
835D2	Omsrud-Storden complex, 10 to 16 percent slopes, moderately eroded	0.98	1.7%		53	35
5040	Udorthents, loamy	0.34	0.6%		5	5
<b>Weighted Average</b>					<b>75</b>	<b>58.7</b>

\*\*IA has updated the CSR values for each county to CSR2.

Soils data provided by USDA and NRCS.