

# Soils Map

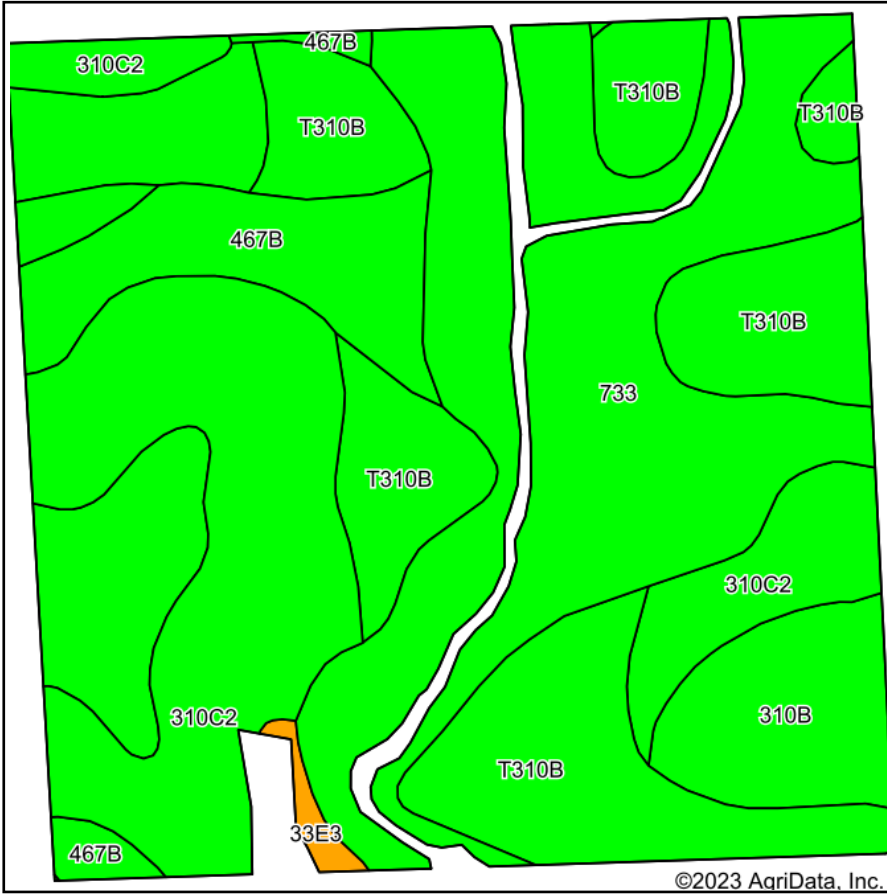

Soils data provided by USDA and NRCS.

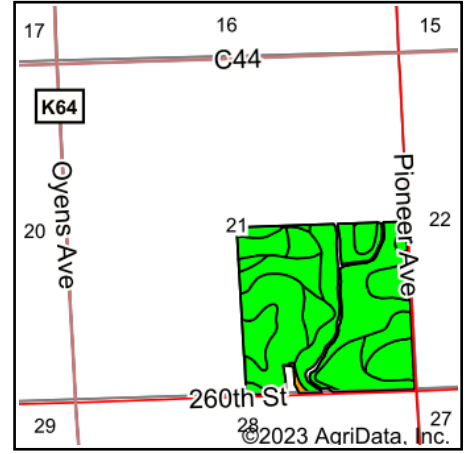

State: **Iowa**  
 County: **Plymouth**  
 Location: **21-91N-44W**  
 Township: **Union**  
 Acres: **153.18**  
 Date: **11/8/2023**

& REAL ESTATE, INC  
**MIDWEST LAND**  
 712-262-3110 MANAGEMENT  
 Maps Provided By:  
  
 CUSTOMIZED ONLINE MAPPING  
 © AgriData, Inc. 2023 www.AgriDataInc.com



Area Symbol: IA149, Soil Area Version: 34

Code	Soil Description	Acres	Percent of field	CSR2 Legend	CSR2**	CSR
733	Calco silty clay loam, 0 to 2 percent slopes, occasionally flooded	45.79	29.9%		78	65
310C2	Galva silty clay loam, 5 to 9 percent slopes, eroded	36.75	24.0%		84	51
T310B	Galva silty clay loam, terrace, 2 to 5 percent slopes	34.86	22.8%		95	69
310B	Galva silty clay loam, 2 to 5 percent slopes	22.98	15.0%		95	68
467B	Radford silty clay loam, 2 to 5 percent slopes	11.93	7.8%		75	72
33E3	Steinauer clay loam, 14 to 18 percent slopes, severely eroded	0.87	0.6%		10	19
<b>Weighted Average</b>					<b>85.2</b>	<b>63.3</b>

\*\*IA has updated the CSR values for each county to CSR2.  
 Soils data provided by USDA and NRCS.