

Tract 3

Soils Map

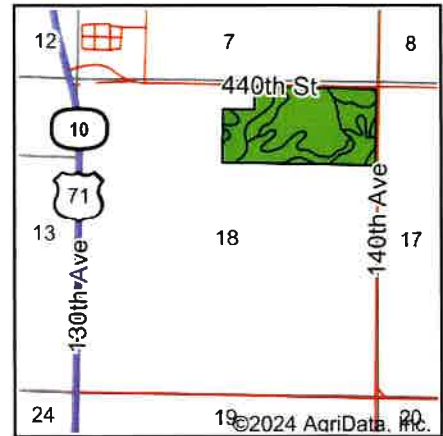
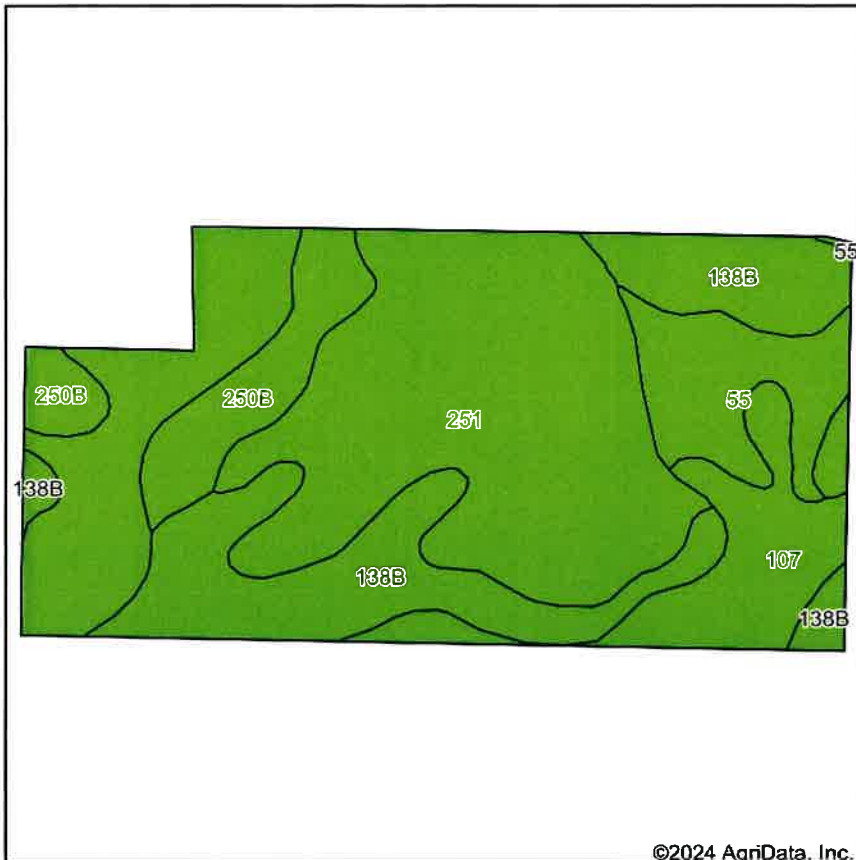

State: **Iowa**  
 County: **Buena Vista**  
 Location: **18-93N-36W**  
 Township: **Lee**  
 Acres: **72.7**  
 Date: **7/18/2024**

**MIDWEST LAND** & REAL ESTATE, INC  
 712-262-3110 MANAGEMENT  
 Maps Provided By:  
  
 © AgriData, Inc. 2023 www.AgriDataInc.com

Soils data provided by USDA and NRCS.

Area Symbol: IA021, Soil Area Version: 29

Code	Soil Description	Acres	Percent of field	CSR2 Legend	CSR2**	CSR
251	Nicollet silty clay loam, 1 to 3 percent slopes	35.96	49.5%		86	84
138B	Clarion loam, 2 to 6 percent slopes	17.02	23.4%		89	76
107	Webster clay loam, 0 to 2 percent slopes	7.20	9.9%		86	79
250B	Clarion silty clay loam, 2 to 5 percent slopes	6.33	8.7%		89	76
55	Nicollet clay loam, 1 to 3 percent slopes	6.19	8.5%		89	84
<b>Weighted Average</b>					<b>87.2</b>	<b>80.9</b>

\*\*IA has updated the CSR values for each county to CSR2.

Tract 4

Soils Map

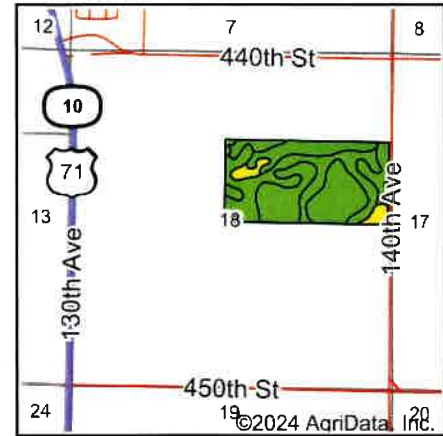
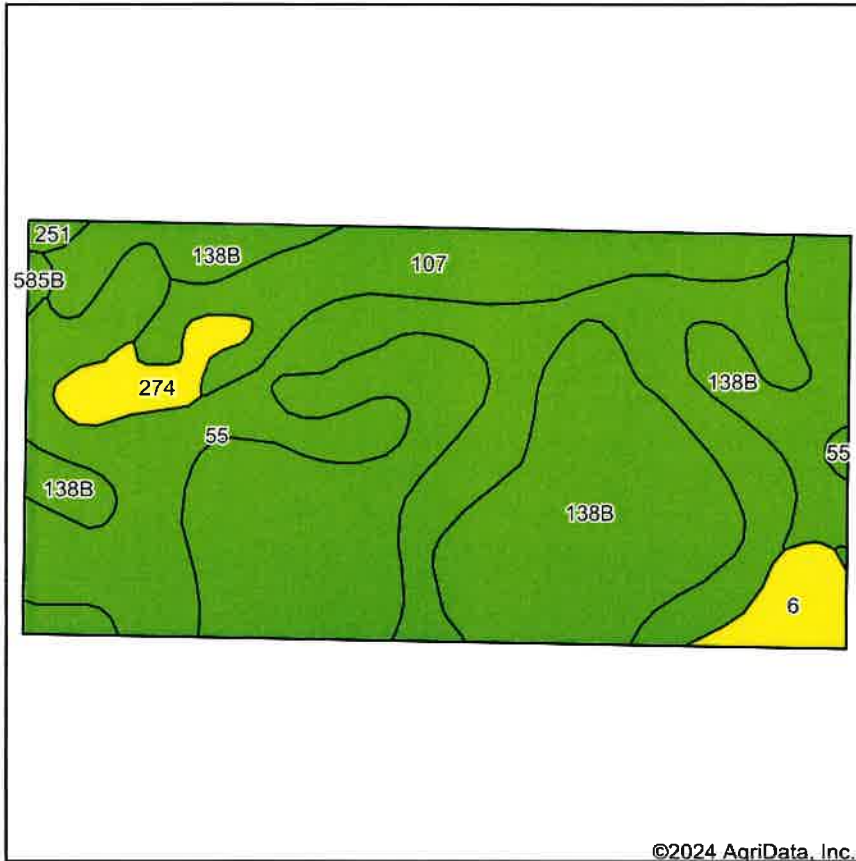







State: Iowa  
 County: Buena Vista  
 Location: 18-93N-36W  
 Township: Lee  
 Acres: 77.5  
 Date: 7/18/2024

& REAL ESTATE, INC  
**MIDWEST LAND**  
 712-262-3110 MANAGEMENT  
 Maps Provided By:  
  
 © AgriData, Inc. 2023 www.AgriDataInc.com

Soils data provided by USDA and NRCS.

Area Symbol: IA021, Soil Area Version: 29

Code	Soil Description	Acres	Percent of field	CSR2 Legend	CSR2**	CSR
138B	Clarion loam, 2 to 6 percent slopes	36.51	47.2%		89	76
55	Nicollet clay loam, 1 to 3 percent slopes	26.54	34.2%		89	84
107	Webster clay loam, 0 to 2 percent slopes	9.33	12.0%		86	79
274	Rolfe silt loam, 0 to 1 percent slopes	2.32	3.0%		57	49
6	Okoboji silty clay loam, 0 to 1 percent slopes	2.22	2.9%		59	54
251	Nicollet silty clay loam, 1 to 3 percent slopes	0.32	0.4%		86	84
585B	Colo-Spillville complex, 2 to 5 percent slopes	0.26	0.3%		79	57
<b>Weighted Average</b>					<b>86.8</b>	<b>77.6</b>

\*\*IA has updated the CSR values for each county to CSR2.

Tract 5

Soils Map

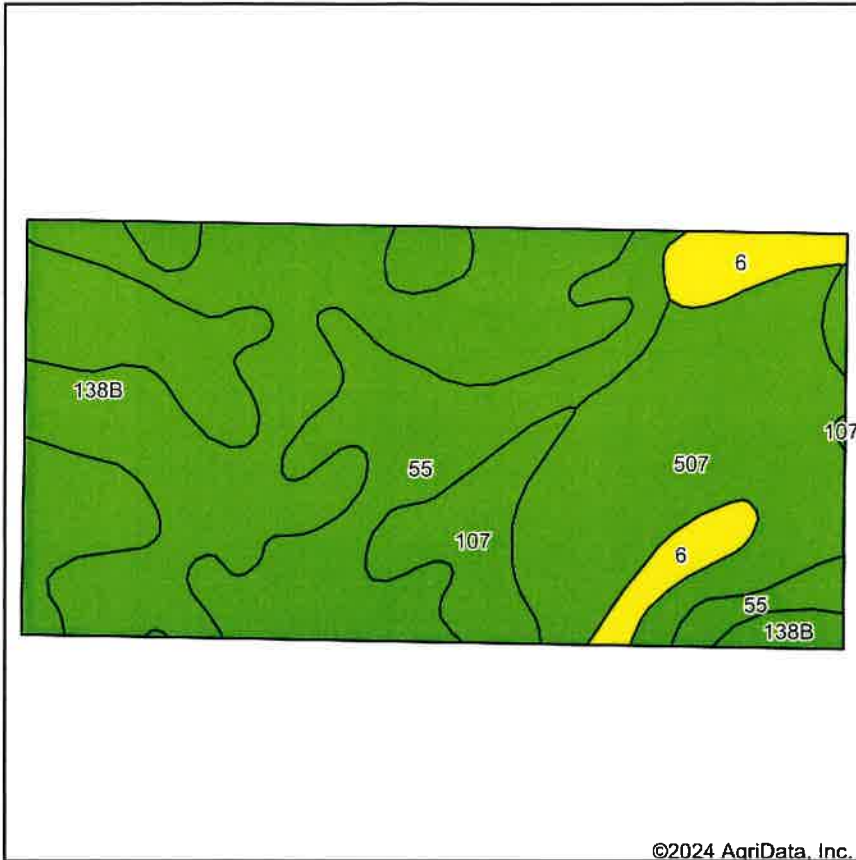

Soils data provided by USDA and NRCS.

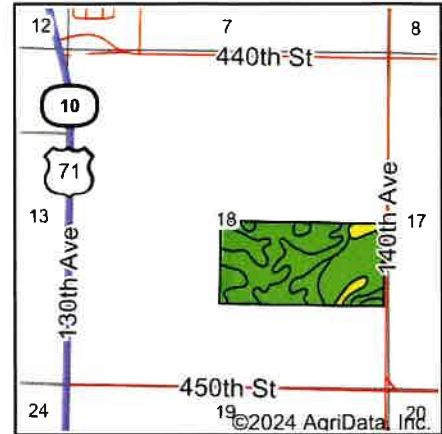

State: **Iowa**  
 County: **Buena Vista**  
 Location: **18-93N-36W**  
 Township: **Lee**  
 Acres: **78**  
 Date: **7/18/2024**

**MIDWEST LAND** & REAL ESTATE, INC.  
 712-262-3110 MANAGEMENT

Maps Provided By:



Area Symbol: IA021, Soil Area Version: 29

Code	Soil Description	Acres	Percent of field	CSR2 Legend	CSR2**	CSR
55	Nicollet clay loam, 1 to 3 percent slopes	26.20	33.6%		89	84
138B	Clarion loam, 2 to 6 percent slopes	24.71	31.7%		89	76
507	Canisteo clay loam, 0 to 2 percent slopes	18.40	23.6%		84	74
107	Webster clay loam, 0 to 2 percent slopes	4.68	6.0%		86	79
6	Okoboji silty clay loam, 0 to 1 percent slopes	4.01	5.1%		59	54
<b>Weighted Average</b>					<b>86.1</b>	<b>77.3</b>

\*\*IA has updated the CSR values for each county to CSR2.

Tract 6

Soils Map

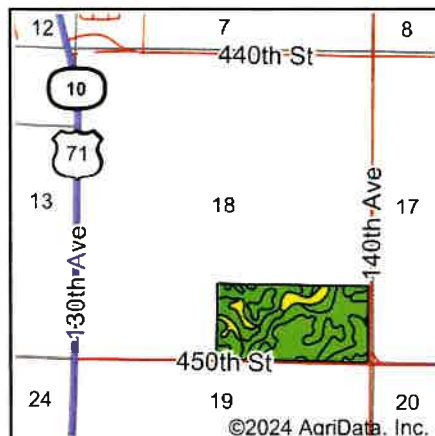
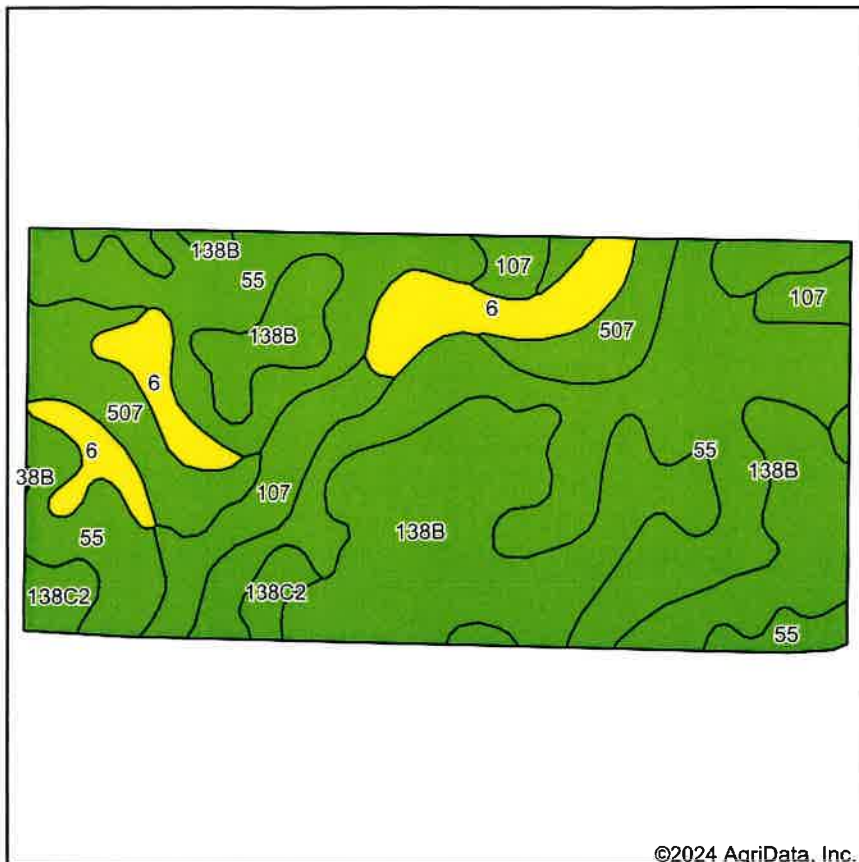

State: **Iowa**  
 County: **Buena Vista**  
 Location: **18-93N-36W**  
 Township: **Lee**  
 Acres: **76.9**  
 Date: **7/18/2024**

**MIDWEST LAND** & REAL ESTATE, INC  
 MANAGEMENT  
 712-262-3110

Maps Provided By:



Soils data provided by USDA and NRCS.

©2024 AgriData, Inc.

Area Symbol: IA021, Soil Area Version: 29

Code	Soil Description	Acres	Percent of field	CSR2 Legend	CSR2**	CSR
55	Nicollet clay loam, 1 to 3 percent slopes	31.10	40.4%		89	84
138B	Clarion loam, 2 to 6 percent slopes	24.03	31.2%		89	76
507	Canisteo clay loam, 0 to 2 percent slopes	7.13	9.3%		84	74
6	Okoboji silty clay loam, 0 to 1 percent slopes	6.82	8.9%		59	54
107	Webster clay loam, 0 to 2 percent slopes	5.76	7.5%		86	79
138C2	Clarion loam, 6 to 10 percent slopes, moderately eroded	2.06	2.7%		83	60
<b>Weighted Average</b>					<b>85.5</b>	<b>76.9</b>

\*\*IA has updated the CSR values for each county to CSR2.