

### Soils Map-CSR2

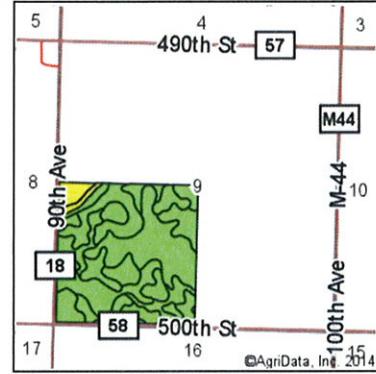

State: Iowa  
 County: Buena Vista  
 Location: 9-92N-37W  
 Township: Scott  
 Acres: 154.9  
 Date: 12/18/2014

**MIDWEST LAND**  
 & REAL ESTATE, INC  
 712-282-3110 MANAGEMENT

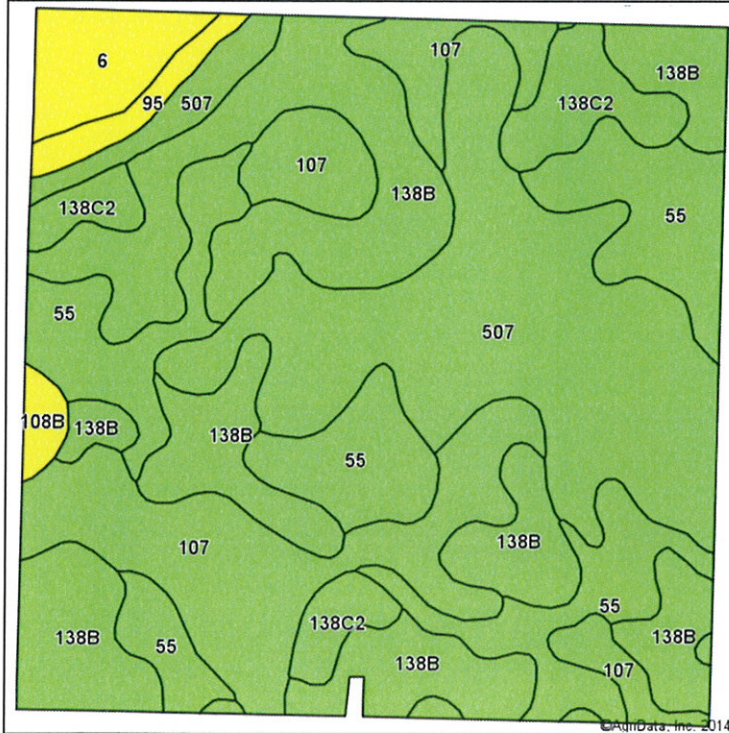

Maps Provided By:  
**surety**  
 CUSTOMIZED ONLINE MAPPING  
 © AgriData, Inc. 2014 www.AgriDataInc.com

Soils data provided by USDA and NRCS.

Area Symbol: IA021, Soil Area Version: 19							
Code	Soil Description	Acres	Percent of field	**CSR2 Legend	Non-Irr Class	CSR2**	CSR
138B	Clarion loam, 2 to 6 percent slopes	45.15	29.1%		Ile	90	76
507	Canisteo silty clay loam, 0 to 2 percent slopes	36.79	23.8%		Ilw	88	74
55	Nicollet clay loam, 1 to 3 percent slopes	30.17	19.5%		I	88	84
107	Webster clay loam, 0 to 2 percent slopes	26.17	16.9%		Ilw	86	79
138C2	Clarion loam, 6 to 10 percent slopes, moderately eroded	8.35	5.4%		IIIe	83	60
6	Okoboji silty clay loam, 0 to 1 percent slopes	4.85	3.1%		IIIw	55	54
95	Harps clay loam, 0 to 2 percent slopes	2.20	1.4%		Ilw	72	59
108B	Wadena loam, moderately deep, 2 to 5 percent slopes	1.22	0.8%		Ile	51	48
<b>Weighted Average</b>						<b>86.4</b>	<b>75.6</b>

\*\*IA has updated the CSR values for each county to CSR2.

Field borders provided by Farm Service Agency as of 5/21/2008. Aerial photography provided by Aerial Photography Field Office.