

Soils Map-CSR2

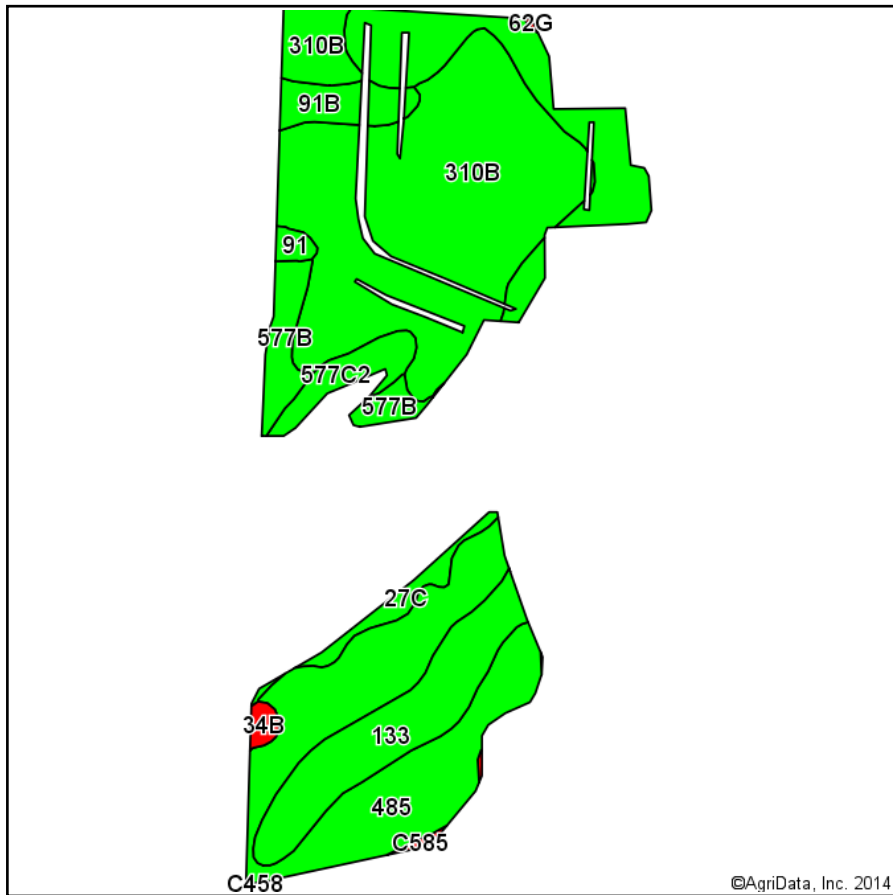

Soils data provided by USDA and NRCS.

©AgriData, Inc. 2014

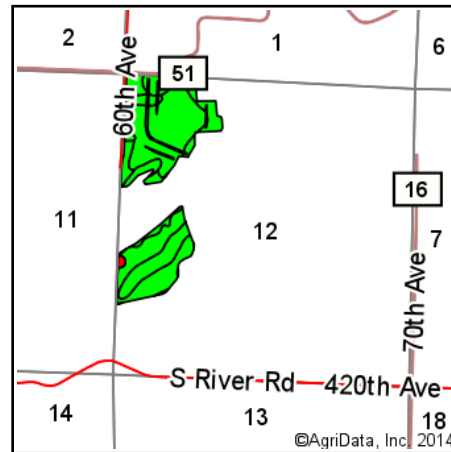

State: **Iowa**
 County: **Buena Vista**
 Location: **12-93N-38W**
 Township: **Brooke**
 Acres: **82.63**
 Date: **10/2/2014**

& REAL ESTATE, INC.
MIDWEST LAND
 712-262-3110 MANAGEMENT

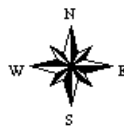

Maps Provided By:

 CUSTOMIZED ONLINE MAPPING
 © AgriData, Inc. 2014 www.AgriDataInc.com

Area Symbol: IA021, Soil Area Version: 18

Code	Soil Description	Acres	Percent of field	**CSR2 Legend	Non-Irr Class	CSR2**	CSR
310B	Galva silty clay loam, 2 to 5 percent slopes	33.72	40.8%		Ile	95	74
485	Spillville loam, 0 to 2 percent slopes	19.44	23.5%		Ilw	90	81
133	Colo silty clay loam, 0 to 2 percent slopes	9.18	11.1%		Ilw	74	76
77B	Sac silty clay loam, loam substratum, 2 to 5 percent slopes	9.18	11.1%		Ile	93	72
577B	Everly clay loam, 2 to 5 percent slopes	3.43	4.2%		Ile	90	69
577C2	Everly clay loam, 5 to 9 percent slopes, moderately eroded	2.38	2.9%		IIIe	82	51
91B	Primghar silty clay loam, 2 to 4 percent slopes	2.34	2.8%		Ile	94	81
27C	Terril loam, 4 to 9 percent slopes	1.66	2.0%		IIIe	84	61
91	Primghar silty clay loam, 0 to 2 percent slopes	0.56	0.7%		I	99	84
34B	Estherville sandy loam, 2 to 5 percent slopes	0.52	0.6%		IIIs	18	14
C585	Colo-Spillville complex, channeled, 0 to 2 percent slopes	0.22	0.3%		Vw	17	25
Weighted Average						89.8	74.3

Area Symbol: IA021, Soil Area Version: 18

**IA has updated the CSR values for each county to CSR2.

Field borders provided by Farm Service Agency as of 5/21/2008. Aerial photography provided by Aerial Photography Field Office.