

Soils Map

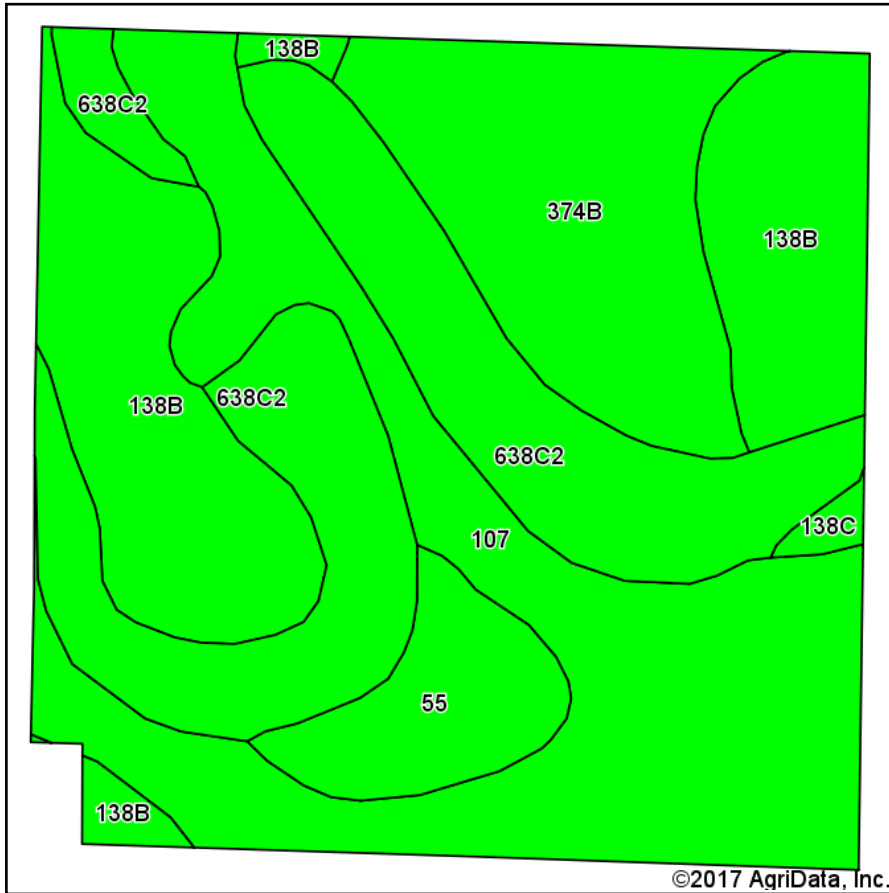

Soils data provided by USDA and NRCS.

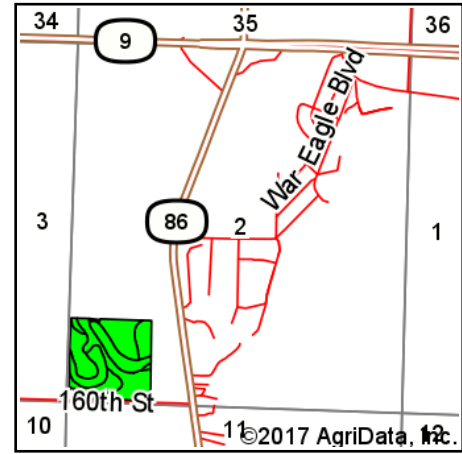

State: **Iowa**
 County: **Dickinson**
 Location: **2-99N-37W**
 Township: **Lakeville**
 Acres: **37.6**
 Date: **8/8/2017**

MIDWEST LAND
 & REAL ESTATE, INC.
 712-262-3110 MANAGEMENT

Maps Provided By:

 CUSTOMIZED ONLINE MAPPING
 © AgriData, Inc. 2017 www.AgriDataInc.com



Area Symbol: IA059, Soil Area Version: 26

Code	Soil Description	Acres	Percent of field	CSR2 Legend	Non-Irr Class *c	CSR2**	CSR
107	Webster clay loam, 0 to 2 percent slopes	10.93	29.1%		IIw	86	70
638C2	Clarion-Storden complex, 6 to 10 percent slopes, moderately eroded	9.66	25.7%		IIIe	75	52
138B	Clarion loam, 2 to 6 percent slopes	8.57	22.8%		Ile	89	73
374B	Okabena silty clay loam, 1 to 5 percent slopes	6.02	16.0%		Iw	91	73
55	Nicollet clay loam, 1 to 3 percent slopes	2.21	5.9%		Iw	89	73
138C	Clarion loam, 6 to 10 percent slopes	0.21	0.6%		IIIe	84	67
Weighted Average						84.8	66.7

**IA has updated the CSR values for each county to CSR2.

*c: Using Capabilities Class Dominant Condition Aggregation Method

Soils data provided by USDA and NRCS.