

Soils Map-CSR2

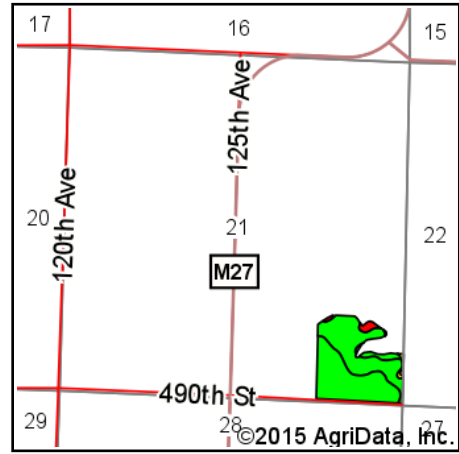

State: **Iowa**
 County: **Clay**
 Location: **21-94N-38W**
 Township: **Peterson**
 Acres: **32.68**
 Date: **4/13/2015**

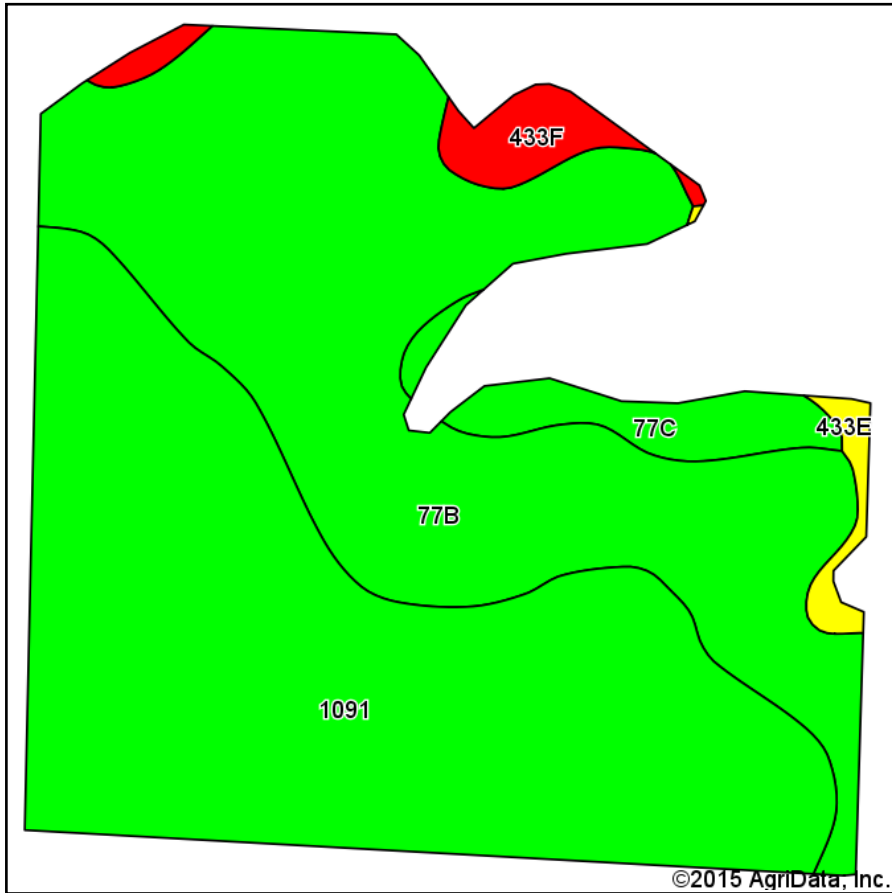

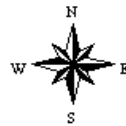

& REAL ESTATE, INC
MIDWEST LAND
 712-262-3110 MANAGEMENT



Maps Provided By:

 CUSTOMIZED ONLINE MAPPING
 © AgriData, Inc. 2014 www.AgriDataInc.com

Area Symbol: IA041, Soil Area Version: 22

Code	Soil Description	Acres	Percent of field	**CSR2 Legend	Non-Irr Class	CSR2**	CSR
1091	McCreath silty clay loam, 0 to 2 percent slopes	15.87	48.6%		I	98	83
77B	Sac silty clay loam, 2 to 5 percent slopes	14.28	43.7%		Ile	95	71
77C	Sac silty clay loam, 5 to 9 percent slopes	1.26	3.9%		IIle	90	55
433F	Moneta loam, 18 to 25 percent slopes	0.91	2.8%		VIe	30	5
433E	Moneta loam, 14 to 18 percent slopes	0.36	1.1%		IVe	43	25
Weighted Average						93.9	73.9

Area Symbol: IA041, Soil Area Version: 22

**IA has updated the CSR values for each county to CSR2.

Soils data provided by USDA and NRCS.