

Aerial Map



MIDWEST LAND
712-262-3110 MANAGEMENT

18-98N-35W
Dickinson County
Iowa

map center: 43° 18' 21.13, 95° 1' 22.84
scale: 8685

Maps provided by:



©AgriData, Inc. 2012
www.AgriDataInc.com



6/13/2012

Field borders provided by Farm Service Agency as of 5/21/2008. Aerial photography provided by Aerial Photography Field Office.

Soils Map

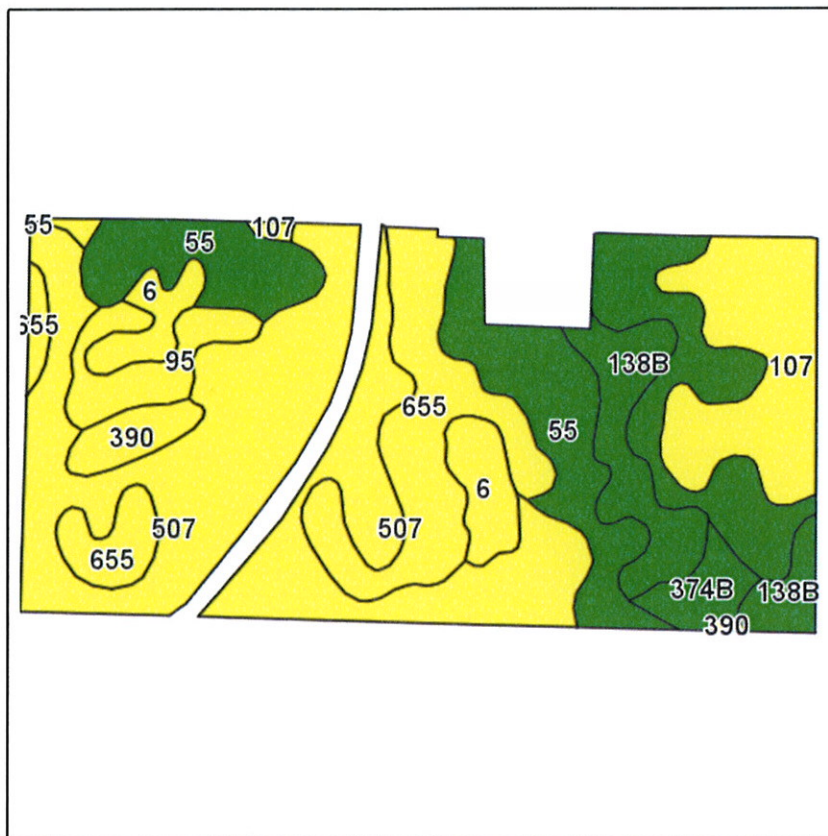

Field borders provided by Farm Service Agency as of 5/21/2008.
Soils data provided by USDA and NRCS.

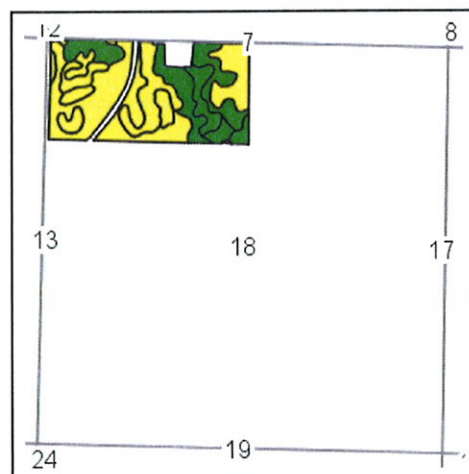

State: **Iowa**
County: **Dickinson**
Location: **18-98N-35W**
Township: **Lloyd**
Acres: **72.5**
Date: **6/13/2012**

& REAL ESTATE, INC.
MIDWEST LAND
712-262-3110 MANAGEMENT



Maps provided by:



©AgriData, Inc 2012
www.AgriDataInc.com

| Code | Soil Description | Acres | Percent of field | CSR Legend | Non-Irr Class | CSR | Corn | Soybeans |
|------------------|---|-------|------------------|------------|---------------|------|-------|----------|
| 507 | Canisteo silty clay loam, 0 to 2 percent slopes | 23.7 | 32.7% | | IIw | 71 | 180 | 58 |
| 55 | Nicollet loam, 1 to 3 percent slopes | 16.6 | 22.9% | | I | 73 | 183 | 59 |
| 655 | Crippin loam, 1 to 3 percent slopes | 10 | 13.8% | | I | 71 | 181 | 58 |
| 107 | Webster silty clay loam, 0 to 2 percent slopes | 7.8 | 10.7% | | IIw | 70 | 179 | 57 |
| 138B | Clarion loam, 2 to 5 percent slopes | 5.2 | 7.2% | | Ile | 73 | 183 | 59 |
| 6 | Okoboji silty clay loam, 0 to 1 percent slopes | 3.3 | 4.6% | | IIIw | 43 | 143 | 46 |
| 95 | Harps loam, 0 to 2 percent slopes | 2.8 | 3.8% | | IIw | 57 | 162 | 52 |
| 390 | Waldorf silty clay loam, 0 to 2 percent slopes | 1.6 | 2.1% | | IIw | 59 | 164 | 52 |
| 374B | Okabena silty clay loam, 1 to 5 percent slopes | 1.5 | 2.1% | | I | 73 | 184 | 59 |
| Weighted Average | | | | | | 69.4 | 178.1 | 57.3 |