

Soils Map-CSR(as of 1/21/12)

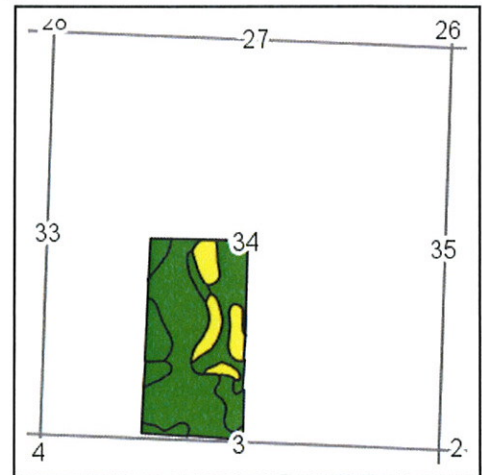
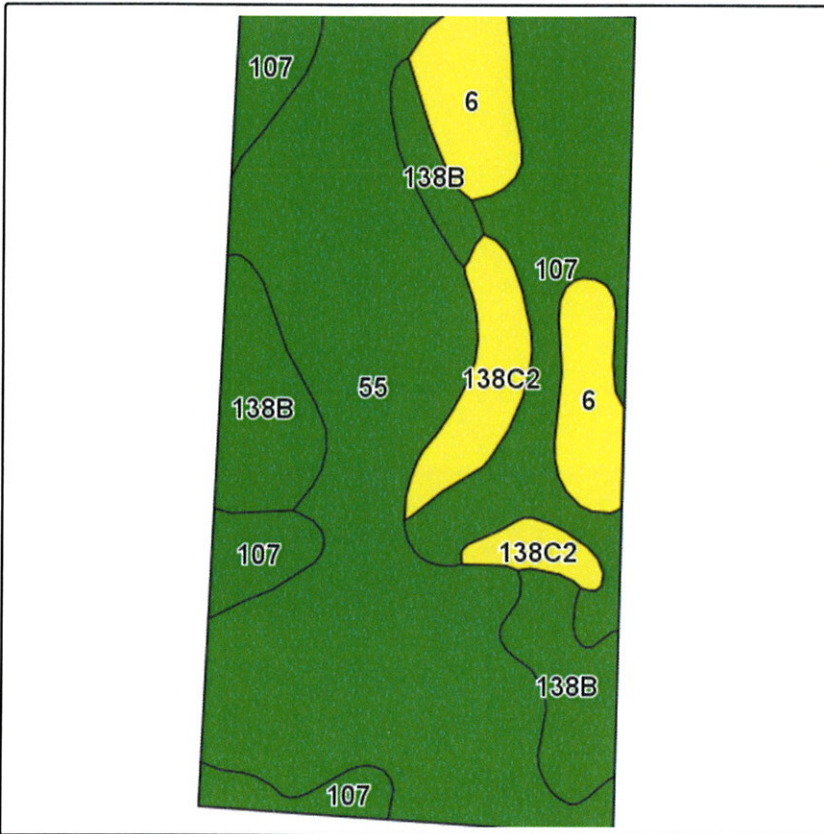

State: **Iowa**
 County: **Palo Alto**
 Location: **34-94N-34W**
 Township: **Booth**
 Acres: **76.2**
 Date: **2/27/2013**

MIDWEST LAND
 & REAL ESTATE, INC
 712-262-3110 MANAGEMENT

Field borders provided by Farm Service Agency as of 5/21/2008.
 Soils data provided by USDA and NRCS.



Maps provided by:



Code	Soil Description	Acres	Percent of field	CSR Legend	Non-Irr Class	CSR*	Corn	Soybeans
55	Nicollet loam, 1 to 3 percent slopes	36.1	47.4%		I	84	200	47
107	Webster silty clay loam, 0 to 2 percent slopes	18.6	24.4%		IIw	79	194	43
138B	Clarion loam, 2 to 5 percent slopes	9.9	13.0%		Ile	76	190	43
6	Okoboji silty clay loam, 0 to 1 percent slopes	6.8	8.9%		IIIw	54	160	34
138C2	Clarion loam, 5 to 9 percent slopes, moderately eroded	4.8	6.3%		IIIe	58	165	40
Weighted Average						77.4	191.5	43.9

Note: ALL soils information on this page is dated 1/21/2012
 *CSR ratings will be available for a limited time to aid in the transition to CSR2.