

Soils Map

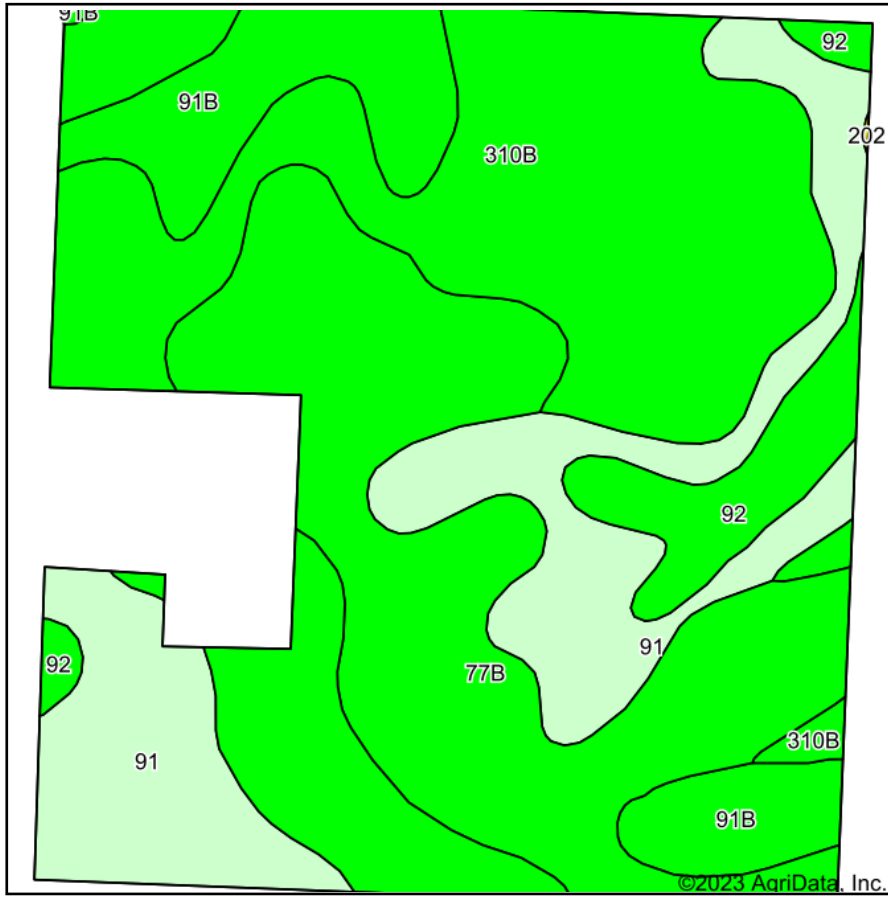

Soils data provided by USDA and NRCS.

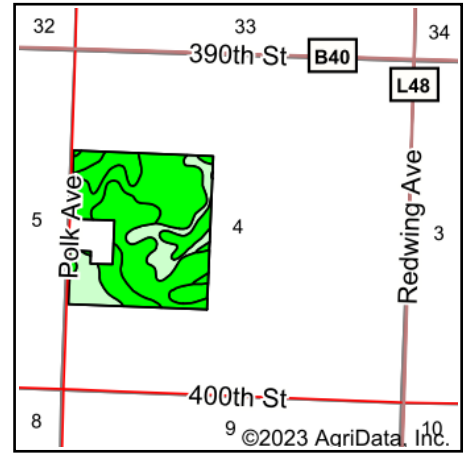

State: **Iowa**
 County: **O'Brien**
 Location: **4-95N-41W**
 Township: **Dale**
 Acres: **110.24**
 Date: **12/28/2023**

& REAL ESTATE, INC
MIDWEST LAND
 712-262-3110 MANAGEMENT
 Maps Provided By:

 CUSTOMIZED ONLINE MAPPING
 © AgriData, Inc. 2023 www.AgriDataInc.com



Area Symbol: IA141, Soil Area Version: 28

Code	Soil Description	Acres	Percent of field	CSR2 Legend	CSR2**	CSR
310B	Galva silty clay loam, 2 to 5 percent slopes	40.27	36.5%		95	70
77B	Sac silty clay loam, loam substratum, 2 to 5 percent slopes	30.14	27.3%		95	68
91	Primghar silty clay loam, 0 to 2 percent slopes	22.73	20.6%		100	80
91B	Primghar silty clay loam, 2 to 5 percent slopes	11.22	10.2%		95	78
92	Marcus silty clay loam, 0 to 2 percent slopes	5.88	5.3%		94	75
Weighted Average					96	72.6

**IA has updated the CSR values for each county to CSR2.
 Soils data provided by USDA and NRCS.